

**ATTACCHI E MANDRINI  
CHUCKS AND CLAMPING SYSTEMS  
SPANNSYSTEME  
ATTAQUES ET MANDRINS  
ПАТРОНЫ И ОПРАВКИ**



**6**

CHUCKS AND CLAMPING SYSTEM



**M010**  
p. 449



**M012**  
p. 449



**M014**  
p. 450



**M016**  
p. 450



**M030**  
p. 450



**M032**  
p. 451



**M034**  
p. 452



**M040A**  
p. 452



**M040B**  
p. 453



**M040C**  
p. 453



**M040D**  
p. 454



**M040E**  
p. 454



**M040F**  
p. 455



**M040H**  
p. 455



**M040G**  
p. 456



**M040I**  
p. 456



**M040L**  
p. 457



**M040M**  
p. 457



**M040N**  
p. 458



**M040P**  
p. 458



**M041**  
p. 459



**M231**  
p. 460



**M233**  
p. 461



**M234**  
p. 462



**M235**  
p. 463



**M236**  
p. 464



**M238**  
p. 465



**M700**  
p. 466



**M701**  
p. 466



**M702**  
p. 467



CHUCKS AND CLAMPING SYSTEM

|  |  |  |  |  |
|--|--|--|--|--|
| <br><b>M703</b><br>p. 467   | <br><b>M705</b><br>p. 468   | <br><b>M707</b><br>p. 468   | <br><b>M709</b><br>p. 469   | <br><b>M720</b><br>p. 469   |
| <br><b>M722</b><br>p. 470   | <br><b>M937</b><br>p. 470   | <br><b>M938</b><br>p. 471   | <br><b>M939</b><br>p. 471   | <br><b>M726</b><br>p. 472   |
| <br><b>M788</b><br>p. 473  | <br><b>M790</b><br>p. 473  | <br><b>M911</b><br>p. 474  | <br><b>M960</b><br>p. 474   | <br><b>M910</b><br>p. 475  |
| <br><b>M915</b><br>p. 476 | <br><b>M730</b><br>p. 477 | <br><b>M735</b><br>p. 477 | <br><b>M740</b><br>p. 478  | <br><b>M750</b><br>p. 479 |
| <br><b>M751</b><br>p. 479 | <br><b>M752</b><br>p. 480 | <br><b>M755</b><br>p. 480 | <br><b>M757</b><br>p. 481 | <br><b>M759</b><br>p. 481 |
| <br><b>M760</b><br>p. 482 | <br><b>M762</b><br>p. 482 | <br><b>M765</b><br>p. 483 | <br><b>M768</b><br>p. 484 | <br><b>M774</b><br>p. 484 |



CHUCKS AND CLAMPING SYSTEM

|   |   |   |  |   |
|---|---|---|--|---|
|  <p><b>M784</b><br/>p. 485</p>   |  <p><b>M786</b><br/>p. 485</p>   |  <p><b>M800</b><br/>p. 486-487</p> |  <p><b>MTS10</b><br/>p. 488</p>  |  <p><b>MTS40</b><br/>p. 489</p>  |
|  <p><b>B020</b><br/>p. 490</p>   |  <p><b>B030</b><br/>p. 491</p>   |  <p><b>B040</b><br/>p. 492</p>     |  <p><b>B050</b><br/>p. 493</p>   |  <p><b>B060</b><br/>p. 493</p>   |
|  <p><b>B1AC</b><br/>p. 494</p>  |  <p><b>B1BC</b><br/>p. 495</p>  |  <p><b>B1CC</b><br/>p. 496</p>    |  <p><b>B2CC</b><br/>p. 497</p>  |  <p><b>B3CC</b><br/>p. 497</p>  |
|  <p><b>BRSH</b><br/>p. 498</p> |  <p><b>BRSN</b><br/>p. 499</p> |  <p><b>BRST</b><br/>p. 500</p>   |  <p><b>BSYS</b><br/>p. 500</p> |  <p><b>BZYS</b><br/>p. 501</p> |
|  <p><b>BRSZ</b><br/>p. 501</p> |   |   |  |   |
|   |   |   |  |   |



## M010 Interchangeable drill-chucks



Ottenuti da acciaio di elevata resistenza meccanica • Da usare con art. P160

Obtained from steel with a high mechanical resistance • It can be used with item nr. P160

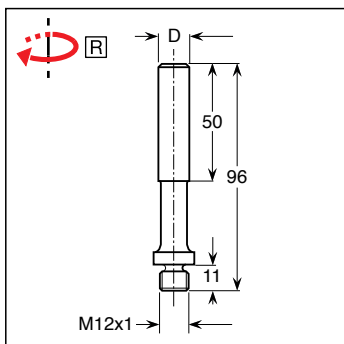

● = Ready in stock ■ = Delivery time 20 working days △ = On request

| D     | Left Code      | Right Code     | €     |
|-------|----------------|----------------|-------|
| 13    | ● M010013AAAAL | ● M010013AAAAR | 15,20 |
| Spec. | M010099L       | M010099R       |       |

**NOTE**

■ Utensili non a magazzino, quantità minima d'ordine: **10 pezzi.**  
Tools not ready in stock minimum order quantity: **10 pieces.**

TAGLIO / SEZIONATURA  
SAWING

DIAMANTE  
DIAMOND

FRESATURA  
CUTTING

PANTOGRAFATURA  
ROUTING

## M012 Interchangeable drill-chucks



Ottenuti da acciaio di elevata resistenza meccanica • Da usare con art. P160

Obtained from steel with a high mechanical resistance • It can be used with item nr. P160

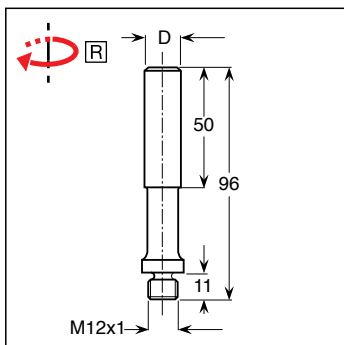

● = Ready in stock ■ = Delivery time 20 working days △ = On request

| D     | Left Code      | Right Code     | €     |
|-------|----------------|----------------|-------|
| 16    | ● M012016AAAAL | ● M012016AAAAR | 15,20 |
| Spec. | M012099L       | M012099R       |       |

**NOTE**

■ Utensili non a magazzino, quantità minima d'ordine: **10 pezzi.**  
Tools not ready in stock minimum order quantity: **10 pieces.**

FORATURA  
BORING

MANDRINI / ATTACCHI  
CHUCKS & CLAMPING SYSTEM

RICAMBI E LAVORAZIONI SUPP.  
SPARE PARTS & ADD. WORKING

Mandri per punte intercambiabili

Aufnahmedorn

Mandrins de montage

Патроны для сменных сверел

## M014

## Interchangeable drill-chucks



Ottenuti da acciaio di elevata resistenza meccanica • Da usare con art. P160

Obtained from steel with a high mechanical resistance • It can be used with item nr. P160

● = Ready in stock ■ = Delivery time 20 working days △ = On request

| D     | Code           | €     |
|-------|----------------|-------|
| 8     | ● M0140080AAAA | 11,40 |
| 9,5   | ● M0140095AAAA | 11,40 |
| 12    | ● M0140120AAAA | 11,40 |
| Spec. | M014099        |       |

### NOTE

■ Utensili non a magazzino, quantità minima d'ordine: **10 pezzi.**  
Tools not ready in stock minimum order quantity: **10 pieces.**

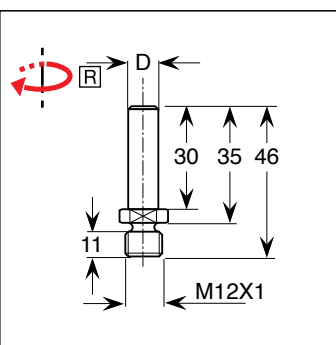

Mandri per punte intercambiabili

Aufnahmedorn

Mandrins de montage

Патроны для сменных сверел

## M016

## Interchangeable drill-chucks



Ottenuti da acciaio di elevata resistenza meccanica • Da usare con art. P160

Obtained from steel with a high mechanical resistance • It can be used with item nr. P160

● = Ready in stock ■ = Delivery time 20 working days △ = On request

| D     | Code           | €     |
|-------|----------------|-------|
| 10    | ● M0160100AAAA | 13,40 |
| Spec. | M016099        |       |

### NOTE

■ Utensili non a magazzino, quantità minima d'ordine: **10 pezzi.**  
Tools not ready in stock minimum order quantity: **10 pieces.**

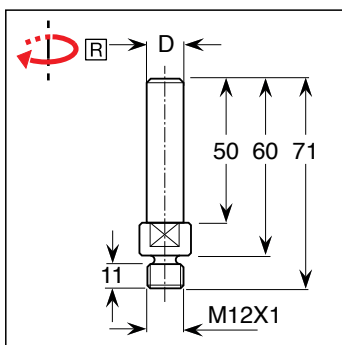

TAGLIO / SEZIONATURA  
SAWING

DIAMANTE  
DIAMOND

FRESATURA  
CUTTING

PANTOGRAFATURA  
ROUTING

FORATURA  
BORING

MANDRINI / ATTACCHI  
CHUCKS & CLAMPING SYSTEM

RICAMBI E LAVORAZIONI SUPP.  
SPARE PARTS & ADD. WORKING

Mandri per punte intercambiabili

Reduzierfutter

Mandrins de montage

Патроны для сменных сверел

## M030

## Interchangeable drill-chucks



Ottenuti da acciaio di elevata resistenza meccanica • Da usare con art. P160

Obtained from steel with a high mechanical resistance • It can be used with item nr. P160

● = Ready in stock ■ = Delivery time 20 working days △ = On request

| L     | LT | Left Code      | Right Code     | €     |
|-------|----|----------------|----------------|-------|
| 15    | 42 | ● M03001542AAL | ● M03001542AAR | 15,20 |
| 25    | 52 | ● M03002552AAL | ● M03002552AAR | 15,20 |
| 35    | 62 | ● M03003035AAL | ● M03003035AAR | 15,20 |
| Spec. |    | M030099L       | M030099R       |       |

### NOTE

■ Utensili non a magazzino, quantità minima d'ordine: **10 pezzi.**  
Tools not ready in stock minimum order quantity: **10 pieces.**

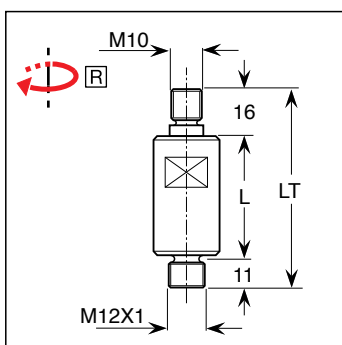

Mandri per punte intercambiabili

Reduzierfutter

Mandrins de montage

Патроны для сменных сверел

## M032

## Interchangeable drill-chucks



Ottenuti da acciaio di elevata resistenza meccanica • Da usare con art. P160 • Parti in accoppiamento interamente rettificata in totale rispetto delle norme UNI ed ISO

Obtained from steel with a high mechanical resistance • It can be used with item nr. P160 • Parts in connection completely ground in observance of the UNI and ISO rules

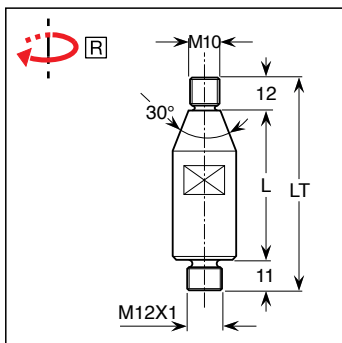

| L     | LT | Left Code      | Right Code     | €     |
|-------|----|----------------|----------------|-------|
| 25    | 48 | ● M03202548AAL | ● M03202548AAR | 15,20 |
| 35    | 58 | ● M03203558AAL | ● M03203558AAR | 15,20 |
| 45    | 68 | ● M03204568AAL | ● M03204568AAR | 15,20 |
| Spec. |    | M032099L       | M032099R       |       |

### NOTE

■ Utensili non a magazzino, quantità minima d'ordine: **10 pezzi.**  
Tools not ready in stock minimum order quantity: **10 pieces.**



Mandri per punte intercambiabili

Reduzierfutter

Mandrins de montage

Патроны для сменных сверел

## M034

## Interchangeable drill-chucks



Ottenuti da acciaio di elevata resistenza meccanica • Da usare con art. P160 • Parti in accoppiamento interamente rettificata in totale rispetto delle norme UNI ed ISO

Obtained from steel with a high mechanical resistance • It can be used with item nr. P160 • Parts in connection completely ground in observance of the UNI and ISO rules

● = Ready in stock ■ = Delivery time 20 working days △ = On request

| L     | Left Code      | Right Code     | €     |
|-------|----------------|----------------|-------|
| 27    | ● M034027AAAAL | ● M034027AAAAR | 13,40 |
| Spec. | M034099L       | M034099R       |       |

### NOTE

■ Utensili non a magazzino, quantità minima d'ordine: **10 pezzi**.  
Tools not ready in stock minimum order quantity: **10 pieces**.

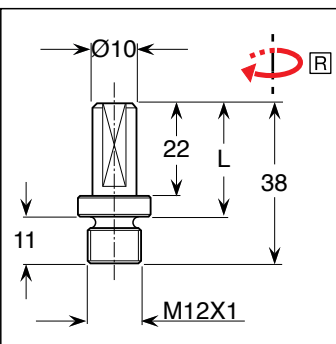

Mandri per punte componibili

Bohrspannfutter

Mandrins de montage

Патроны для сверел

## M040A

## Reducing chucks



Ottenuti da acciaio di elevata resistenza meccanica • Da montare su macchine foratrici: ALBERTI - BALESTRINI - BIESSE - BUSELLATO - GESSNER - MORBIDELLI - TORWEGGE - VITAP - WEEKE • Parti in accoppiamento interamente rettificata in totale rispetto delle norme UNI ed ISO

Obtained from steel with a high mechanical resistance • Use on the following drilling machines: ALBERTI - BALESTRINI - BIESSE - BUSELLATO - GESSNER - MORBIDELLI - TORWEGGE - VITAP - WEEKE • Parts in connection completely ground in observance of the UNI and ISO rules

● = Ready in stock ■ = Delivery time 20 working days △ = On request

| F     | D  | Left Code      | Right Code     | €     |
|-------|----|----------------|----------------|-------|
| 8     | 16 | ● M040008AAAAL | ● M040008AAAAR | 12,60 |
| 10    | 19 | ● M040010AAAAL | ● M040010AAAAR | 10,60 |
| Spec. |    | M040A99        | M040A99        |       |

### SPARE PARTS

| Type        | Dimensions | Code         | €    |
|-------------|------------|--------------|------|
| Screw       | M6X6       | ● WVGR6      | 0,40 |
| T allen wr. | 3          | ACH003AAAAAA | 5,80 |

### NOTE

■ Utensili non a magazzino, quantità minima d'ordine: **10 pezzi**.  
Tools not ready in stock minimum order quantity: **10 pieces**.

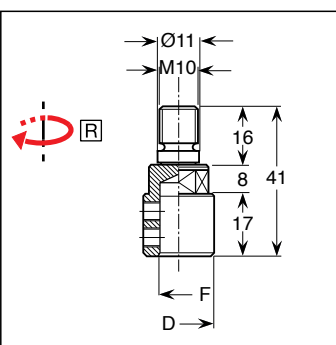

TAGLIO / SEZIONATURA  
SAWING

DIAMANTE  
DIAMOND

FRESATURA  
CUTTING

PANTOGRAFATURA  
ROUTING

FORATURA  
BORING

MANDRINI / ATTACCHI  
CHUCKS & CLAMPING SYSTEM

RICAMBI E LAVORAZIONI SUPP.  
SPARE PARTS & ADD. WORKING



Mandri per punte componibili

Bohrspannfutter

Partie embout fileté

Патроны для сверел



## M040B Reducing chucks



Ottenuti da acciaio di elevata resistenza meccanica • Da montare su macchine foratrici: ALBERTI - BALESTRINI - BILEK - BUSELLATO - OMPEC - REIMALL - SCHLICHER - SCM - TANZANI - VICIANI - VITAP - WEINGÄRTER • Parti in accoppiamento interamente rettificate in totale rispetto delle norme UNI ed ISO

Obtained from steel with a high mechanical resistance • Use on the following drilling machines: ALBERTI - BALESTRINI - BILEK - BUSELLATO - OMPEC - REIMALL - SCHLICHER - SCM - TANZANI - VICIANI - VITAP - WEINGÄRTER • Parts in connection completely ground in observance of the UNI and ISO rules

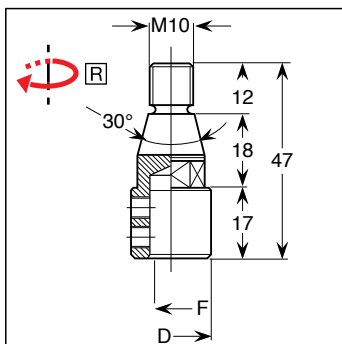

● = Ready in stock ■ = Delivery time 20 working days △ = On request

| F     | D  | Left Code      | Right Code     | €     |
|-------|----|----------------|----------------|-------|
| 8     | 16 | ● M040008BAAAL | ● M040008BAAAR | 12,80 |
| 10    | 19 | ● M040010BAAAL | ● M040010BAAAR | 10,60 |
| Spec. |    | M040B99        | M040B99        |       |

SPARE PARTS

| Type        | Dimensions | Code           | €    |
|-------------|------------|----------------|------|
| Screw       | M6X6       | ● WVGR6        | 0,40 |
| T allen wr. | 3          | ● ACH003AAAAAA | 5,80 |

TAGLIO / SEZIONATURA  
SAWING

DIAMANTE  
DIAMOND

FRESATURA  
CUTTING

Mandri per punte componibili

Bohrspannfutter

Partie embout fileté

Патроны для сверел

PANTOGRAFATURA  
ROUTING

## M040C Reducing chucks



Ottenuti da acciaio di elevata resistenza meccanica • Da montare su macchine foratrici: AYEN - HOLZMA - KNOEVE-NAGEL - MAYER - TORWEGGE • Parti in accoppiamento interamente rettificate in totale rispetto delle norme UNI ed ISO

Obtained from steel with a high mechanical resistance • Use on the following drilling machines: AYEN - HOLZMA - KNOEVENAGEL - MAYER - TORWEGGE • Parts in connection completely ground in observance of the UNI and ISO rules

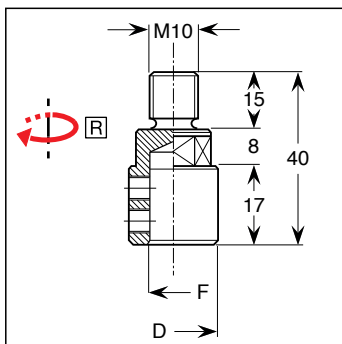

● = Ready in stock ■ = Delivery time 20 working days △ = On request

| F     | D  | Left Code      | Right Code      | €     |
|-------|----|----------------|-----------------|-------|
| 8     | 16 | ● M040008CAAAL | ● M040008CAAAAR | 12,80 |
| 10    | 19 | ● M040010CAAAL | ● M040010CAAAAR | 10,60 |
| Spec. |    | M040C99        | M040C99         |       |

SPARE PARTS

| Type        | Dimensions | Code           | €    |
|-------------|------------|----------------|------|
| Screw       | M6X6       | ● WVGR6        | 0,40 |
| T allen wr. | 3          | ● ACH003AAAAAA | 5,80 |

NOTE

■ Utensili non a magazzino, quantità minima d'ordine: **10 pezzi**.  
Tools not ready in stock minimum order quantity: **10 pieces**.

MANDRINI / ATTACCHI  
CHUCKS & CLAMPING SYSTEM

RICAMBI E LAVORAZIONI SUPP.  
SPARE PARTS & ADD. WORKING

Mandri per punte componibili

Bohrspannfutter

Partie embout fileté

Патроны для сверел

## M040D

## Reducing chucks



Ottenuti da acciaio di elevata resistenza meccanica • Da montare su macchine foratrici: **NOTTMEYER** • Parti in accoppiamento interamente rettificata in totale rispetto delle norme UNI ed ISO

Obtained from steel with a high mechanical resistance • Use on the following drilling machines: **NOTTMEYER** • Parts in connection completely ground in observance of the UNI and ISO rules

● = Ready in stock ■ = Delivery time 20 working days △ = On request

| F     | D    | Left Code      | Right Code     | €     |
|-------|------|----------------|----------------|-------|
| 8     | 15,5 | ● M040008DAAAL | ● M040008DAAAR | 12,80 |
| 10    | 19   | ● M040010DAAAL | ● M040010DAAAR | 10,60 |
| Spec. |      | M040D99        | M040D99        |       |

### SPARE PARTS

| Type        | Dimensions | Code           | €    |
|-------------|------------|----------------|------|
| Screw       | M6X6       | ● WVGR6        | 0,40 |
| T allen wr. | 3          | ● ACH003AAAAAA | 5,80 |

**NOTE** ■ Utensili non a magazzino, quantità minima d'ordine: **10 pezzi**.  
Tools not ready in stock minimum order quantity: **10 pieces**.

Mandri per punte componibili

Bohrspannfutter

Partie embout fileté

Патроны для сверел

## M040E

## Reducing chucks



Ottenuti da acciaio di elevata resistenza meccanica • Da montare su macchine foratrici: **BILEK – KNOEVENAGEL** • Parti in accoppiamento interamente rettificata in totale rispetto delle norme UNI ed ISO

Obtained from steel with a high mechanical resistance • Use on the following drilling machines: **BILEK - KNOEVENAGEL** • Parts in connection completely ground in observance of the UNI and ISO rules

● = Ready in stock ■ = Delivery time 20 working days △ = On request

| F     | D    | Left Code      | Right Code     | €     |
|-------|------|----------------|----------------|-------|
| 8     | 15,5 | ● M040008EAAAL | ● M040008EAAAR | 13,80 |
| 10    | 19   | ● M040010EAAAL | ● M040010EAAAR | 11,40 |
| Spec. |      | M040E99        | M040E99        |       |

### SPARE PARTS

| Type        | Dimensions | Code           | €    |
|-------------|------------|----------------|------|
| Screw       | M6X6       | ● WVGR6        | 0,40 |
| T allen wr. | 3          | ● ACH003AAAAAA | 5,80 |

**NOTE** ■ Utensili non a magazzino, quantità minima d'ordine: **10 pezzi**.  
Tools not ready in stock minimum order quantity: **10 pieces**.

TAGLIO / SEZIONATURA  
SAWING

DIAMANTE  
DIAMOND

FRESATURA  
CUTTING

PANTOGRAFATURA  
ROUTING

FORATURA  
BORING

MANDRINI / ATTACCHI  
CHUCKS & CLAMPING SYSTEM

RICAMBI E LAVORAZIONI SUPP.  
SPARE PARTS & ADD. WORKING

Mandri per punte componibili

Bohrspannfutter

Partie embout fileté

Патроны для сверел



## M040F

## Reducing chucks



Ottenuti da acciaio di elevata resistenza meccanica • Da montare su macchine foratrici: MORBIDELLI - NOTTMEYER - ZANGHERI - BOSCHETTI • Parti in accoppiamento interamente rettificate in totale rispetto delle norme UNI ed ISO

Obtained from steel with a high mechanical resistance • Use on the following drilling machines: MORBIDELLI - NOTTMEYER - ZANGHERI - BOSCHETTI • Parts in connection completely ground in observance of the UNI and ISO rules

● = Ready in stock ■ = Delivery time 20 working days △ = On request

| F     | D    | Left Code      | Right Code     | €     |
|-------|------|----------------|----------------|-------|
| 8     | 15,5 | ● M040008FAAAL | ● M040008FAAAR | 13,20 |
| 10    | 19   | ● M040010FAAAL | ● M040010FAAAR | 11,00 |
| Spec. |      | M040F99        | M040F99        |       |

### SPARE PARTS

| Type        | Dimensions | Code           | €    |
|-------------|------------|----------------|------|
| Screw       | M6X6       | ● WVGR6        | 0,40 |
| T allen wr. | 3          | ● ACH003AAAAAA | 5,80 |

**NOTE** ■ Utensili non a magazzino, quantità minima d'ordine: **10 pezzi**.  
Tools not ready in stock minimum order quantity: **10 pieces**.

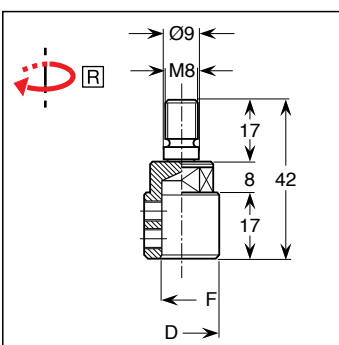

TAGLIO / SEZIONATURA  
SAWING

DIAMANTE  
DIAMOND

FRESATURA  
CUTTING

PANTOGRAFATURA  
ROUTING

FORATURA  
BORING

MANDRINI / ATTACCHI  
CHUCKS & CLAMPING SYSTEM

RICAMBI E LAVORAZIONI SUPP.  
SPARE PARTS & ADD. WORKING

Mandri per punte componibili

Bohrspannfutter

Partie embout fileté

Патроны для сверел

## M040H

## Reducing chucks



Ottenuti da acciaio di elevata resistenza meccanica • Da montare su macchine foratrici: ALBERTI - BALESTRINI - BIESSE - BUSELLATO - GESSNER - MORBIDELLI - TORWEGGE - VITAP - WEEKE • Parti in accoppiamento interamente rettificate in totale rispetto delle norme UNI ed ISO

Obtained from steel with a high mechanical resistance • Use on the following drilling machines: ALBERTI - BALESTRINI - BIESSE - BUSELLATO - GESSNER - MORBIDELLI - TORWEGGE - VITAP - WEEKE • Parts in connection completely ground in observance of the UNI and ISO rules

● = Ready in stock ■ = Delivery time 20 working days △ = On request

| F     | D  | Left Code      | Right Code     | €     |
|-------|----|----------------|----------------|-------|
| 10    | 19 | ● M040010HAAAL | ● M040010HAAAR | 10,60 |
| Spec. |    | M040H99        | M040H99        |       |

### SPARE PARTS

| Type        | Dimensions | Code           | €    |
|-------------|------------|----------------|------|
| Screw       | M6X6       | ● WVGR6        | 0,40 |
| T allen wr. | 3          | ● ACH003AAAAAA | 5,80 |

**NOTE** ■ Utensili non a magazzino, quantità minima d'ordine: **10 pezzi**.  
Tools not ready in stock minimum order quantity: **10 pieces**.

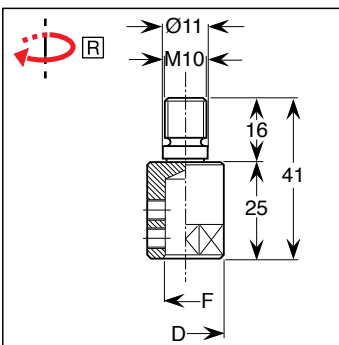

Mandri per punte componibili con attacco rapido

Bohr-Schnellspannfutter

Mandrin à montage rapide

Быстрозажимные патроны для сверел

## M040G

## Quick changing chucks



Ottenuti da acciaio di elevata resistenza meccanica • Da montare su macchine foratrici: BUSELLATO • Parti in accoppiamento interamente rettificata in totale rispetto delle norme UNI ed ISO

Obtained from steel with a high mechanical resistance • Use on the following drilling machines: BUSELLATO • Parts in connection completely ground in observance of the UNI and ISO rules

● = Ready in stock ■ = Delivery time 20 working days △ = On request

| F     | Code           | €     |
|-------|----------------|-------|
| 10    | ● M040010GAAAR | 32,20 |
| Spec. | M040G99        |       |

**NOTE** ■ Utensili non a magazzino, quantità minima d'ordine: **10 pezzi.**  
Tools not ready in stock minimum order quantity: **10 pieces.**

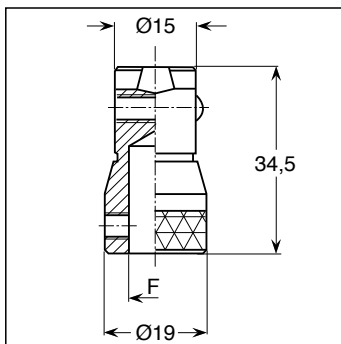

Mandri per punte componibili con attacco rapido

Bohr-Schnellspannfutter

Mandrin à montage rapide

Быстрозажимные патроны для сверел

## M040I

## Quick changing chucks



Ottenuti da acciaio di elevata resistenza meccanica • Da montare su macchine foratrici: WEEKE • Parti in accoppiamento interamente rettificata in totale rispetto delle norme UNI ed ISO

Obtained from steel with a high mechanical resistance • Use on the following drilling machines: WEEKE • Parts in connection completely ground in observance of the UNI and ISO rules

● = Ready in stock ■ = Delivery time 20 working days △ = On request

| F     | Code           | €     |
|-------|----------------|-------|
| 10    | ● M040010IAAAR | 33,60 |
| Spec. | M040I99        |       |

**NOTE** ■ Utensili non a magazzino, quantità minima d'ordine: **10 pezzi.**  
Tools not ready in stock minimum order quantity: **10 pieces.**

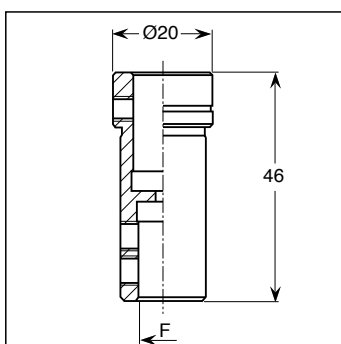

TAGLIO / SEZIONATURA  
SAWING

DIAMANTE  
DIAMOND

FRESATURA  
CUTTING

PANTOGRAFATURA  
ROUTING

FORATURA  
BORING

MANDRINI / ATTACCHI  
CHUCKS & CLAMPING SYSTEM

RICAMBI E LAVORAZIONI SUPP.  
SPARE PARTS & ADD. WORKING

Mandri per punte componibili con attacco rapido

Bohr-Schnellspannfutter

Mandrins à montage rapide

Быстрозажимные патроны для сверел



## M040L

## Quick changing chucks



Ottenuti da acciaio di elevata resistenza meccanica • Da montare su macchine foratrici: BIESSE • Parti in accoppiamento interamente rettificata in totale rispetto delle norme UNI ed ISO

Obtained from steel with a high mechanical resistance • Use on the following drilling machines: BIESSE • Parts in connection completely ground in observance of the UNI and ISO rules

● = Ready in stock ■ = Delivery time 20 working days △ = On request

| F  | LT | Code           | €     |
|----|----|----------------|-------|
| 10 | 37 | ● M040010L37AR | 21,00 |

Spec. M040L99

**NOTE** ■ Utensili non a magazzino, quantità minima d'ordine: **10 pezzi.**  
Tools not ready in stock minimum order quantity: **10 pieces.**

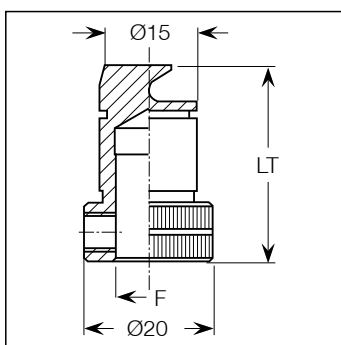

Mandri per punte componibili con attacco rapido

Bohr-Schnellspannfutter

Mandrins à montage rapide

Быстрозажимные патроны для сверел

## M040M

## Quick changing chucks



Ottenuti da acciaio di elevata resistenza meccanica • Da montare su macchine foratrici: MAGGI – MASTEWOOD – GRIGGIO • Parti in accoppiamento interamente rettificata in totale rispetto delle norme UNI ed ISO

Obtained from steel with a high mechanical resistance • Use on the following drilling machines: MAGGI - MASTEWOOD - GRIGGIO • Parts in connection completely ground in observance of the UNI and ISO rules

● = Ready in stock ■ = Delivery time 20 working days △ = On request

| F  | Code           | €     |
|----|----------------|-------|
| 10 | ● M040010MAAAR | 30,40 |

Spec. M040M99

**NOTE** ■ Utensili non a magazzino, quantità minima d'ordine: **10 pezzi.**  
Tools not ready in stock minimum order quantity: **10 pieces.**

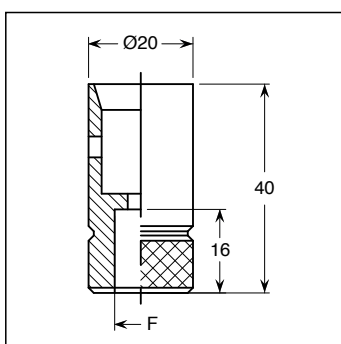

TAGLIO / SEZIONATURA  
SAWING

DIAMANTE  
DIAMOND

FRESATURA  
CUTTING

PANTOGRAFATURA  
ROUTING

FORATURA  
BORING

MANDRINI / ATTACCHI  
CHUCKS & CLAMPING SYSTEM

RICAMBI E LAVORAZIONI SUPP.  
SPARE PARTS & ADD. WORKING

Mandri per punte componibili

Bohr-Schnellspannfutter

Mandrins de montage

Быстрозажимные патроны для сверел

## M040N

## Reducing chucks



Ottenuti da acciaio di elevata resistenza meccanica • Da montare su macchine foratrici: VITAP • Parti in accoppiamento interamente rettificate in totale rispetto delle norme UNI ed ISO

Obtained from steel with a high mechanical resistance • Use on the following drilling machines: VITAP • Parts in connection completely ground in observance of the UNI and ISO rules

● = Ready in stock ■ = Delivery time 20 working days △ = On request

| F     | Code           | €     |
|-------|----------------|-------|
| 10    | ● M040010NAAAR | 28,80 |
| Spec. | M040N99        |       |

**NOTE** ■ Utensili non a magazzino, quantità minima d'ordine: **10 pezzi**.  
Tools not ready in stock minimum order quantity: **10 pieces**.

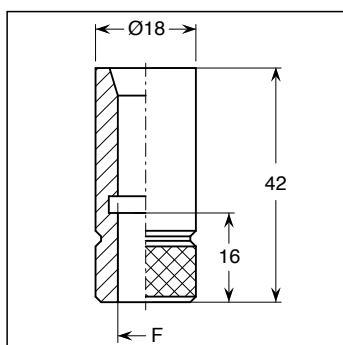

Mandri per punte componibili

Bohr-Schnellspannfutter

Mandrins de montage

Быстрозажимные патроны для сверел

## M040P

## Reducing chucks



Ottenuti da acciaio di elevata resistenza meccanica • Da montare su macchine foratrici: MORBIDELLI • Parti in accoppiamento interamente rettificate in totale rispetto delle norme UNI ed ISO

Obtained from steel with a high mechanical resistance • Use on the following drilling machines: MORBIDELLI • Parts in connection completely ground in observance of the UNI and ISO rules

● = Ready in stock ■ = Delivery time 20 working days △ = On request

| F     | Code           | €     |
|-------|----------------|-------|
| 10    | ● M040010PAAAR | 29,40 |
| Spec. | M040P99        |       |

**NOTE** ■ Utensili non a magazzino, quantità minima d'ordine: **10 pezzi**.  
Tools not ready in stock minimum order quantity: **10 pieces**.

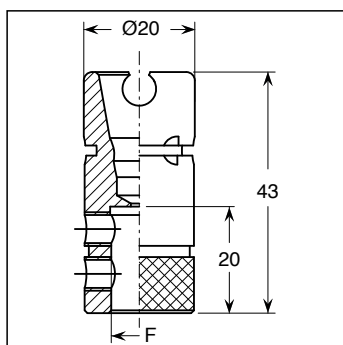

TAGLIO / SEZIONATURA  
SAWING

DIAMANTE  
DIAMOND

FRESATURA  
CUTTING

PANTOGRAFATURA  
ROUTING

FORATURA  
BORING

MANDRINI / ATTACCHI  
CHUCKS & CLAMPING SYSTEM

RICAMBI E LAVORAZIONI SUPP.  
SPARE PARTS & ADD. WORKING

Mandri elastici  
per punte elicoidali

Spannzange  
für Bohrspannfutter

Douilles fendues avec  
méplat sur queue

Переходная втулка  
для сверел

**M041**

**Spring chucks for twist drills**



Ottenuti da acciaio di elevata resistenza meccanica • Per montare punte art. P104 – P105 – P107 – P109 su mandrini portapunte M040 • Parti in accoppiamento interamente rettificate in totale rispetto delle norme UNI ed ISO

Obtained from steel with a high mechanical resistance • Use with drills item nr. P104 - P105 - P107 - P109 on reducing chucks M040 • Parts in connection completely ground in observance of the UNI and ISO rules

● = Ready in stock ■ = Delivery time 20 working days △ = On request

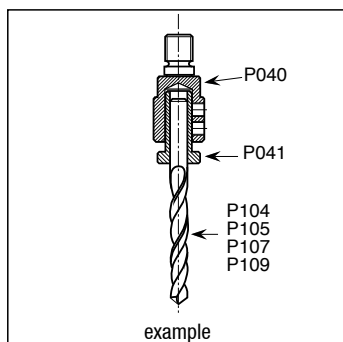
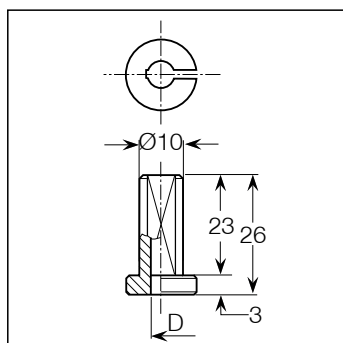

| D     | Code           | €     |
|-------|----------------|-------|
| 2     | ● M041020AAAAA | 11,40 |
| 2,5   | ● M041025AAAAA | 11,40 |
| 3     | ● M041030AAAAA | 11,40 |
| 3,2   | ● M041032AAAAA | 11,40 |
| 3,5   | ● M041035AAAAA | 11,40 |
| 4     | ● M041040AAAAA | 11,40 |
| 4,5   | ● M041045AAAAA | 11,40 |
| 5     | ● M041050AAAAA | 11,40 |
| 5,5   | ● M041055AAAAA | 11,40 |
| 6     | ● M041060AAAAA | 11,40 |
| 6,5   | ● M041065AAAAA | 11,40 |
| 7     | ● M041070AAAAA | 11,40 |
| 7,5   | ● M041075AAAAA | 11,40 |
| 8     | ● M041080AAAAA | 11,40 |
| Spec. | M041099        |       |

**NOTE** ■ Utensili non a magazzino, quantità minima d'ordine: **10 pezzi.**  
Tools not ready in stock minimum order quantity: **10 pieces.**

TAGLIO / SEZIONATURA  
SAWING

DIAMANTE  
DIAMOND

FRESATURA  
CUTTING

PANTOGRAFATURA  
ROUTING

FORATURA  
BORING

MANDRINI / ATTACCHI  
CHUCKS & CLAMPING SYSTEM

RICAMBI E LAVORAZIONI SUPP.  
SPARE PARTS & ADD. WORKING





Pinze elastiche  
ad elevata precisione  
ER25 DIN6499

Spannzange  
ER25 DIN6499

Pinces de serrage pour  
mandrins de défonceuse  
ER25 DIN6499

Цанги высокоточные  
ER25 DIN6499

## M231

## High precision collets ER25 DIN6499

TAGLIO / SEZIONATURA  
SAWING

DIAMANTE  
DIAMOND

FRESATURA  
CUTTING

PANTOGRAFATURA  
ROUTING

FORATURA  
BORING

MANDRINI / ATTACCHI  
CHUCKS & CLAMPING SYSTEM

RICAMBI E LAVORAZIONI SUPP.  
SPARE PARTS & ADD. WORKING

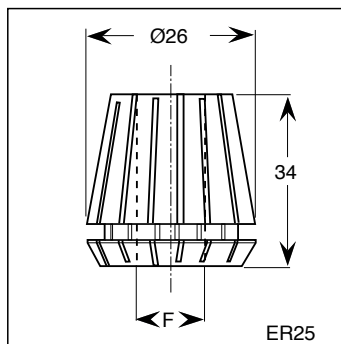

Ottenute da acciaio di elevata resistenza meccanica • Con tagli assiali intercalati • Elevato campo di serraggio • Parti in accoppiamento interamente rettificate • Abbinabili a mandrini M709

Obtained from steel with a high mechanical resistance • Axial cuts interspersed • High clamping range • To use with chucks M709 • Parts in connection completely ground

● = Ready in stock ■ = Delivery time 20 working days △ = On request

| F     | Code           | €     |
|-------|----------------|-------|
| 5-4   | ■ M23100504AAA | 19,40 |
| 6-5   | ■ M23100605AAA | 19,40 |
| 7-6   | ■ M23100706AAA | 19,40 |
| 8-7   | ■ M23100807AAA | 19,40 |
| 9-8   | ■ M23100908AAA | 19,40 |
| 10-9  | ■ M23101009AAA | 19,40 |
| 11-10 | ■ M23101110AAA | 19,40 |
| 12-11 | ■ M23101211AAA | 19,40 |
| 13-12 | ■ M23101312AAA | 19,40 |
| 14-13 | ■ M23101413AAA | 19,40 |
| 16-15 | ■ M23101615AAA | 19,40 |
| Spec. | M231099        |       |

**NOTE** ■ Utensili non a magazzino, quantità minima d'ordine: **10 pezzi.**  
Tools not ready in stock minimum order quantity: **10 pieces.**

Pinze elastiche  
ad elevata precisione  
ER32 DIN6499

Spannzange  
ER32 DIN6499

Pinces de serrage  
pour mandrins de défonceuse  
ER32 DIN6499

Цанги высокоточные  
ER32 DIN6499

## M233

## High precision collets ER32 DIN6499

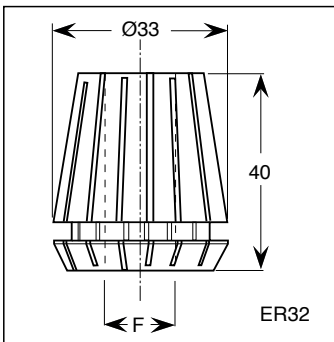

Ottenute da acciaio di elevata resistenza meccanica • Con tagli assiali intercalati • Elevato campo di serraggio • Parti in accoppiamento interamente rettificata • Abbinabili a mandrini art. M700 – M701 – M702 – M703 – M705 – M720 – M722 – M726

Obtained from steel with a high mechanical resistance • Axial cuts interspersed • High clamping range • Parts in connection completely ground • To use with chucks M700 – M701 – M702 – M703 – M705 – M720 – M722 – M726

● = Ready in stock ■ = Delivery time 20 working days △ = On request

| F     | Code           | €     |
|-------|----------------|-------|
| 3-2   | ● M23300302AAA | 15,60 |
| 4-3   | ● M23300403AAA | 15,60 |
| 5-4   | ● M23300504AAA | 15,60 |
| 6-5   | ● M23300605AAA | 15,60 |
| 7-6   | ● M23300706AAA | 15,60 |
| 8-7   | ● M23300807AAA | 15,60 |
| 9-8   | ● M23300908AAA | 15,60 |
| 3/8"  | ● M23300308AAA | 15,60 |
| 10-9  | ● M23301009AAA | 15,60 |
| 12-11 | ● M23301211AAA | 15,60 |
| 13-12 | ● M23301312AAA | 15,60 |
| 14-13 | ● M23301413AAA | 15,60 |
| 16-15 | ● M23301615AAA | 15,60 |
| 18-17 | ● M23301817AAA | 15,60 |
| 20-19 | ● M23302019AAA | 15,60 |
| Spec. | M233099        |       |

**NOTE** ■ Utensili non a magazzino, quantità minima d'ordine: **10 pezzi.**  
Tools not ready in stock minimum order quantity: **10 pieces.**

TAGLIO / SEZIONATURA  
SAWING

DIAMANTE  
DIAMOND

FRESATURA  
CUTTING

PANTOGRAFATURA  
ROUTING

FORATURA  
BORING

MANDRINI / ATTACCHI  
CHUCKS & CLAMPING SYSTEM

RICAMBI E LAVORAZIONI SUPP.  
SPARE PARTS & ADD. WORKING



Pinze elastiche ad elevata precisione ER40 DIN6499

Spannzange ER40 DIN6499

Pinces de serrage pour mandrins de défonceuse ER40 DIN6499

Цанги высокоточные ER40 DIN6499

TAGLIO / SEZIONATURA  
SAWING

DIAMANTE  
DIAMOND

FRESATURA  
CUTTING

PANTOGRAFATURA  
ROUTING

FORATURA  
BORING

MANDRINI / ATTACCHI  
CHUCKS & CLAMPING SYSTEM

RICAMBI E LAVORAZIONI SUPP.  
SPARE PARTS & ADD. WORKING

## M234

## High precision collets ER40 DIN6499

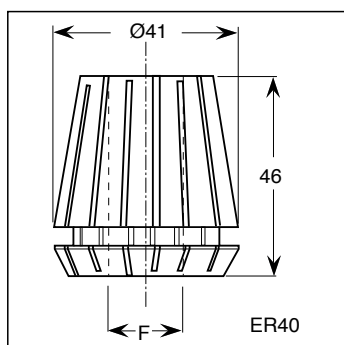

Ottenute da acciaio di elevata resistenza meccanica • Con tagli assiali intercalati • Elevato campo di serraggio • Parti in accoppiamento interamente rettificate • Abbinabili a mandrini art. M700 – M701 – M702 – M703 – M705 – M707 – M720 – M722

Obtained from steel with a high mechanical resistance • Axial cuts interspersed • High clamping range • To use with chucks M700 - M701 - M702 - M703 - M705 - M707 - M720 - M722 • Parts in connection completely ground

● = Ready in stock ■ = Delivery time 20 working days △ = On request

| F     | Code           | €     |
|-------|----------------|-------|
| 4-3   | ● M23400403AAA | 22,80 |
| 5-4   | ● M23400504AAA | 22,80 |
| 6-5   | ● M23400605AAA | 22,80 |
| 8-7   | ● M23400807AAA | 20,20 |
| 10-9  | ● M23401009AAA | 20,20 |
| 12-11 | ● M23401211AAA | 20,20 |
| 14-13 | ● M23401413AAA | 20,20 |
| 16-15 | ● M23401615AAA | 20,20 |
| 18-17 | ● M23401817AAA | 20,20 |
| 20-19 | ● M23402019AAA | 20,20 |
| 25-14 | ● M23402524AAA | 20,20 |
| 30    | ● M23403029AAA | 35,00 |
| Spec. | M234099        |       |

**NOTE** ■ Utensili non a magazzino, quantità minima d'ordine: **10 pezzi**.  
Tools not ready in stock minimum order quantity: **10 pieces**.



## M235

## High precision collets ORT25 DIN6388

TAGLIO / SEZIONATURA  
SAWING

DIAMANTE  
DIAMOND

FRESATURA  
CUTTING

PANTOGRAFATURA  
ROUTING

FORATURA  
BORING

MANDRINI / ATTACCHI  
CHUCKS & CLAMPING SYSTEM

RICAMBI E LAVORAZIONI SUPP.  
SPARE PARTS & ADD. WORKING



Ottenute da acciaio di elevata resistenza meccanica • Con tagli assiali intercalati • Elevato campo di serraggio • Parti in accoppiamento interamente rettificate • Abbinabili a mandrini art. M700 – M701 – M703 – M705 – M707 – M720

Obtained from steel with a high mechanical resistance • Axial cuts interspersed • High clamping range • To use with chucks M700 - M701 - M703 - M705 - M707 - M720 • Parts in connection completely ground

● = Ready in stock ■ = Delivery time 20 working days △ = On request

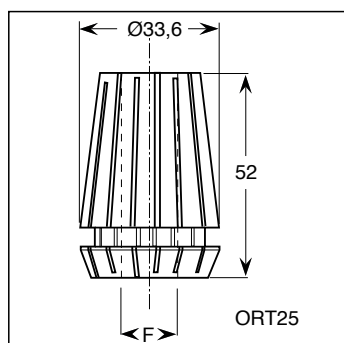

| F       | Code           | €     |
|---------|----------------|-------|
| 4-3     | ● M23500403AAA | 31,80 |
| 5-4     | ● M23500504AAA | 31,80 |
| 6-5     | ● M23500605AAA | 31,80 |
| 8-7     | ● M23500807AAA | 31,80 |
| 9,5-8,5 | ● M23500308AAA | 48,40 |
| 10-9    | ● M23501009AAA | 31,80 |
| 12-11   | ● M23501211AAA | 31,80 |
| 14-13   | ● M23501413AAA | 31,80 |
| 16-15   | ● M23501615AAA | 31,80 |
| 18-17   | ● M23501817AAA | 31,80 |
| 20-19   | ● M23502019AAA | 31,80 |
| 25-24   | ● M23502524AAA | 31,80 |
| Spec.   | M235099        |       |

**NOTE** ■ Utensili non a magazzino, quantità minima d'ordine: **10 pezzi.**  
Tools not ready in stock minimum order quantity: **10 pieces.**

Pinze elastiche  
ad elevata precisione  
ORT25 DIN69893

Spannzange  
ORT25 DIN69893

Pinces élastiques  
de haute précision  
ORT25 DIN69893

Цанги высокоточные  
ORT25 DIN69893

**M236**

**TOP high precision collets ORT25 DIN69893**



Ottenute da acciaio di elevata resistenza meccanica • Con tagli assiali intercalati • Elevata precisione di serraggio • Parti in accoppiamento interamente rettificate • Abbinabili a mandrini art. M937

Obtained from steel with a high mechanical resistance • Axial cuts interspersed • High clamping precision • Parts in connection completely ground • To use with chucks M937

● = Ready in stock ■ = Delivery time 20 working days △ = On request

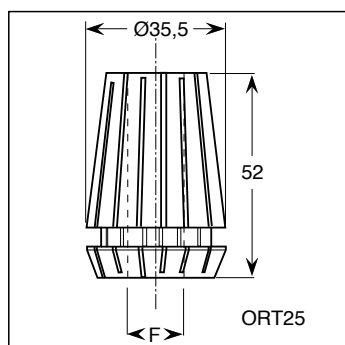

| F       | Code           | €      |
|---------|----------------|--------|
| 3-2,5   | ● M236103025AA | 103,00 |
| 4-3,5   | ● M236104035AA | 103,00 |
| 6-5,5   | ● M236106055AA | 103,00 |
| 8-7,5   | ● M236108075AA | 103,00 |
| 10-9,5  | ● M236110095AA | 103,00 |
| 12-11,5 | ● M236112115AA | 103,00 |
| 14-13,5 | ● M236114135AA | 103,00 |
| 16-15,5 | ● M236116155AA | 103,00 |
| 18-17,5 | ● M236118175AA | 103,00 |
| 20-19,5 | ● M236120195AA | 103,00 |
| 25-24,5 | ● M236125245AA | 103,00 |

Spec. M236099

**NOTE** ■ Utensili non a magazzino, quantità minima d'ordine: **10 pezzi.**  
Tools not ready in stock minimum order quantity: **10 pieces.**

TAGLIO / SEZIONATURA  
SAWING

DIAMANTE  
DIAMOND

FRESATURA  
CUTTING

PANTOGRAFATURA  
ROUTING

FORATURA  
BORING

MANDRINI / ATTACCHI  
CHUCKS & CLAMPING SYSTEM

RICAMBI E LAVORAZIONI SUPP.  
SPARE PARTS & ADD. WORKING

Pinze elastiche  
ad elevata precisione  
ETS

Spannzange ETS

Pinces de serrage  
pour mandrins  
à haute précision ETS

Цанги высокоточные  
ETS32

**M238**

**High precision collets ETS**

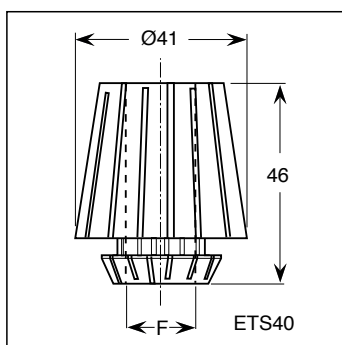
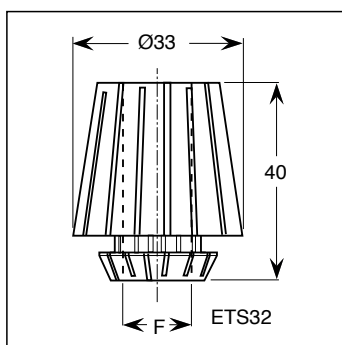

Ottenute da acciaio di elevata resistenza meccanica • Con tagli assiali intercalati • Elevato campo di serraggio • Parti in accoppiamento interamente rettificata • Abbinabili a mandrini art. M700 – M701 – M702 – M703 – M705 – M707 – M720 – M722 – M726 mediante ghiera M730 ETS

Obtained from steel with a high mechanical resistance • Axial cuts interspersed • High clamping range • To use with chucks M700 – M701 – M702 – M703 – M705 – M707 – M720 – M722 – M726 with ring nut M730 ETS • Parts in connection completely ground

● = Ready in stock ■ = Delivery time 20 working days △ = On request

| F     | Code           | €     |
|-------|----------------|-------|
| 4–3   | ● M23800403S32 | 41,00 |
| 6–5   | ● M23800605S32 | 41,00 |
| 8–7   | ● M23800807S32 | 41,00 |
| 10–9  | ● M23801009S32 | 41,00 |
| 12–11 | ● M23801211S32 | 41,00 |
| 14–13 | ● M23801413S32 | 41,00 |
| 16–15 | ● M23801615S32 | 41,00 |
| 18–17 | ● M23801817S32 | 41,00 |
| 20–19 | ● M23802019S32 | 41,00 |
| Spec. | M238099        |       |

| F     | Code           | €     |
|-------|----------------|-------|
| 4–3   | ● M23800403S40 | 46,20 |
| 6–5   | ● M23800605S40 | 46,20 |
| 8–7   | ● M23800807S40 | 46,20 |
| 10–9  | ● M23801009S40 | 46,20 |
| 12–11 | ● M23801211S40 | 46,20 |
| 14–13 | ● M23801413S40 | 46,20 |
| 16–15 | ● M23801615S40 | 46,20 |
| 18–17 | ● M23801817S40 | 46,20 |
| 20–19 | ● M23802019S40 | 46,20 |
| Spec. | M238099        |       |

**NOTE** ■ Utensili non a magazzino, quantità minima d'ordine: **10 pezzi.**  
Tools not ready in stock minimum order quantity: **10 pieces.**

TAGLIO / SEZIONATURA  
SAWING

DIAMANTE  
DIAMOND

FRESATURA  
CUTTING

PANTOGRAFATURA  
ROUTING

FORATURA  
BORING

MANDRINI / ATTACCHI  
CHUCKS & CLAMPING SYSTEM

RICAMBI E LAVORAZIONI SUPP.  
SPARE PARTS & ADD. WORKING

Mandrini centrici  
SK30 DIN69871

Spannzangenfutter  
SK30 DIN69871

Mandrins concentriques  
à pince SK30 DIN69871

Патроны высокоточные  
SK30 DIN69871

## M700

## Collect chucks SK30 DIN69871



Ottenuti da acciaio di elevata qualità • Parti in accoppiamento interamente rettificata • Altissima precisione con perfetto centraggio dell'utensile • Adatti per l'utilizzo di utensili con attacco cilindrico mediante pinze art. M233 – M234 – M235  
• La pinza non è inclusa nel mandrino • Utilizzabili su macchine BIESSE

Obtained from high quality steel • Parts in connection completely ground • High precision with perfect alignment of the tool • Use with cylindrical shank router bits • Mount high precision collect item M233 - M234 - M235 • High precision collect is not included in the chuck • To mount on BIESSE machines

● = Ready in stock ■ = Delivery time 20 working days △ = On request

| D  | H  | H.P.Collect | Left Code      | €             | Right Code     | €             |
|----|----|-------------|----------------|---------------|----------------|---------------|
| 50 | 49 | ER32        | ■ M7000R2550AL | <b>83,00</b>  | ● M7000R2550AR | <b>83,00</b>  |
| 63 | 57 | ER40        | ■ M7000R4063AL | <b>112,40</b> | ● M7000R4063AR | <b>96,80</b>  |
| 60 | 57 | ORT25       | ■ M7000R2560AL | <b>163,60</b> | ● M7000R2560AR | <b>154,80</b> |

Spec. M700099L M700099R

### SPARE PARTS

| Type                      | Code           | €            |
|---------------------------|----------------|--------------|
| Retain bolt BIESSE        | ● M8000AAAAAA3 | <b>26,60</b> |
| Wrench for ring nut 52/55 | ● ACH052AAAAAA | <b>34,00</b> |
| Wrench for ring nut 58/62 | ● ACH058AAAAAA | <b>34,00</b> |

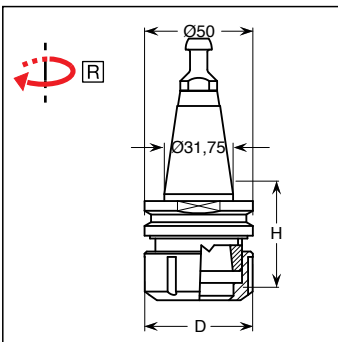

■ Utensili non a magazzino, quantità minima d'ordine: **1 pezzo**.  
Tools not ready in stock minimum order quantity: **1 piece**.

Mandrini centrici  
SK30

Spannzangenfutter  
SK30

Mandrins concentriques  
SK30

Патроны высокоточные  
SK30

## M701

## Collect chucks SK30



Ottenuti da acciaio di elevata qualità • Parti in accoppiamento interamente rettificata • Altissima precisione con perfetto centraggio dell'utensile • Adatte per l'utilizzo di utensili con attacco cilindrico mediante pinze art. M233 – M234 – M235  
• La pinza non è inclusa nel mandrino • Utilizzabili su macchine CMS

Obtained from high quality steel • Parts in connection completely ground • High precision with perfect alignment of the tool • Use with cylindrical shank router bits • Mount high precision collect item M233 - M234 - M235 • High precision collect is not included in the chuck • To mount on CMS machines

● = Ready in stock ■ = Delivery time 20 working days △ = On request

| D  | H  | H.P.Collect | Left Code      | €             | Right Code     | €             |
|----|----|-------------|----------------|---------------|----------------|---------------|
| 50 | 60 | ER32        | ■ M7010R2550SL | <b>112,40</b> | ● M7010R2550SR | <b>96,80</b>  |
| 63 | 65 | ER40        | ■ M7010R4063SL | <b>112,40</b> | ● M7010R4063SR | <b>96,80</b>  |
| 60 | 70 | ORT25       | ■ M7010T2560AL | <b>163,60</b> | ● M7010T2560AR | <b>154,80</b> |

Spec. M701099L M701099R

### SPARE PARTS

| Type                      | Code           | €            |
|---------------------------|----------------|--------------|
| Retain bolt CMS           | ● M8000AAAAAA9 | <b>26,60</b> |
| Wrench for ring nut 52/55 | ● ACH052AAAAAA | <b>34,00</b> |
| Wrench for ring nut 58/62 | ● ACH058AAAAAA | <b>34,00</b> |

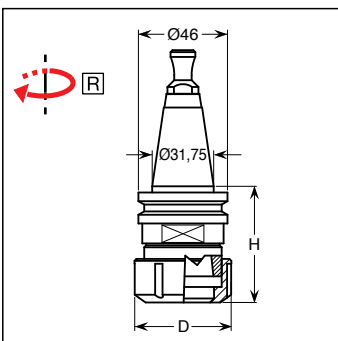

■ Utensili non a magazzino, quantità minima d'ordine: **1 pezzo**.  
Tools not ready in stock minimum order quantity: **1 piece**.

TAGLIO / SEZIONATURA  
SAWING

DIAMANTE  
DIAMOND

FRESATURA  
CUTTING

PANTOGRAFATURA  
ROUTING

FORATURA  
BORING

MANDRINI / ATTACCHI  
CHUCKS & CLAMPING SYSTEM

RICAMBI E LAVORAZIONI SUPP.  
SPARE PARTS & ADD. WORKING



Mandri centri SK30

Spannzangenfutter SK30

Mandrins concentriques SK30

Патроны высокоточные SK30

## M702

### Collect chucks SK30



Ottenuti da acciaio di elevata qualità • Parti in accoppiamento interamente rettificate • Altissima precisione con perfetto centraggio dell'utensile • Adatti per l'utilizzo con attacco cilindrico mediante pinze art. M233 – M234 • La pinza non è inclusa nel mandrino • Utilizzabili su macchine ESSETEAM – UNITEAM

Obtained from high quality steel • Parts in connection completely ground • High precision with perfect alignment of the tool • Use with cylindrical shank router bits • Mount high precision collect item M233 - M234 • High precision collect is not included in the chuck • To mount on ESSETEAM - UNITEAM machines

● = Ready in stock ■ = Delivery time 20 working days △ = On request

| D  | H  | H.P.Collect | Left Code      | €      | Right Code     | €      |
|----|----|-------------|----------------|--------|----------------|--------|
| 50 | 63 | ER32        | ■ M7020R3250AL | 128,00 | ● M7020R3250RL | 112,40 |
| 63 | 65 | ER40        | ■ M7020R4063AL | 128,00 | ● M7020R4063RL | 112,40 |

| Spec. | M702099L | M702099R |
|-------|----------|----------|
|       |          |          |

#### SPARE PARTS

| Type                      | Code           | €     |
|---------------------------|----------------|-------|
| Retaining bolt            | ● M8000AAAAA2  | 26,60 |
| Retaining bolt            | ● M8000AAAAA4  | 26,60 |
| Wrench for ring nut 52/55 | ● ACH052AAAAAA | 34,00 |
| Wrench for ring nut 58/62 | ● ACH058AAAAAA | 34,00 |

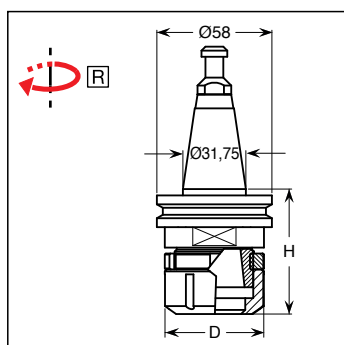

■ Utensili non a magazzino, quantità minima d'ordine: 1 pezzo.  
Tools not ready in stock minimum order quantity: 1 piece.

Mandri centri SK30

Spannzangenfutter SK30

Mandrins concentriques SK30

Патроны высокоточные SK30

## M703

### Collect chucks SK30



Ottenuti da acciaio di elevata qualità • Parti in accoppiamento interamente rettificate • Altissima precisione con perfetto centraggio dell'utensile • Adatti per l'utilizzo di utensili con attacco cilindrico mediante pinze art. M233 – M234 – M235 • La pinza non è inclusa nel mandrino • Utilizzabili su macchine WEEKE

Obtained from high quality steel • Parts in connection completely ground • High precision with perfect alignment of the tool • Use with cylindrical shank router bits • Mount high precision collect item M233 - M234 - M235 • High precision collect is not included in the chuck • To mount on WEEKE machines

● = Ready in stock ■ = Delivery time 20 working days △ = On request

| D  | H  | H.P.Collect | Left Code      | €      | Right Code     | €      |
|----|----|-------------|----------------|--------|----------------|--------|
| 50 | 68 | ER32        | ■ M7030R3250AL | 112,40 | ● M7030R3250AR | 96,80  |
| 63 | 68 | ER40        | ■ M7030R4063AL | 112,40 | ● M7030R4063AR | 96,80  |
| 60 | 70 | ORT25       | ■ M7030T2560AL | 163,60 | ● M7030T2560AR | 154,80 |

| Spec. | M703099L | M703099R |
|-------|----------|----------|
|       |          |          |

#### SPARE PARTS

| Type                      | Code           | €     |
|---------------------------|----------------|-------|
| Retaining bolt            | ● M8000AAAAA2  | 26,60 |
| Wrench for ring nut 52/55 | ● ACH052AAAAAA | 34,00 |
| Wrench for ring nut 58/62 | ● ACH058AAAAAA | 34,00 |

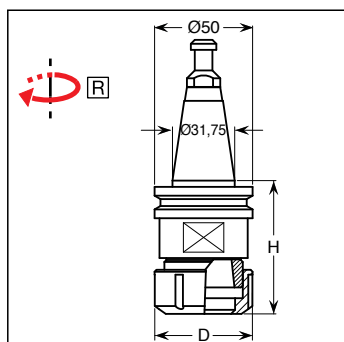

■ Utensili non a magazzino, quantità minima d'ordine: 1 pezzo.  
Tools not ready in stock minimum order quantity: 1 piece.



Mandrini centrici SK30  
con flangia dentata



Spannzangenfutter  
SK30



Mandrins concentriques  
à pince SK30 cranté



Патроны высокоточные  
SK30

TAGLIO / SEZIONATURA  
SAWING

DIAMANTE  
DIAMOND

FRESATURA  
CUTTING

PANTOGRAFATURA  
ROUTING

FORATURA  
BORING

MANDRINI / ATTACCHI  
CHUCKS & CLAMPING SYSTEM

RICAMBI E LAVORAZIONI SUPP.  
SPARE PARTS & ADD. WORKING

## M705

## Collect chucks SK30



Ottenuti da acciaio di elevata qualità • Parti in accoppiamento interamente rettificate • Altissima precisione con perfetto centraggio dell'utensile • Adatti per l'utilizzo di utensili con attacco cilindrico mediante pinze art. M233 - M234 - M235 • La pinza non è inclusa nel mandrino • Utilizzabili su macchine SCM e MORBIDELLI

Obtained from high quality steel • Parts in connection completely ground • High precision with perfect alignment of the tool • Use with cylindrical shank router bits • Mount high precision collect item M233 - M234 - M235 • High precision collect is not included in the chuck • To mount on SCM - MORBIDELLI machines

● = Ready in stock ■ = Delivery time 20 working days △ = On request

| D     | H  | H.P.Collect | Left Code      | €      | Right Code     | €      |
|-------|----|-------------|----------------|--------|----------------|--------|
| 60    | 55 | ER32        | ■ M7050R3250AL | 124,80 | ● M7050R3250AR | 124,80 |
| 63    | 72 | ER40        | ■ M7050R4063AL | 124,80 | ● M7050R4063AR | 124,80 |
| 60    | 72 | ORT25       | ■ M7050T2560AL | 157,80 | ● M7050T2560AR | 124,80 |
| Spec. |    |             | M705099L       |        | M705099R       |        |

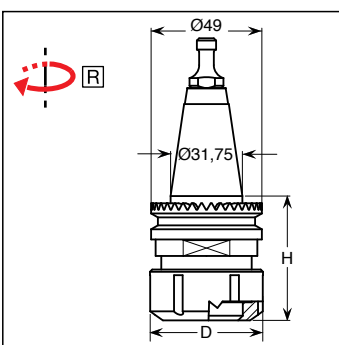

■ Utensili non a magazzino, quantità minima d'ordine: **1 pezzo**.  
Tools not ready in stock minimum order quantity: **1 piece**.

### SPARE PARTS

| Type                            | Code           | €     |
|---------------------------------|----------------|-------|
| Retaining bolt MORBIDELLI - SCM | ● M8000AAAAA1  | 26,60 |
| Wrench for ring nut 52/55       | ● ACH052AAAAAA | 34,00 |
| Wrench for ring nut 58/62       | ● ACH058AAAAAA | 34,00 |



Mandrini centrici  
SK40 DIN69871



Spannzangenfutter  
SK40 DIN69871



Mandrins concentriques  
SK40 DIN69871



Патроны  
SK30 DIN69871

## M707

## Collect chucks SK40 DIN69871



Ottenuti da acciaio di elevata qualità • Parti in accoppiamento interamente rettificate • Altissima precisione con perfetto centraggio dell'utensile • Adatti per l'utilizzo di utensili con attacco cilindrico mediante pinze art. M234 - M235 • La pinza non è inclusa nel mandrino • Utilizzabili su macchine IMA - MAKA - REICHEMBACHER - STEGHERR - WEEKE

Obtained from high quality steel • Parts in connection completely ground • High precision with perfect alignment of the tool • Use with cylindrical shank router bits • Mount high precision collect item M234 - M235 • High precision collect is not included in the chuck • To mount on IMA - MAKA - REICHEMBACHER - STEGHERR - WEEKE machines

● = Ready in stock ■ = Delivery time 20 working days △ = On request

| D     | H  | H.P.Collect | Left Code      | €      | Right Code     | €      |
|-------|----|-------------|----------------|--------|----------------|--------|
| 63    | 68 | ER40        | ■ M7070R4063AL | 195,00 | ● M7070R4063AR | 187,20 |
| 60    | 74 | ORT25       | ■ M7070T2560AL | 195,00 | ● M7070T2560AR | 171,60 |
| Spec. |    |             | M707099L       |        | M707099R       |        |

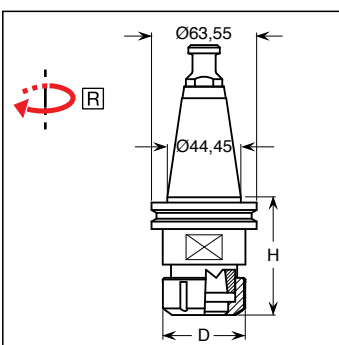

■ Utensili non a magazzino, quantità minima d'ordine: **1 pezzo**.  
Tools not ready in stock minimum order quantity: **1 piece**.

### SPARE PARTS

| Type                      | Code           | €     |
|---------------------------|----------------|-------|
| Retaining bolt            | ● M8000AAAAA8  | 36,00 |
| Wrench for ring nut 52/55 | ● ACH052AAAAAA | 34,00 |
| Wrench for ring nut 58/62 | ● ACH058AAAAAA | 34,00 |

Mandri centri ER40

Spannzangenfutter ER40

Mandrins concentriques ER40

Патроны ER40

## M709

## Collect chucks ER40



Ottenuti da acciaio di elevata qualità • Parti in accoppiamento interamente rettificate • Altissima precisione con perfetto centraggio dell'utensile • Adatti per l'utilizzo di utensili con attacco cilindrico mediante pinze art. M231 e/o frese • La pinza non è inclusa nel mandrino • Utilizzabili su macchine BACCI

Obtained from high quality steel • Parts in connection completely ground • High precision with perfect alignment of the tool • Use with cylindrical shank router bits • Mount high precision collect item M231 and/or cutters • High precision collect is not included in the chuck • To mount on BACCI machines

● = Ready in stock ■ = Delivery time 20 working days △ = On request

| D     | D1 | H   | Left Code      | €      | Right Code     | €      |
|-------|----|-----|----------------|--------|----------------|--------|
| 35    | 30 | 140 | ■ M7090R2535AL | 941,40 | ■ M7090R2535AR | 771,20 |
| Spec. |    |     | M709099L       |        | M709099R       |        |

### SPARE PARTS

| Type                                  | Left Code      | Right Code     | €     |
|---------------------------------------|----------------|----------------|-------|
| Collet nut                            | ■ M7300ER25AAL | ■ M7300ER25AAR | 36,00 |
| Ring nut for spindle                  | ■ M74004408AAL | ■ M74004408AAR | 48,00 |
| Wrench for ring nut h.p.collect 34/36 |                | ■ ACH034AAAAAA | 28,00 |

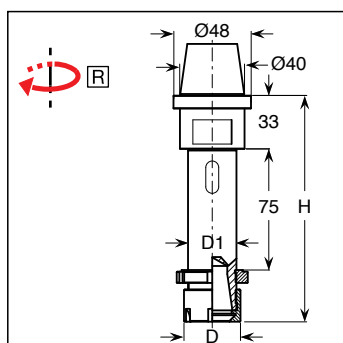

■ Utensili non a magazzino, quantità minima d'ordine: **1 pezzo**.  
Tools not ready in stock minimum order quantity: **1 piece**.

Mandri centri HSK 63F DIN69893

Spannzangenfutter HSK 63F DIN69893

Mandrins concentriques à pince HSK 63F DIN69893

Патроны HSK 63F DIN69893

## M720

## Collect chucks HSK 63F DIN69893



Ottenuti da acciaio di elevata qualità • Parti in accoppiamento interamente rettificate • Altissima precisione con perfetto centraggio dell'utensile • Adatti per l'utilizzo di utensili con attacco cilindrico mediante pinze art. M233 - M234 - M235 • La pinza non è inclusa nel mandrino • Utilizzabili su macchine BIESSE - IMA - MASTERWOD - MORBIDELLI - SCM - WEEKE

Obtained from high quality steel • Parts in connection completely ground • High precision with perfect alignment of the tool • Use with cylindrical shank router bits • Mount high precision collect item M233 - M234 - M235 • High precision collect is not included in the chuck • To mount on BIESSE - IMA - MASTERWOOD - MORBIDELLI - SCM - WEEKE machines

● = Ready in stock ■ = Delivery time 20 working days △ = On request

| D     | H  | H.P.Collect | Left Code      | €      | Right Code     | €      |
|-------|----|-------------|----------------|--------|----------------|--------|
| 50    | 73 | ER32        | ■ M7200R3250AL | 99,40  | ● M7200R3250AR | 99,40  |
| 63    | 76 | ER40        | ■ M7200R4063AL | 115,00 | ● M7200R4063AR | 115,00 |
| 60    | 76 | ORT25       | ■ M7200T2560AL | 156,00 | ● M7200T2560AR | 127,60 |
| Spec. |    |             | M720099L       |        | M720099R       |        |

### SPARE PARTS

| Type                      | Code           | €     |
|---------------------------|----------------|-------|
| Wrench for ring nut 52/55 | ● ACH052AAAAAA | 34,00 |
| Wrench for ring nut 58/62 | ● ACH058AAAAAA | 34,00 |

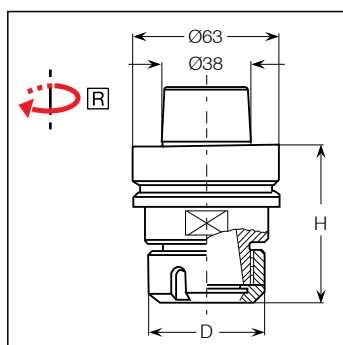

■ Utensili non a magazzino, quantità minima d'ordine: **1 pezzo**.  
Tools not ready in stock minimum order quantity: **1 piece**.

Mandri centri  
HSK 63E DIN69893

Spannzangenfutter  
HSK 63E DIN69893

Mandrins concentriques  
à pince HSK 63E DIN69893

Патроны  
HSK 63E DIN69893

## M722

## Collect chuck HSK 63E DIN69893



Ottenuti da acciaio di elevata qualità • Parti in accoppiamento interamente rettificate • Altissima precisione con perfetto centraggio dell'utensile • Adatti per l'utilizzo di utensili con attacco cilindrico mediante pinze art. M233 – M234 – M235 • La pinza non è inclusa nel mandrino • Utilizzabili su macchine CMS

Obtained from high quality steel • Parts in connection completely ground • High precision with perfect alignment of the tool • Use with cylindrical shank router bits • Mount high precision collect item M233 - M234 - M235 • High precision collect is not included in the chuck • To mount on CMS machines

● = Ready in stock ■ = Delivery time 20 working days △ = On request

| D  | H  | H.P.Collect | Left Code      | €     | Right Code     | €     |
|----|----|-------------|----------------|-------|----------------|-------|
| 50 | 78 | ER32        | ■ M7220R3250AL | 93,60 | ● M7220R3250AR | 93,60 |
| 63 | 78 | ER40        | ■ M7220R4063AL | 93,60 | ● M7220R4063AR | 93,60 |

|       |          |          |
|-------|----------|----------|
| Spec. | M722099L | M722099R |
|-------|----------|----------|

### SPARE PARTS

| Type                      | Code           | €     |
|---------------------------|----------------|-------|
| Wrench for ring nut 52/55 | ● ACH052AAAAAA | 34,00 |
| Wrench for ring nut 58/62 | ● ACH058AAAAAA | 34,00 |

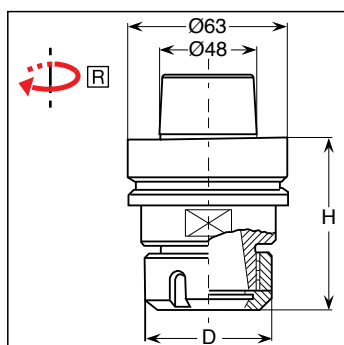

■ Utensili non a magazzino, quantità minima d'ordine: **1 pezzo**.  
Tools not ready in stock minimum order quantity: **1 piece**.

Mandri  
ad alta precisione  
HSK 63F DIN69893

Präzisions  
-Spannzangenfutter  
HSK 63F DIN69893

Mandrin concentrique  
porte-pince avec haute tolérance  
HSK 63F DIN69893

Патроны высокоточные  
HSK 63F DIN69893

## M937

## High precision collet chuck HSK 63F DIN69893



Ottenuti da acciaio di elevata qualità • Parti in accoppiamento interamente rettificate • Altissima precisione run-out 0,003 mm per un perfetto centraggio dell'utensile • Adatti per l'utilizzo di utensili con attacco cilindrico • La pinza non è inclusa nel mandrino • Utilizzabili su macchine BIESSE – IMA – MASTERWOD – MORBIDELLI – SCM – WEEKE • Utilizzabili con pinze M236 ad alta precisione DIN69893

Obtained from high quality steel • Parts in connection completely ground • High precision with run-out 0,003 mm for a perfect alignment of the tool • Use with cylindrical shank router bits • Mount high precision collect item • High precision collect is not included in the chuck • To mount on BIESSE - IMA - MASTERWOOD - MORBIDELLI - SCM - WEEKE machines • Usable with very high precision collets M236 DIN 69893

● = Ready in stock ■ = Delivery time 20 working days △ = On request

| D  | H  | Collet | Code           | €      |
|----|----|--------|----------------|--------|
| 50 | 75 | ORT25  | ● M9370000063F | 250,00 |

|       |         |
|-------|---------|
| Spec. | M937099 |
|-------|---------|

### SPARE PARTS

| Type   | Dimensions | Code           | €     |
|--|------------|----------------|-------|
|  Wrench | Ø50        | ● ACH050AAAAAA | 50,00 |

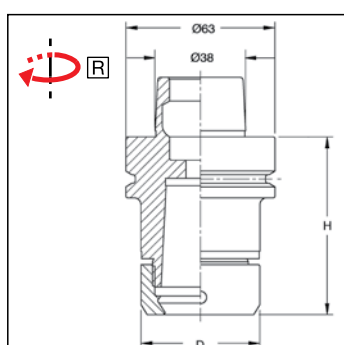

■ Utensili non a magazzino, quantità minima d'ordine: **1 pezzo**.  
Tools not ready in stock minimum order quantity: **1 piece**.

TAGLIO / SEZIONATURA  
SAWING

DIAMANTE  
DIAMOND

FRESATURA  
CUTTING

PANTOGRAFATURA  
ROUTING

FORATURA  
BORING

MANDRINI / ATTACCHI  
CHUCKS & CLAMPING SYSTEM

RICAMBI E LAVORAZIONI SUPP.  
SPARE PARTS & ADD. WORKING

 Mandrini a calettamento termico HSK 63F

 Thermo Schrumpffutter HSK 63F

 Mandrins avec serrage thermique HSK 63F

 Патроны термо HSK 63F



**M938 Thermal shrinking chuck HSK 63F**



Mandrini a dilatazione termica ottenuti da acciaio di elevata qualità • Parti in accoppiamento interamente rettificate • Altissima precisione run-out 0,003-0,01 mm per un perfetto centraggio dell'utensile • Adatti per l'utilizzo di utensili con attacco cilindrico • Utilizzabili su macchine BIESSE - IMA - MASTERWOD - MORBIDELLI - SCM - WEEKE

Shrinking chucks obtained from high quality steel • Parts in connection completely ground • High precision with run-out 0,003-0,01 mm for a perfect alignment of the tool • Use with cylindrical shank router bits • To mount on BIESSE - IMA - MASTERWOOD - MORBIDELLI - SCM - WEEKE machines

● = Ready in stock ■ = Delivery time 20 working days △ = On request

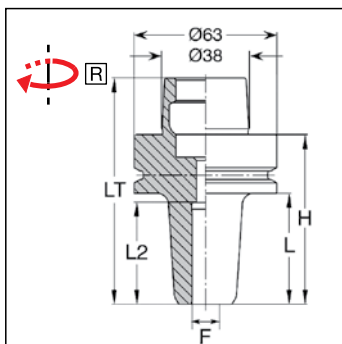

| F  | H  | L2 | L  | LT  | Code           | €      |
|----|----|----|----|-----|----------------|--------|
| 8  | 75 | 38 | 49 | 100 | ■ M9380008063F | 254,00 |
| 10 | 75 | 40 | 49 | 100 | ● M9380010063F | 254,00 |
| 12 | 75 | 45 | 49 | 100 | ● M9380012063F | 254,00 |
| 14 | 75 | 46 | 49 | 100 | ■ M9380014063F | 254,00 |
| 16 | 75 | 50 | 49 | 100 | ■ M9380016063F | 254,00 |
| 20 | 75 | 50 | 49 | 100 | ● M9380020063F | 254,00 |
| 25 | 75 | 55 | 49 | 100 | ● M9380025063F | 254,00 |

Spec. M938099

■ Utensili non a magazzino, quantità minima d'ordine: **1 pezzo**.  
Tools not ready in stock minimum order quantity: **1 piece**.

 Mandrini a calettamento termico HSK 63E

 Thermo Schrumpffutter HSK 63E

 Mandrins avec serrage thermique HSK 63E

 Патроны термо HSK 63E

**M939 Thermal shrinking chuck HSK 63E long**



Mandrini a dilatazione termica ottenuti da acciaio di elevata qualità • Parti in accoppiamento interamente rettificate • Altissima precisione run-out 0,003-0,01 mm per un perfetto centraggio dell'utensile • Adatti per l'utilizzo di utensili con attacco cilindrico • Utilizzabili su macchine BIESSE - IMA - MASTERWOD - MORBIDELLI - SCM - WEEKE

Shrinking chucks obtained from high quality steel • Parts in connection completely ground • High precision with run-out 0,003-0,01 mm for a perfect alignment of the tool • Use with cylindrical shank router bits • To mount on BIESSE - IMA - MASTERWOOD - MORBIDELLI - SCM - WEEKE machines

● = Ready in stock ■ = Delivery time 20 working days △ = On request

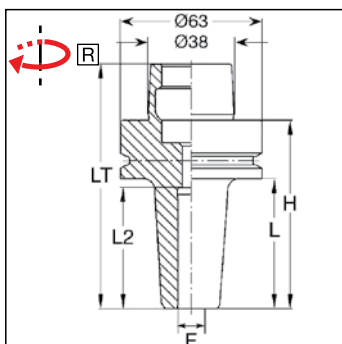

| F  | H  | L2 | L  | LT  | Code           | €      |
|----|----|----|----|-----|----------------|--------|
| 16 | 75 | 50 | 49 | 107 | ■ M9390016063E | 297,00 |
| 20 | 75 | 50 | 49 | 107 | ● M9390020063E | 297,00 |
| 25 | 75 | 55 | 49 | 107 | ● M9390025063E | 297,00 |

Spec. M939099

■ Utensili non a magazzino, quantità minima d'ordine: **1 pezzo**.  
Tools not ready in stock minimum order quantity: **1 piece**.

TAGLIO / SEZIONATURA  
SAWING

DIAMANTE  
DIAMOND

FRESATURA  
CUTTING

PANTOGRAFATURA  
ROUTING

FORATURA  
BORING

MANDRINI / ATTACCHI  
CHUCKS & CLAMPING SYSTEM

RICAMBI E LAVORAZIONI SUPP.  
SPARE PARTS & ADD. WORKING

Mandriini centrici  
ad elevata precisione

Spannzangenfutter

Mandrins concentriques

Высокоточные  
патроны

## M726

## High precision collect chucks



Ottenuti da acciaio di elevata qualità • Parti in accoppiamento interamente rettificate • Altissima precisione con perfetto centraggio dell'utensile • Adatti per l'utilizzo di utensili con attacco cilindrico mediante pinze art. M233 • La pinza non è inclusa nel mandrino • Particolarmente indicati per macchine a CNC

Obtained from high quality steel • Parts in connection completely ground • High precision with perfect alignment of the tool • Use with cylindrical shank router bits • Mount high precision collect art. M233 • High precision collect is not included in the chuck • To mount on CNC machines

● = Ready in stock ■ = Delivery time 20 working days △ = On request

| d     | Code           | €      |
|-------|----------------|--------|
| 20    | ■ M7260R3220AR | 132,00 |
| 25    | ■ M7260R3225AR | 132,00 |
| Spec. | M726099        |        |

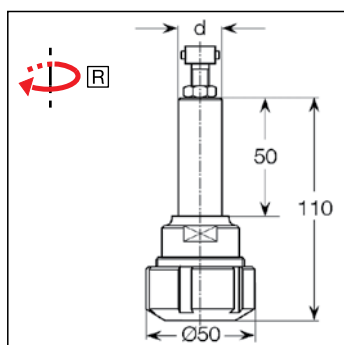

■ Utensili non a magazzino, quantità minima d'ordine: **2 pezzi**.

Tools not ready in stock minimum order quantity: **2 pieces**.

### SPARE PARTS

| Type                      | Code           | €     |
|---------------------------|----------------|-------|
| Retaining bolt            | ■ PTIR         | 26,00 |
| Wrench for ring nut 52-55 | ■ ACH052AAAAAA | 34,00 |

TAGLIO / SEZIONATURA  
SAWING

DIAMANTE  
DIAMOND

FRESATURA  
CUTTING

PANTOGRAFATURA  
ROUTING

FORATURA  
BORING

MANDRINI / ATTACCHI  
CHUCKS & CLAMPING SYSTEM

RICAMBI E LAVORAZIONI SUPP.  
SPARE PARTS & ADD. WORKING



Mandri per  
fresse Lamello®

Aufnahmedorn  
für Lamello® Fräser

Arbre pour scie Lamello®

Оправки для Lamello®

## M788

## Shank for cutters Lamello® cutters



Ottenuti da acciaio di elevata qualità • Parti in accoppiamento interamente rettificate • Altissima precisione per un perfetto centraggio dell'utensile • Da installare su utensili Lamello®

Obtained from high quality steel • Parts in connection completely ground • High precision with perfect alignment of the tool • To mount on Lamello® tools

● = Ready in stock ■ = Delivery time 20 working days △ = On request

| D  | F  | d  | PH      | Code           | €      |
|----|----|----|---------|----------------|--------|
| 53 | 22 | 16 | 4/M4/36 | ● M78800532216 | 100,00 |
| 53 | 22 | 20 | 4/M4/36 | ● M78800532220 | 100,00 |
| 65 | 30 | 16 | 4/M6/48 | ● M78800653016 | 100,00 |
| 65 | 30 | 20 | 4/M6/48 | ● M78800653020 | 100,00 |

**NOTE** ■ Utensili non a magazzino, quantità minima d'ordine: **2 pezzi**.  
Tools not ready in stock minimum order quantity: **2 pieces**.

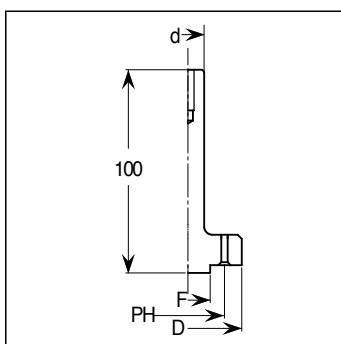

Mandri portalama  
per macchine CNC

Aufnahmedorn für  
Kreissäbblätter auf CNC

Arbre pour montage scie  
(CNC)

Оправки для крепления  
пил

## M790

## Shank for saw blades on CNC



Ottenuti da acciaio di elevata qualità • Parti in accoppiamento interamente rettificate • Altissima precisione per un perfetto centraggio dell'utensile • Da installare su macchine CNC

Obtained from high quality steel • Parts in connection completely ground • High precision with perfect alignment of the tool • To mount on CNC machines

● = Ready in stock ■ = Delivery time 20 working days △ = On request

| D   | F  | d  | PH      | Code           | €      |
|-----|----|----|---------|----------------|--------|
| 68  | 30 | 20 | 4/M5/48 | ● M79000683020 | 130,00 |
| 68  | 30 | 25 | 4/M5/48 | ● M79000683025 | 130,00 |
| 100 | 60 | 20 | 6/M6/80 | ● M79001006020 | 150,00 |
| 100 | 60 | 25 | 6/M6/80 | ● M79001006025 | 150,00 |

**NOTE** ■ Utensili non a magazzino, quantità minima d'ordine: **2 pezzi**.  
Tools not ready in stock minimum order quantity: **2 pieces**.

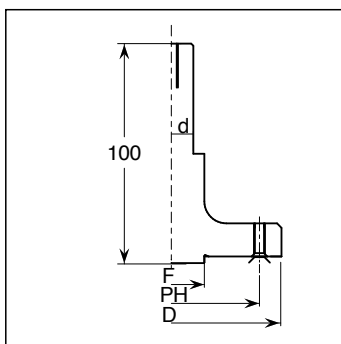

TAGLIO / SEZIONATURA  
SAWING

DIAMANTE  
DIAMOND

FRESATURA  
CUTTING

PANTOGRAFATURA  
ROUTING

FORATURA  
BORING

MANDRINI / ATTACCHI  
CHUCKS & CLAMPING SYSTEM

RICAMBI E LAVORAZIONI SUPP.  
SPARE PARTS & ADD. WORKING



Mandriini portalama  
HSK 63F

Sägeblattaufnahme  
HSK 63F

Arbres porte-lame  
HSK 63F

Оправки для крепления  
пил HSK 63F

## M911

## Saw blade holder HSK 63F



Ottenuti da acciaio di elevata qualità • Parti in accoppiamento interamente rettificate • Altissima precisione per un perfetto centraggio dell'utensile • Utilizzabili su macchine BIESSE, HOMAG, IMA, MASTERWOOD, MORBIDELLI, SCM, WEEKE

Obtained from high quality steel • Parts in connection completely ground • High precision with perfect alignment of the tool • To mount on BIESSE, HOMAG, IMA, MASTERWOOD, MORBIDELLI, SCM, WEEKE machines

● = Ready in stock ■ = Delivery time 20 working days △ = On request

| D     | F  | D1 | H  | LI      |                        | Code          | €      |
|-------|----|----|----|---------|------------------------|---------------|--------|
| 106   | 30 | 63 | 40 | 8/M5/90 | with counter flange    | ■ M9110000010 | 980,00 |
| 106   | 30 | 63 | 40 | 8/M5/90 | without counter flange | ■ M9110000020 | 540,00 |
| 106   | 30 | 63 | 50 | 8/M5/90 | with counter flange    | ■ M9110000030 | 998,00 |
| 106   | 30 | 63 | 50 | 8/M5/90 | without counter flange | ■ M9110000040 | 566,00 |
| Spec. |    |    |    |         |                        | M911099       |        |

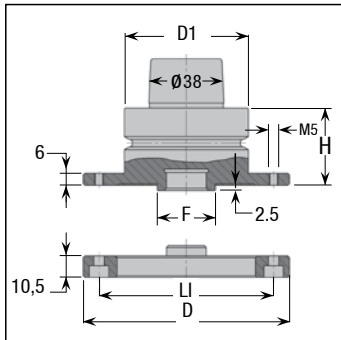

■ Utensili non a magazzino, quantità minima d'ordine: **1 pezzo**.

Tools not ready in stock minimum order quantity: **1 piece**.

Flange portalama

Aufnahmeflansch

Flaques porte-lames

Оправки для крепления пил

## M960

## Clamping flanges for saw blades

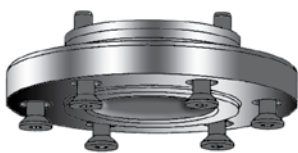

Ottenuti da acciaio di elevata qualità • Parti in accoppiamento interamente rettificate • Altissima precisione per un perfetto centraggio dell'utensile • Utilizzabili su macchine BIESSE, HOMAG, IMA, MASTERWOOD, MORBIDELLI, SCM, WEEKE

Obtained from high quality steel • Parts in connection completely ground • High precision with perfect alignment of the tool • To mount on BIESSE, HOMAG, IMA, MASTERWOOD, MORBIDELLI, SCM, WEEKE machines

● = Ready in stock ■ = Delivery time 20 working days △ = On request

| D      | H  | F  | D2 | d  | LI | L   | Code          | €      |
|--------|----|----|----|----|----|-----|---------------|--------|
| Set    |    |    |    |    |    |     |               |        |
| 100    | 30 | 30 | -  | 60 | 80 | 2.2 | ■ M9600000010 | 426,60 |
| 100    | 45 | 30 | -  | 60 | 80 | 2.2 | ■ M9600000020 | 436,80 |
| 100    | 70 | 30 | -  | 60 | 80 | 2.2 | ■ M9600000030 | 450,40 |
| Rings  |    |    |    |    |    |     |               |        |
| -      | 30 | 30 | 60 | -  | -  | -   | ■ M9600000040 | 180,20 |
| -      | 45 | 30 | 60 | -  | -  | -   | ■ M9600000050 | 192,20 |
| -      | 70 | 30 | 60 | -  | -  | -   | ■ M9600000060 | 204,00 |
| Flange |    |    |    |    |    |     |               |        |
| 100    | -  | 30 | -  | 60 | 80 | 2.2 | ■ M9600000070 | 244,80 |

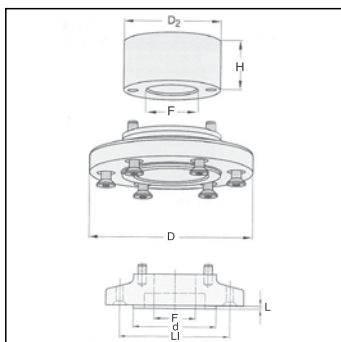

■ Utensili non a magazzino, quantità minima d'ordine: **1 pezzo**.

Tools not ready in stock minimum order quantity: **1 piece**.

TAGLIO / SEZIONATURA  
SAWING

DIAMANTE  
DIAMOND

FRESATURA  
CUTTING

PANTOGRAFATURA  
ROUTING

FORATURA  
BORING

MANDRINI / ATTACCHI  
CHUCKS & CLAMPING SYSTEM

RICAMBI E LAVORAZIONI SUPP.  
SPARE PARTS & ADD. WORKING

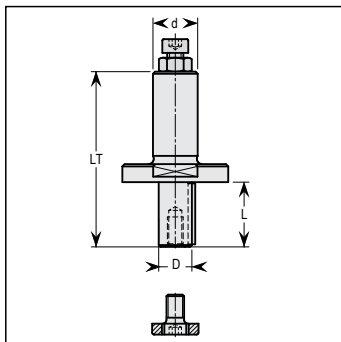
**M910****CNC Arbor**

■ Utensili non a magazzino, quantità minima d'ordine: **1 pezzo**.  
Tools not ready in stock minimum order quantity: **1 piece**.

Ottenuti da acciaio di elevata qualità • Parti in accoppiamento interamente rettificate • Altissima precisione per un perfetto centraggio dell'utensile • Da installare su macchine CNC

Obtained from high quality steel • Parts in connection completely ground • High precision with perfect alignment of the tool • To mount on CNC machines

● = Ready in stock ■ = Delivery time 20 working days △ = On request

| D  | L  | LT  | KN*   | d     | Code           | €             |
|----|----|-----|-------|-------|----------------|---------------|
| 20 | 40 | 105 | 6X1,5 | 25X55 | ■ M91000204061 | <b>252,60</b> |
| 30 | 40 | 105 | 8X2   | 25X55 | ■ M91000304061 | <b>214,60</b> |

|       |  |  |  |  |         |  |
|-------|--|--|--|--|---------|--|
| Spec. |  |  |  |  | M910099 |  |
|-------|--|--|--|--|---------|--|

\* KN – Chiavetta anti rotazione  
\* KN – Rotation limiter key

## SPARE PARTS

| Type            | Dimensions                     | Code           | €            |
|-----------------|--------------------------------|----------------|--------------|
| Retaining screw | M10 (for d = 20 mm)            | ■ WV082        | <b>15,00</b> |
| Retaining screw | M16 (for d = 30 mm)            | ■ WV083        | <b>28,00</b> |
| Retaining screw | M16 with collar (for d = 30mm) | ■ WV084        | <b>28,00</b> |
| Adjusting screw | M8                             | ■ WV048        | <b>2,00</b>  |
| "T" allen key   | 5                              | ■ ACHET05AAAAA | <b>9,20</b>  |
| "T" allen key   | 6                              | ■ ACHET06AAAAA | <b>10,20</b> |
| "T" allen key   | 10                             | ■ ACHET10AAAAA | <b>10,20</b> |

**M915****Tool holder with Arbor HSK 63F**

Ottenuti da acciaio di elevata qualità • Parti in accoppiamento interamente rettificate • Altissima precisione con perfetto centraggio dell'utensile • Utilizzabili sulle macchine BIESSE – IMA – MASTERWOOD – MORBIDELLI – SCM – WEEKE

Obtained from high quality steel • Parts in connection completely ground • High precision with perfect alignment of the tool • To mount on IMA - MASTERWOOD - MORBIDELLI - SCM - WEEKE machines

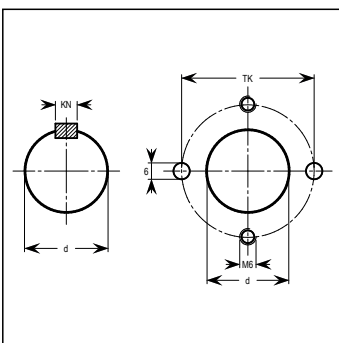
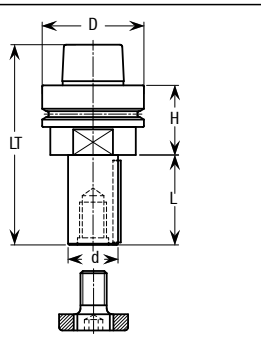

## ARBOR WITH KN\*

● = Ready in stock ■ = Delivery time 20 working days △ = On request

| d  | D  | L   | H  | LT  | KN*   | Code           | €             |
|----|----|-----|----|-----|-------|----------------|---------------|
| 20 | 63 | 40  | 45 | 110 | 6X1,5 | ■ M91500204131 | <b>572,60</b> |
| 20 | 63 | 55  | 45 | 125 | 6X1,5 | ■ M91500205131 | <b>579,20</b> |
| 20 | 63 | 55  | 80 | 160 | 6X1,5 | ■ M91500205531 | <b>590,80</b> |
| 20 | 63 | 70  | 45 | 140 | 6X1,5 | ■ M91500207131 | <b>597,40</b> |
| 20 | 63 | 70  | 80 | 175 | 6X1,5 | ■ M91500207031 | <b>597,40</b> |
| 30 | 63 | 40  | 45 | 110 | 8X2   | ■ M91500304131 | <b>589,20</b> |
| 30 | 63 | 55  | 45 | 125 | 8X2   | ■ M91500305531 | <b>587,40</b> |
| 30 | 63 | 80  | 45 | 150 | 8X2   | ■ M91500308131 | <b>594,00</b> |
| 30 | 63 | 80  | 80 | 185 | 8X2   | ■ M91500308031 | <b>615,60</b> |
| 30 | 63 | 163 | 52 | 240 | 8X2   | ■ M91500301631 | <b>671,60</b> |
| 30 | 63 | 189 | 52 | 266 | 8X2   | ■ M91500301891 | <b>711,60</b> |

## ARBOR WITH SCREW

| d  | D  | L   | H  | LT  | Screw     | Code           | €             |
|----|----|-----|----|-----|-----------|----------------|---------------|
| 30 | 63 | 40  | 45 | 110 | 2/M6+2/48 | ■ M91500304132 | <b>590,80</b> |
| 30 | 63 | 55  | 45 | 125 | 2/M6+2/48 | ■ M91500305532 | <b>607,20</b> |
| 30 | 63 | 80  | 45 | 150 | 2/M6+2/48 | ■ M91500308132 | <b>594,00</b> |
| 30 | 63 | 80  | 80 | 185 | 2/M6+2/48 | ■ M91500308232 | <b>615,60</b> |
| 30 | 63 | 120 | 45 | 190 | 2/M6+2/48 | ■ M91500312032 | <b>633,60</b> |

Spec.

M915099

■ Utensili non a magazzino, quantità minima d'ordine: **1 pezzo**.  
Tools not ready in stock minimum order quantity: **1 piece**.

## SPARE PARTS

| Type              |                     | Code           | €            |
|-------------------|---------------------|----------------|--------------|
| Retaining screw   | M10 (for d = 20 mm) | ■ WV082        | <b>22,30</b> |
| Retaining screw   | M16 (for d = 30 mm) | ■ WV083        | <b>40,00</b> |
| Engineers' wrench | SW 46               | ■ ACH010AAAAAA | <b>66,00</b> |
| "T" allen key     | Esag. 6             | ■ ACHET06AAAA  | <b>10,20</b> |
| "T" allen key     | Esag. 10            | ■ ACHET10AAAA  | <b>10,20</b> |

\* KN – Chiavetta anti rotazione

\* KN – Rotation limiter key

 Ghiera per mandrini portapinze

 Spannmutter

 Ecrin de serrage

 Гайка для патронов



TAGLIO / SEZIONATURA  
SAWING

DIAMANTE  
DIAMOND

FRESATURA  
CUTTING

PANTOGRAFATURA  
ROUTING

FORATURA  
BORING

MANDRINI / ATTACCHI  
CHUCKS & CLAMPING SYSTEM

RICAMBI E LAVORAZIONI SUPP.  
SPARE PARTS & ADD. WORKING

## M730 Lock nuts for collect chucks



Ottenute da acciaio di elevata resistenza meccanica

Obtained from steel with a high mechanical resistance

● = Ready in stock ■ = Delivery time 20 working days △ = On request

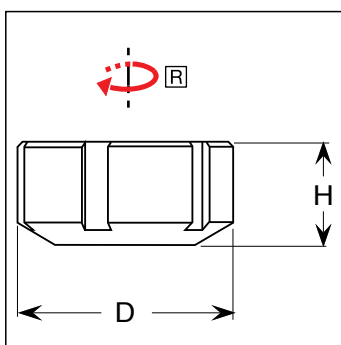

| H.P. Collets | D  | H    | Left Code      | Right Code     | €     |
|--------------|----|------|----------------|----------------|-------|
| ER25         | 42 | 20   | ■ M7300ER25AAL | ● M7300ER25AAR | 18,60 |
| ER32         | 50 | 22,5 | ■ M7300ER32AAL | ● M7300ER32AAR | 13,20 |
| ER32ETS      | 50 | 22,5 | ■ M7300ER32ETL | ● M7300ER32ETR | 13,20 |
| ER40         | 63 | 25,5 | ■ M7300ER40AAL | ● M7300ER40AAR | 18,20 |
| ER40ETS      | 63 | 25,5 | ■ M7300ER40ETL | ● M7300ER40ETR | 18,20 |
| ORT25        | 60 | 30   | ■ M7300RT25AAL | ● M7300RT25AAR | 45,40 |
| Spec.        |    |      | M730099L       | M730099R       |       |

■ Utensili non a magazzino, quantità minima d'ordine: **2 pezzi.**  
Tools not ready in stock minimum order quantity: **2 pieces.**

 Ghiera a cuscinetto per mandrini portapinze

 Spannmutter

 Ecrin de serrage avec roulement à billes

 Гайка для патронов

## M735 Anti-unscrewing lock nuts for collect chucks



Ottenute da acciaio di elevata resistenza meccanica

Obtained from steel with a high mechanical resistance

● = Ready in stock ■ = Delivery time 20 working days △ = On request

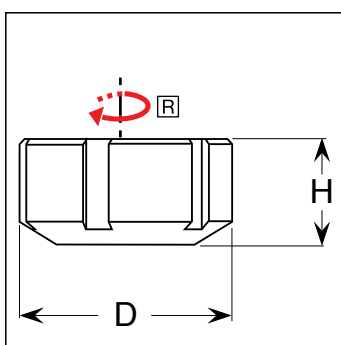

| H.P. Collets | D  | H    | Left Code      | Right Code     | €     |
|--------------|----|------|----------------|----------------|-------|
| ER32         | 50 | 22,5 | ■ M7350ER32AAL | ● M7350ER32AAR | 52,60 |
| ER40         | 63 | 25,5 | ■ M7350ER40AAL | ● M7350ER40AAR | 62,20 |
| ORT25        | 60 | 30   | ■ M7350RT25AAL | ● M7350RT25AAR | 64,80 |
| Spec.        |    |      | M735099L       | M735099R       |       |

■ Utensili non a magazzino, quantità minima d'ordine: **2 pezzi.**  
Tools not ready in stock minimum order quantity: **2 pieces.**



Ghiere per mandrini portafrese



Spannmutter



Ecru de serrage



Гайка для патронов

# M740

## Lock nuts for collect chucks

TAGLIO / SEZIONATURA  
SAWING



Ottenute da acciaio di elevata resistenza meccanica

Obtained from steel with a high mechanical resistance

DIAMANTE  
DIAMOND

● = Ready in stock ■ = Delivery time 20 working days △ = On request

FRESATURA  
CUTTING

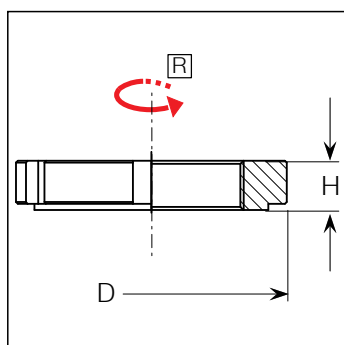

| D     | H | Left Code      | Right Code     | €     |
|-------|---|----------------|----------------|-------|
| 44    | 8 | ■ M74004408AAL | ● M74004408AAR | 50,40 |
| Spec. |   | M740099L       | M740099R       |       |

**NOTE** ■ Utensili non a magazzino, quantità minima d'ordine: **10 pezzi.**  
Tools not ready in stock minimum order quantity: **10 pieces.**

PANTOGRAFATURA  
ROUTING

FORATURA  
BORING

MANDRINI / ATTACCHI  
CHUCKS & CLAMPING SYSTEM

RICAMBI E LAVORAZIONI SUPP.  
SPARE PARTS & ADD. WORKING

Mandriini portafrese  
SK30 DIN69871

Fräsdorn  
SK30 DIN69871

Mandrins porte-fraise  
SK30 DIN69871

Патроны для фрез  
SK30 DIN69871

## M750

### Tool holder with arbor SK30 DIN69871



Ottenute da acciaio di elevata qualità • Parti in accoppiamento interamente rettificata • Altissima precisione per un perfetto centraggio dell'utensile • Utilizzabili su macchine BIESSE

Obtained from high quality steel • Parts in connection completely ground • High precision with perfect alignment of the tool • To mount on BIESSE machines

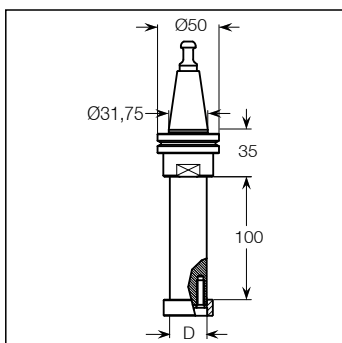

● = Ready in stock ■ = Delivery time 20 working days △ = On request

| D     | Code           | €      |
|-------|----------------|--------|
| 30    | ● M750030100AA | 208,00 |
| Spec. | M750099        |        |

#### SPARE PARTS

| Type                  | Code           | €     |
|-----------------------|----------------|-------|
| Retaining bolt Biesse | ■ M8000AAAAA3  | 28,00 |
| Key for cap screw     | ● ACHET05AAAAA | 9,20  |
| Screw                 | ■ WV066        | 2,40  |

**NOTE** ■ Utensili non a magazzino, quantità minima d'ordine: **2 pezzi**.  
Tools not ready in stock minimum order quantity: **2 pieces**.

Mandriini porta frese  
SK30

Fräsdorn  
SK30

Mandrins porte-fraise  
SK30

Патроны для фрез  
SK30

## M751

### Tool holder with arbor SK30



Ottenuti da acciaio di elevata qualità • Parti in accoppiamento interamente rettificata • Altissima precisione per un perfetto centraggio dell'utensile • Utilizzabili su macchine CMS

Obtained from high quality steel • Parts in connection completely ground • High precision with perfect alignment of the tool • To mount on CMS machines

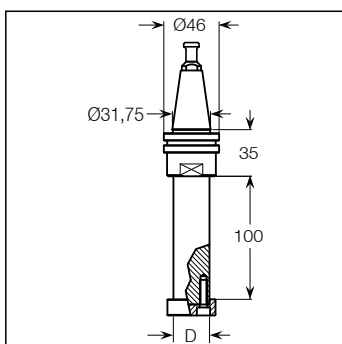

● = Ready in stock ■ = Delivery time 20 working days △ = On request

| D     | Code           | €      |
|-------|----------------|--------|
| 30    | ● M751030100AA | 208,00 |
| Spec. | M751099        |        |

#### SPARE PARTS

| Type               | Code           | €     |
|--------------------|----------------|-------|
| Retaining bolt CMS | ■ M8000AAAAA9  | 28,00 |
| Key for cap screw  | ● ACHET05AAAAA | 9,20  |
| Screw              | ■ WV066        | 2,40  |

**NOTE** ■ Utensili non a magazzino, quantità minima d'ordine: **2 pezzi**.  
Tools not ready in stock minimum order quantity: **2 pieces**.

Mandriini portafrese  
SK30

Fräsdorn  
SK30

Mandrins porte-fraise  
SK30

Патроны для фрез  
SK30

## M752

### Tool holder with arbor SK30



Ottenuti da acciaio di elevata qualità • Parti in accoppiamento interamente rettificate • Altissima precisione per un perfetto centraggio dell'utensile • Utilizzabili su macchine ESSETEAM

Obtained from high quality steel • Parts in connection completely ground • High precision with perfect alignment of the tool • To mount on ESSETEAM machines

● = Ready in stock ■ = Delivery time 20 working days △ = On request

| D  | Code           | €      |
|----|----------------|--------|
| 30 | ■ M752030100AA | 208,00 |

Spec. M752099

■ Utensili non a magazzino, quantità minima d'ordine: **1 pezzo.**  
Tools not ready in stock minimum order quantity: **1 piece.**

#### SPARE PARTS

| Type                    | Code           | €     |
|-------------------------|----------------|-------|
| Retaining bolt Esseteam | ■ M8000AAAAAA9 | 28,00 |
| Key for cap screw       | ■ ACHET05AAAAA | 9,20  |
| Screw                   | ■ WV066        | 2,40  |

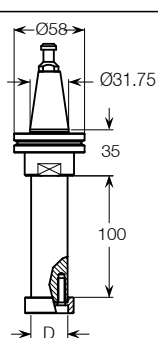

Mandriini portafrese  
SK30 con flangia dentata

Fräsdorn  
SK30

Mandrins porte-fraise  
SK30 cranté

Патроны для фрез  
SK30

## M755

### Tool holder with arbor SK30



Ottenuti da acciaio di elevata qualità • Parti in accoppiamento interamente rettificate • Altissima precisione per un perfetto centraggio dell'utensile • Utilizzabili su macchine MORBIDELLI e SCM

Obtained from high quality steel • Parts in connection completely ground • High precision with perfect alignment of the tool • To mount on MORBIDELLI - SCM machines

● = Ready in stock ■ = Delivery time 20 working days △ = On request

| D  | Code           | €      |
|----|----------------|--------|
| 30 | ■ M755030100AA | 249,60 |

Spec. M755099

■ Utensili non a magazzino, quantità minima d'ordine: **1 pezzo.**  
Tools not ready in stock minimum order quantity: **1 piece.**

#### SPARE PARTS

| Type                          | Code           | €     |
|-------------------------------|----------------|-------|
| Retaining bolt MORBIDELLI-SCM | ■ M8000AAAAAA1 | 28,00 |
| Key for cap screw             | ● ACHET05AAAAA | 9,20  |
| Screw                         | ■ WV066        | 2,40  |

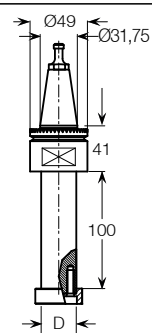

TAGLIO / SEZIONATURA  
SAWING

DIAMANTE  
DIAMOND

FRESATURA  
CUTTING

PANTOGRAFATURA  
ROUTING

FORATURA  
BORING

MANDRINI / ATTACCHI  
CHUCKS & CLAMPING SYSTEM

RICAMBI E LAVORAZIONI SUPP.  
SPARE PARTS & ADD. WORKING



Mandriini portafrese  
SK40 DIN69871

Fräsdorn  
SK40 DIN69871

Mandriins porte-fraise  
SK40 DIN69871

Патроны для фрез  
SK40 DIN69871

## M757

### Tool holder with arbor SK40 DIN69871



Ottenuti da acciaio di elevata qualità • Parti in accoppiamento interamente rettificata • Altissima precisione per un perfetto centraggio dell'utensile • Utilizzabili su macchine IMA – MAKA – REICHENBACHER – SCM – STEGHER – WEEKE

Obtained from high quality steel • Parts in connection completely ground • High precision with perfect alignment of the tool • To mount on IMA - MAKA - REICHENBACHER - SCM - STEGHER - WEEKE machines

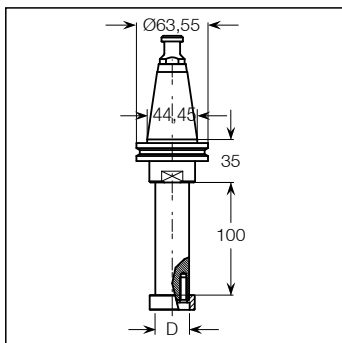

● = Ready in stock ■ = Delivery time 20 working days △ = On request

| D     | Code           | €      |
|-------|----------------|--------|
| 30    | ● M757030100AA | 277,20 |
| 35    | ■ M757035100AA | 277,20 |
| 40    | ■ M757040100AA | 277,20 |
| Spec. | M757099        |        |

#### SPARE PARTS

| Type                                      | Code           | €     |
|---|----------------|-------|
| Retaining bolt IMA – MAKA – REICHENBACHER | ■ M8000AAAAA8  | 38,00 |
| Key for cap screw                         | ● ACHET05AAAAA | 9,20  |
| Screw                                     | ■ WV066        | 2,40  |

■ Utensili non a magazzino, quantità minima d'ordine: **1 pezzo.**

*Tools not ready in stock minimum order quantity: 1 piece.*

Mandriini portafrese  
ER40

Fräsdorn  
ER40

Mandriins porte-fraise  
ER40

Патроны для фрез  
ER40

## M759

### Tool holder with arbor ER40



Ottenuti da acciaio di elevata qualità • Parti in accoppiamento interamente rettificata • Altissima precisione per un perfetto centraggio dell'utensile • Utilizzabili su macchine BACCI

Obtained from high quality steel • Parts in connection completely ground • High precision with perfect alignment of the tool • To mount on BACCI machines

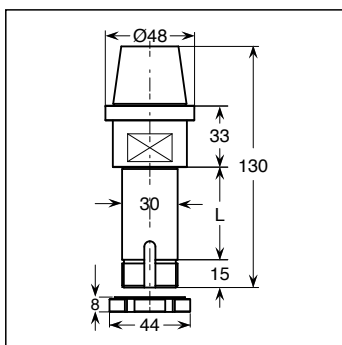

● = Ready in stock ■ = Delivery time 20 working days △ = On request

| D     | D1 | H  | Left Code      | Right Code     | €      |
|-------|----|----|----------------|----------------|--------|
| 30    | 44 | 50 | ■ M759030050AL | ■ M759030050AR | 809,00 |
| Spec. |    |    | M759099L       | M759099R       |        |

■ Utensili non a magazzino, quantità minima d'ordine: **1 pezzo.**  
*Tools not ready in stock minimum order quantity: 1 piece.*

#### SPARE PARTS

| Type                   | Left Code      | Right Code     | €     |
|------------------------|----------------|----------------|-------|
| Lock nut for spindle   | ■ M74004408AAL | ■ M74004408AAR | 44,00 |
| Key for lock nut 40/42 |                | ■ ACH040AAAAAA | 30,00 |

■ Utensili non a magazzino, quantità minima d'ordine: **1 pezzo.**

*Tools not ready in stock minimum order quantity: 1 piece.*

Mandriini portafrese  
HSK 63F DIN69893

Fräsdorn  
HSK 63F DIN69893

Mandrins porte-fraise  
HSK 63F DIN69893

Патроны ГИДРО для фрез  
HSK63F DIN69893

## M760

### Tool holder with arbor HSK 63F DIN69893



Ottenuti da acciaio di elevata qualità • Parti in accoppiamento interamente rettificata • Altissima precisione con perfetto centraggio dell'utensile • Utilizzabili sulle macchine BIESSE – IMA – MASTERWOOD – MORBIDELLI – SCM – WEEKE

Obtained from high quality steel • Parts in connection completely ground • High precision with perfect alignment of the tool • To mount on IMA - MASTERWOOD - MORBIDELLI - SCM - WEEKE machines

● = Ready in stock ■ = Delivery time 20 working days △ = On request

| D     | H  | Code           | €      |
|-------|----|----------------|--------|
| 30    | 33 | ● M7600030033A | 138,60 |
| 30    | 42 | ■ M7600030042A | 138,60 |
| 35    | 33 | ● M7600035033A | 138,60 |
| 35    | 42 | ● M7600035042A | 138,60 |
| 40    | 33 | ● M7600040033A | 138,60 |
| 40    | 42 | ■ M7600040042A | 138,60 |
| Spec. |    | M760099        |        |

#### SPARE PARTS

| Type                  | Code           | €    |
|-----------------------|----------------|------|
| T allen Key for hydro | ● ACHET05AAAAA | 9,20 |
| Screw                 | ● WV066        | 2,40 |

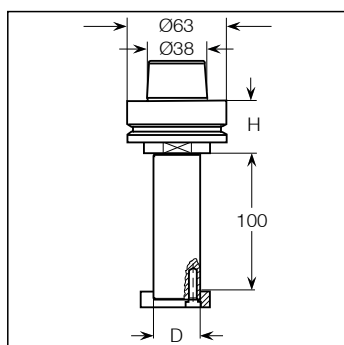

■ Utensili non a magazzino, quantità minima d'ordine: **1 pezzo**.  
Tools not ready in stock minimum order quantity: **1 piece**.

Mandriini portafrese  
HSK 63E DIN69893

Fräsdorn  
HSK 63E DIN69893

Mandrins porte-fraise  
HSK 63E DIN69893

Патроны для фрез  
HSK 63E DIN69893

## M762

### Tool holder with arbor HSK 63E DIN69893



Ottenuti da acciaio di elevata qualità • Parti in accoppiamento interamente rettificata • Altissima precisione per un perfetto centraggio dell'utensile • Utilizzabili su macchine CMS

Obtained from high quality steel • Parts in connection completely ground • High precision with perfect alignment of the tool • To mount on CMS machines

● = Ready in stock ■ = Delivery time 20 working days △ = On request

| D     | Code           | €      |
|-------|----------------|--------|
| 30    | ● M762030100AA | 138,60 |
| 35    | ● M762035100AA | 138,60 |
| 40    | ● M762040100AA | 138,60 |
| Spec. | M762099        |        |

#### SPARE PARTS

| Type                  | Code           | €    |
|-----------------------|----------------|------|
| T allen Key for hydro | ● ACHET05AAAAA | 9,20 |
| Screw                 | ● WV066        | 2,40 |

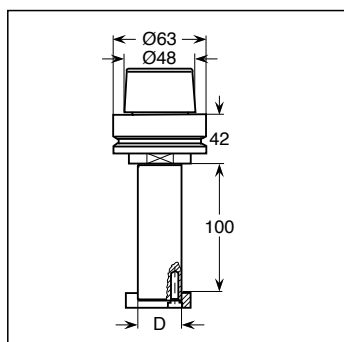

TAGLIO / SEZIONATURA  
SAWING

DIAMANTE  
DIAMOND

FRESATURA  
CUTTING

PANTOGRAFATURA  
ROUTING

FORATURA  
BORING

MANDRINI / ATTACCHI  
CHUCKS & CLAMPING SYSTEM

RICAMBI E LAVORAZIONI SUPP.  
SPARE PARTS & ADD. WORKING

Mandri portafrese  
HSK 85 POWER LOCK

Fräsdorn  
HSK 85 POWER LOCK

Arbres porte-fraise hydro  
HSK 85 POWER LOCK

Патроны для фрез  
HSK85 POWER LOCK

**M765**

**POWER LOCK**

**Tool holder with arbor HSK 85**

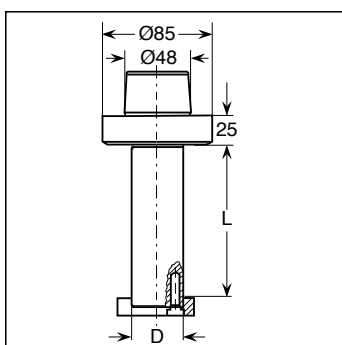

Ottenuti da acciaio di elevata qualità • Parti in accoppiamento interamente rettificate • Altissima precisione per un perfetto centraggio dell'utensile • Utilizzabili sulle macchine WEINIG ed SCM

Obtained from high quality steel • Parts in connection completely ground • High precision with perfect alignment of the tool • To mount on WEINIG and SCM machines

● = Ready in stock ■ = Delivery time 20 working days △ = On request

| D  | L   | Code           | €      |
|----|-----|----------------|--------|
| 30 | 100 | ■ M765030100AA | 363,00 |
| 30 | 130 | ■ M765030130AA | 330,00 |
| 30 | 150 | ■ M765030150AA | 462,00 |
| 30 | 200 | ● M765030200AA | 561,00 |
| 35 | 100 | ■ M765035100AA | 363,00 |
| 35 | 150 | ■ M765035150AA | 462,00 |
| 35 | 200 | ■ M765035200AA | 561,00 |
| 40 | 100 | ■ M765040100AA | 363,00 |
| 40 | 150 | ● M765040150AA | 462,00 |
| 40 | 200 | ■ M765040200AA | 561,00 |
| 40 | 240 | ● M765040240AA | 650,00 |

Spec. M765099

SPARE PARTS

| Type              | Code           | €    |
|-------------------|----------------|------|
| Key for cap screw | ● ACHET05AAAAA | 9,20 |
| Screw             | ● WV066        | 2,40 |

**NOTE** ■ Utensili non a magazzino, quantità minima d'ordine: **1 pezzo.**  
Tools not ready in stock minimum order quantity: **1 piece.**

TAGLIO / SEZIONATURA  
SAWING

DIAMANTE  
DIAMOND

FRESATURA  
CUTTING

PANTOGRAFATURA  
ROUTING

FORATURA  
BORING

MANDRINI / ATTACCHI  
CHUCKS & CLAMPING SYSTEM

RICAMBI E LAVORAZIONI SUPP.  
SPARE PARTS & ADD. WORKING



Mandriini portafrese  
HSK 85 POWER LOCK

Aufnahmedorn  
HSK 85 POWER LOCK

Arbres porte-fraise hydro  
HSK 85 POWER LOCK

Патроны для фрез  
HSK 85 POWER LOCK

**M768**

**POWER LOCK**

**Tool holder with arbor HSK 85**



Ottenuti da acciaio di elevata qualità • Parti in accoppiamento interamente rettificata • Altissima precisione per un perfetto centraggio dell'utensile • Utilizzabili sulle macchine WEINIG ed SCM

Obtained from high quality steel • Parts in connection completely ground • High precision with perfect alignment of the tool • To mount on WEINIG and SCM machines

● = Ready in stock ■ = Delivery time 20 working days △ = On request

| D  | L   | Code           | €             |
|----|-----|----------------|---------------|
| 40 | 130 | ■ M768040130AA | <b>630,00</b> |
| 40 | 170 | ■ M768040170AA | <b>690,00</b> |
| 40 | 240 | ■ M768040240AA | <b>810,00</b> |
| 50 | 170 | ■ M768050170AA | <b>720,00</b> |
| 50 | 240 | ■ M768050240AA | <b>870,00</b> |

Spec. M768099

■ Utensili non a magazzino, quantità minima d'ordine: **1 pezzo.**  
Tools not ready in stock minimum order quantity: **1 piece.**

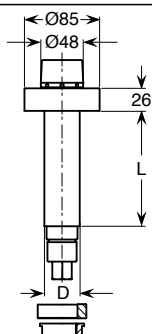

TAGLIO / SEZIONATURA  
SAWING

DIAMANTE  
DIAMOND

FRESATURA  
CUTTING

PANTOGRAFATURA  
ROUTING

FORATURA  
BORING

MANDRINI / ATTACCHI  
CHUCKS & CLAMPING SYSTEM

RICAMBI E LAVORAZIONI SUPP.  
SPARE PARTS & ADD. WORKING

Mandriini portapunte  
Hydro HSK 63F

Spannfutter  
Hydro HSK 63F

Mandriini  
Hydro HSK 63F

Патроны ГИДРО для фрез  
HSK 63F

**M774**

**Hydro chucks HSK 63F**



Ottenuti da acciaio di elevata qualità • Parti in accoppiamento interamente rettificata • Altissima precisione per un perfetto centraggio dell'utensile

Obtained from high quality steel • Parts in connection completely ground • High precision with perfect alignment of the tool

● = Ready in stock ■ = Delivery time 20 working days △ = On request

| F  | D  | H    | Code           | €             |
|----|----|------|----------------|---------------|
| 12 | 45 | 68   | ■ M7740125565A | <b>789,40</b> |
| 16 | 48 | 74   | ■ M7740165874A | <b>789,40</b> |
| 20 | 52 | 80   | ■ M7740206380A | <b>789,40</b> |
| 25 | 59 | 87,5 | ■ M7740256787A | <b>789,40</b> |

Spec. M774099

SPARE PARTS

| Type                  | Code           | €           |
|-----------------------|----------------|-------------|
| T allen Key for hydro | ● ACHET05AAAAA | <b>9,20</b> |

■ Utensili non a magazzino, quantità minima d'ordine: **1 pezzo.**  
Tools not ready in stock minimum order quantity: **1 piece.**

Mandriini portafrese  
Hydro HSK 63F

Hydro Fräsdorn  
HSK 63F

Mandrins porte-frase  
hydro HSK 63F

Патроны ГИДРО для фрез  
HSK 63F

## M784

## Hydro tool holder with arbor HSK 63F



Ottenuti da acciaio di elevata qualità • Parti in accoppiamento interamente rettificate • Altissima precisione per un perfetto centraggio dell'utensile

Obtained from high quality steel • Parts in connection completely ground • High precision with perfect alignment of the tool

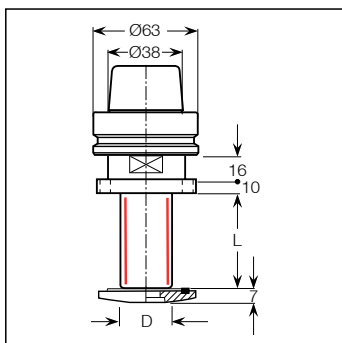

■ Utensili non a magazzino, quantità minima d'ordine: **1 pezzo**.  
Tools not ready in stock minimum order quantity: **1 piece**.

● = Ready in stock ■ = Delivery time 20 working days △ = On request

| D     | L   | Code           | €        |
|-------|-----|----------------|----------|
| 20    | 40  | ■ M7840020040A | 1.171,60 |
| 25    | 55  | ■ M7840025055A | 1.185,80 |
| 30    | 40  | ■ M7840030040A | 1.171,60 |
| 30    | 55  | ■ M7840030055A | 1.185,80 |
| 30    | 80  | ■ M7840030080A | 1.260,00 |
| 30    | 100 | ● M7840030100A | 1.317,20 |
| Spec. |     | M784099        |          |

### SPARE PARTS

| Type                  | Code           | €     |
|-----------------------|----------------|-------|
| T allen Key for hydro | ■ ACHET06HAAAA | 38,80 |

Mandriini portafrese  
Hydro HSK 85 POWER LOCK

Hydro Fräsdorn  
HSK 85 POWER LOCK

Mandrins porte-frase hydro  
HSK 85 POWER LOCK

Патроны для фрез  
HSK 85 POWER LOCK

## M786

**POWER LOCK**

## Hydro tool holder with arbor HSK 85



Ottenuti da acciaio di elevata qualità • Parti in accoppiamento interamente rettificate • Altissima precisione per un perfetto centraggio dell'utensile • Da installare su macchine WEINIG ed SCM.

Obtained from high quality steel • Parts in connection completely ground • High precision with perfect alignment of the tool • To mount on WEINIG and SCM machines

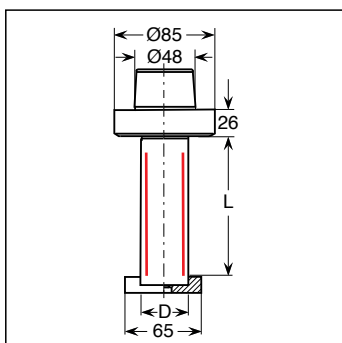

■ Utensili non a magazzino, quantità minima d'ordine: **1 pezzo**.  
Tools not ready in stock minimum order quantity: **1 piece**.

● = Ready in stock ■ = Delivery time 20 working days △ = On request

| D     | L   | Code           | €        |
|-------|-----|----------------|----------|
| 30    | 55  | ■ M7860030055A | 1.025,80 |
| 30    | 100 | ■ M7860030100A | 1.214,40 |
| 40    | 55  | ■ M7860040055A | 1.025,80 |
| 40    | 135 | ■ M7860040135A | 1.214,40 |
| 40    | 240 | ■ M7860040240A | 1.583,00 |
| Spec. |     | M786099        |          |

### SPARE PARTS

| Type                  | L       | Code           | €     |
|-----------------------|---------|----------------|-------|
| T allen key for hydro | 55      | ● ACHET05HAAAA | 38,80 |
| T allen key for hydro | 135-240 | ● ACHET08HAAAA | 64,80 |



 Tiranti per attacchi portafrese e portapinzze

 Einzugsbolzen für Spannutter

 Tirettes de préhension

 Штрєвели для патрона

TAGLIO / SEZIONATURA  
SAWING

DIAMANTE  
DIAMOND

FRESATURA  
CUTTING

PANTOGRAFATURA  
ROUTING

FORATURA  
BORING

MANDRINI / ATTACCHI  
CHUCKS & CLAMPING SYSTEM

RICAMBI E LAVORAZIONI SUPP.  
SPARE PARTS & ADD. WORKING

# M800

## Retaining bolt for high precision chucks

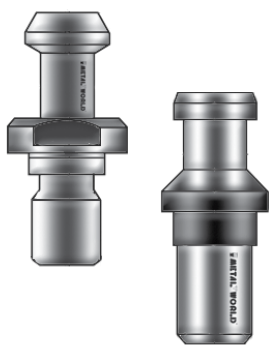

Ottenuti da acciaio di elevata resistenza meccanica

Obtained from steel with a high mechanical resistance

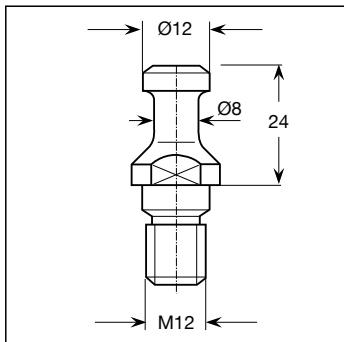
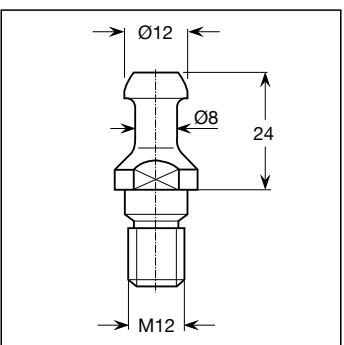
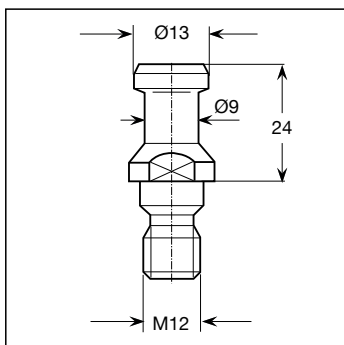
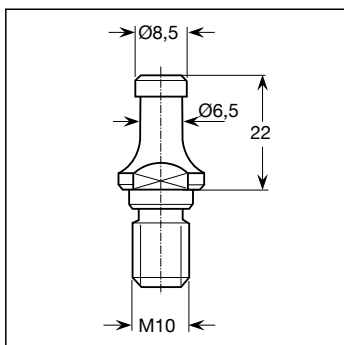

● = Ready in stock   ■ = Delivery time 20 working days   △ = On request

| Machines                         | Code           | €     |
|----------------------------------|----------------|-------|
| MORBIDELLI – SCM per / for ISO30 | ● M8000AAAAAA1 | 19,80 |

| Machines   | Code           | €     |
|--|----------------|-------|
| IMA – MAK – REICHENBACHER – WEEKE – CMS – BULLERI – BUSELLATO – COSMEC – COLOMBO per / for ISO30 | ● M8000AAAAAA2 | 19,80 |

| Machines               | Code           | €     |
|------------------------|----------------|-------|
| BIESSE per / for ISO30 | ● M8000AAAAAA3 | 19,80 |

| Machines               | Code           | €     |
|------------------------|----------------|-------|
| BIESSE per / for ISO30 | ● M8000AAAAAA4 | 19,80 |

**NOTE** ■ Utensili non a magazzino, quantità minima d'ordine: **10 pezzi**.  
Tools not ready in stock minimum order quantity: **10 pieces**.



# M800

## Retaining bolt for high precision chucks

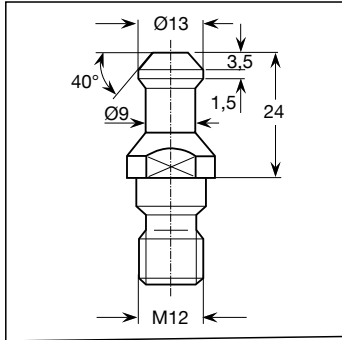

● = Ready in stock ■ = Delivery time 20 working days △ = On request

| Machines                           | Code           | €     |
|------------------------------------|----------------|-------|
| ALBERTI-MASTERWOOD per / for ISO30 | ● M8000AAAAAA5 | 19,80 |

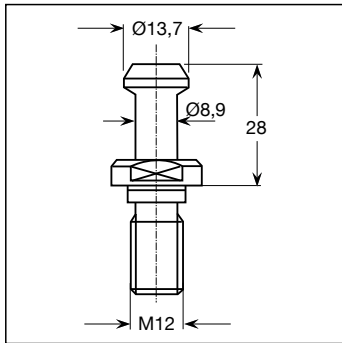

| Machines              | Code           | €     |
|-----------------------|----------------|-------|
| HEIAN per / for ISO30 | ● M8000AAAAAA6 | 26,60 |

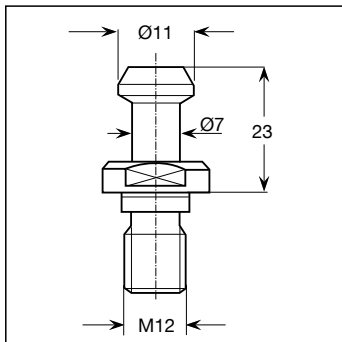

| Machines              | Code           | €     |
|-----------------------|----------------|-------|
| SHODA per / for ISO30 | ● M8000AAAAAA7 | 26,40 |

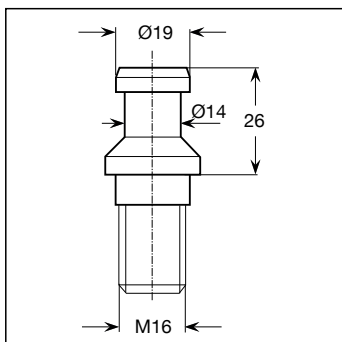

| Machines                                      | Code           | €     |
|---|----------------|-------|
| IMA-MAKA-REICHENBACHER-COSMEC per / for ISO30 | ● M8000AAAAAA8 | 26,40 |

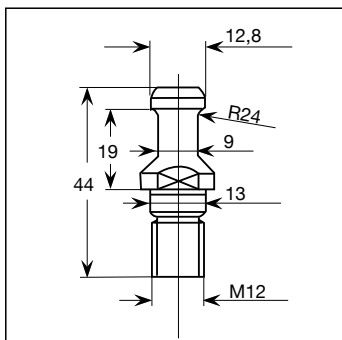

| Machines | Code           | €     |
|----------|----------------|-------|
| CMS      | ● M8000AAAAAA9 | 26,40 |

**NOTE** ■ Utensili non a magazzino, quantità minima d'ordine: **10 pezzi.**  
Tools not ready in stock minimum order quantity: **10 pieces.**

TAGLIO / SEZIONATURA  
SAWING

DIAMANTE  
DIAMOND

FRESATURA  
CUTTING

PANTOGRAFATURA  
ROUTING

FORATURA  
BORING

MANDRINI / ATTACCHI  
CHUCKS & CLAMPING SYSTEM

RICAMBI E LAVORAZIONI SUPP.  
SPARE PARTS & ADD. WORKING



Turbina di aspirazione truciolo

Absaugturbine

Turbine d'élimination des poussières

Турбина для отвода стружки

**MTS10**

**PAT. PENDING**  
UD2015A0000066

**Double blast turbine - Turbo System**

TAGLIO / SEZIONATURA  
SAWING

DIAMANTE  
DIAMOND

FRESATURA  
CUTTING

PANTOGRAFATURA  
ROUTING

FORATURA  
BORING

MANDRINI / ATTACCHI  
CHUCKS & CLAMPING SYSTEM

RICAMBI E LAVORAZIONI SUPP.  
SPARE PARTS & ADD. WORKING



Ghiera aspirante TURBO SYSTEM l'unica con doppia azione: aspirazione e flusso inverso • Rimuove il 90% del truciolo e della polvere dal piano di lavoro • Permette all'operatore di lavorare in un ambiente perfettamente pulito e sano • Facile da usare, si monta e smonta come una classica ghiera • Adatto per lavorazioni di nesting, contornatura e profilatura • Può essere posizionato da 3 a 25 mm dal piano di lavoro mantenendo un'ottima resa • Disponibili nelle versioni per ghiera ER25, ER32, ER40, OTR25 o a richiesta per attacchi speciali • Consente l'uso di utensili vari: elicoidali e sagomati • Rivestita con una speciale protezione ceramica con proprietà anticorrosive, antiabrasione e antistatiche

TURBO SYSTEM generates an air-compressed blast, which removes the residue amount of material from inside of any groove • Generates a vacuum which removes 97% of chips and dust • Allows the operator to work in a perfectly clean and healthy • Easy to use, mounts and disassemble as a classic ring • Suitable for nesting operations, contouring and profiling • It can be placed from 3 to 25 mm from the worktop by maintaining an excellent performance • Available in versions for ER25 rings, ER32, ER40, OTR25 or request special attacks • Allows the use of various tools: helical and shaped • Coated with a special protection ceramics with anti-corrosive properties, abrasion resistant and antistatic

● = Ready in stock ■ = Delivery time 20 working days ▲ = On request

| D   | S     | L1 | H  | Left Code      | Right Code     | €      |
|-----|-------|----|----|----------------|----------------|--------|
| 80  | ER25  | 15 | 44 | ▲ MTS10R25080L | ■ MTS10R25080R | 270,00 |
| 100 | ER25  | 15 | 44 | ▲ MTS10R25100L | ■ MTS10R25100R | 270,00 |
| 80  | ER32  | 15 | 44 | ▲ MTS10R32080L | ● MTS10R32080R | 270,00 |
| 100 | ER32  | 15 | 44 | ▲ MTS10R32100L | ● MTS10R32100R | 270,00 |
| 80  | ER40  | 15 | 44 | ▲ MTS10R40080L | ● MTS10R40080R | 270,00 |
| 100 | ER40  | 15 | 44 | ▲ MTS10R40100L | ● MTS10R40100R | 270,00 |
| 80  | ORT25 | 15 | 44 | ▲ MTS10T25080L | ● MTS10T25080R | 270,00 |
| 100 | ORT25 | 15 | 44 | ▲ MTS10T25100L | ● MTS10T25100R | 270,00 |

**NOTE** ■ ▲ Utensili non a magazzino, quantità minima d'ordine: **10 pezzi.**  
Tools not ready in stock minimum order quantity: **10 pieces.**

Il prezzo include una chiave di chiusura.  
The price included one wrench.

SPARE PARTS

| Type   | Dimensions | LT  | Code           | €     |
|--------|------------|-----|----------------|-------|
| Wrench | Ø 80       | 280 | ● ACH080AAAAAA | 36,00 |
| Wrench | Ø 100      | 280 | ● ACH095AAAAAA | 40,00 |

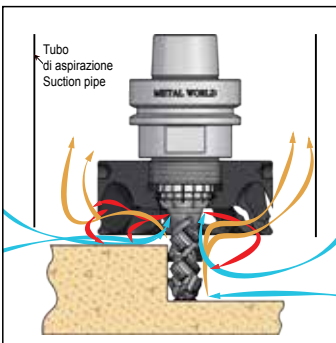
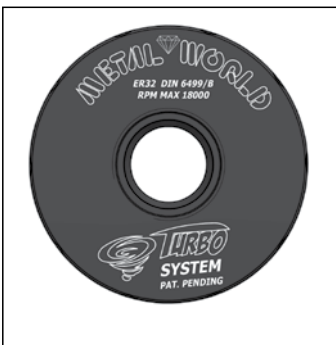
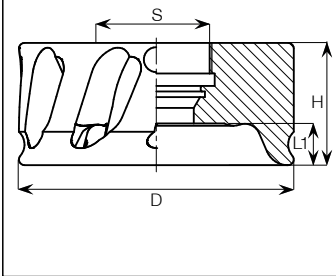

**Ø 80 – max RPM min<sup>-1</sup> 24.000**

| Diametro utensile<br>Tool diameter | Profondità di lavorazione<br>Machining depth working |
|------------------------------------|--|
| 6 mm                               | 20 mm  |
| 8 mm                               | 25 mm  |
| 10 mm                              | 25 mm  |
| 12 mm                              | 30 mm  |
| 16 mm                              | 40 mm  |
| 20 mm                              | 45 mm  |

Ø=80

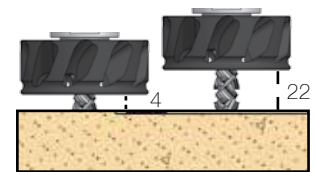

**Ø 100 – max RPM min<sup>-1</sup> 21.000**

| Diametro utensile<br>Tool diameter | Profondità di lavorazione<br>Machining depth working |
|------------------------------------|--|
| 6 mm                               | 25 mm  |
| 8 mm                               | 30 mm  |
| 10 mm                              | 30 mm  |
| 12 mm                              | 35 mm  |
| 16 mm                              | 45 mm  |
| 20 mm                              | 50 mm  |

Ø=100

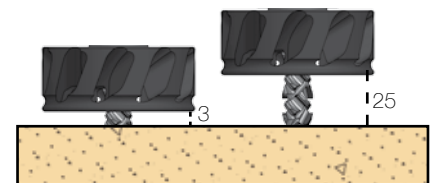

**MTS40** **PAT. PENDING** **Double blast turbine - Bi-Turbo System**



Ghiera aspirante TURBO SYSTEM l'unica con doppia azione: aspirazione e flusso inverso • Rimuove il 90% del truciolo e della polvere dal piano di lavoro • Permette all'operatore di lavorare in un ambiente perfettamente pulito e sano • Facile da usare, si monta e smonta come una classica ghiera • Adatto per lavorazioni di nesting, contornatura e profilatura • Può essere posizionato da 3 a 25 mm dal piano di lavoro mantenendo un'ottima resa • Disponibili nelle versioni per ghiera ER25, ER32, ER40, OTR25 o a richiesta per attacchi speciali • Consente l'uso di utensili vari: elicoidali e sagomati • Rivestita con una speciale protezione ceramica con proprietà anticorrosive, antiabrasione e antistatiche

TURBO SYSTEM generates an air-compressed blast, which removes the residue amount of material from inside of any groove • Generates a vacuum which removes 97% of chips and dust • Allows the operator to work in a perfectly clean and healthy • Easy to use, mounts and disassemble as a classic ring • Suitable for nesting operations, contouring and profiling • It can be placed from 3 to 25 mm from the worktop by maintaining an excellent performance • Available in versions for ER25 rings, ER32, ER40, OTR25 or request special attacks • Allows the use of various tools: helical and shaped • Coated with a special protection ceramics with anti-corrosive properties, abrasion resistant and antistatic

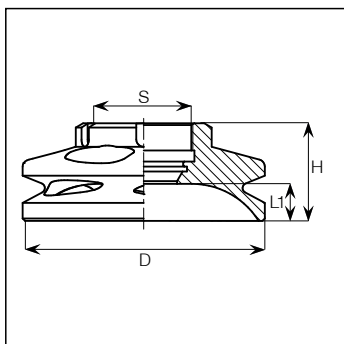

● = Ready in stock ■ = Delivery time 20 working days ▲ = On request

| D   | S      | L1 | H  | Left Code      | Right Code     | €      |
|-----|--------|----|----|----------------|----------------|--------|
| 100 | ER32   | 15 | 40 | ▲ MTS40R32100L | ● MTS40R32100R | 380,00 |
| 100 | ER40   | 15 | 40 | ▲ MTS40R40100L | ● MTS40R40100R | 380,00 |
| 100 | ORT25  | 15 | 40 | ▲ MTS40T25100L | ● MTS40T25100R | 380,00 |
| 100 | *ORT25 | 15 | 40 | MTS40X25100L   | MTS40X25100R   | 380,00 |

\* Utilizzabile esclusivamente con mandrino M937

\* Usable only with chucks M937

**NOTE** ▲ Utensili non a magazzino, quantità minima d'ordine: **10 pezzi.**  
Tools not ready in stock minimum order quantity: **10 pieces.**

Il prezzo include una chiave di chiusura.  
The price included one wrench.

**SPARE PARTS**

| Type   | Dimensions | LT  | Code           | €     |
|--------|------------|-----|----------------|-------|
| Wrench | Ø 58-62    | 240 | ● ACH058AAAAAA | 34,00 |

**Ø 100 – max RPM min<sup>-1</sup> 24.000\*\***

| Diametro utensile<br>Tool diameter | Profondità di lavorazione<br>Machining depth working |
|------------------------------------|--|
| 6 mm                               | 25 mm  |
| 8 mm                               | 30 mm  |
| 10 mm                              | 30 mm  |
| 12 mm                              | 35 mm  |
| 16 mm                              | 45 mm  |
| 20 mm                              | 50 mm  |

\*\* Con mandrino M937 max RPM min<sup>-1</sup> 30.000

\*\* With chucks M937 max RPM min<sup>-1</sup> 30.000

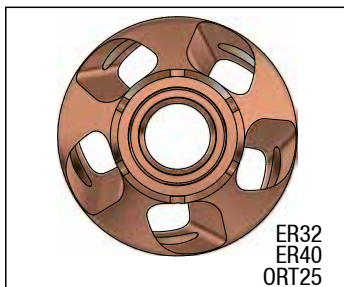
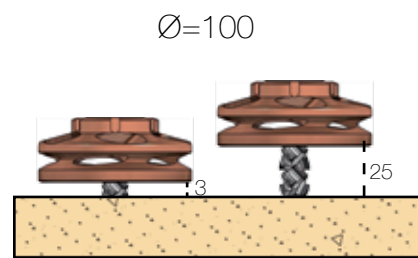

ER32  
ER40  
ORT25

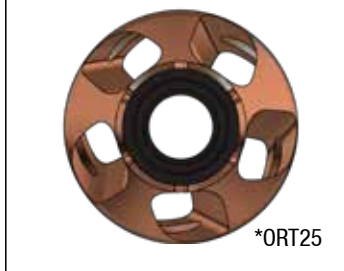

\*ORT25

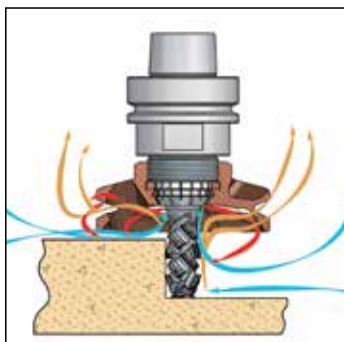
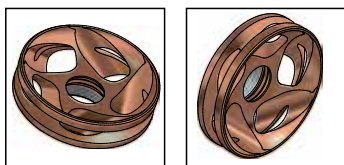

Bussole  
di riduzione foro

Reduzierbüchsen

Manchons de réduction  
cylindrique

Редукционные втулки

**B020**

**Reducing bushes**

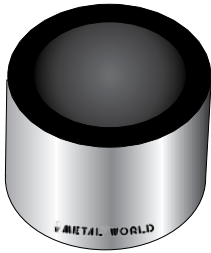

Ottenute da acciaio di elevata resistenza meccanica • Parti in accoppiamento interamente rettificatae • Da montare su utensili vari per ridurre il foro alla misura desiderata

Obtained from steel with a high mechanical resistance • Parts in connection completely ground • To mount on tools to reduce the bore to the size needed

● = Ready in stock ■ = Delivery time 20 working days △ = On request

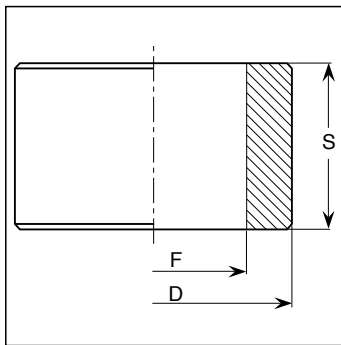

| D  | F  | S  | Code           | €     |
|----|----|----|----------------|-------|
| 30 | 20 | 2  | ● B0200302002A | 7,60  |
| 30 | 25 | 2  | ● B0200302502A | 7,60  |
| 32 | 30 | 2  | ● B0200323002A | 7,60  |
| 35 | 30 | 2  | ● B0200353002A | 7,60  |
| 35 | 30 | 5  | ● B0200353005A | 11,40 |
| 35 | 30 | 10 | ● B0200353010A | 13,40 |
| 35 | 30 | 15 | ● B0200353015A | 15,20 |
| 35 | 30 | 20 | ● B0200353020A | 17,20 |
| 35 | 30 | 25 | ● B0200353025A | 19,00 |
| 35 | 30 | 30 | ● B0200353030A | 20,80 |
| 40 | 30 | 2  | ● B0200403002A | 9,60  |
| 40 | 30 | 5  | ● B0200403005A | 13,40 |
| 40 | 30 | 10 | ● B0200403010A | 15,20 |
| 40 | 30 | 15 | ● B0200403015A | 17,20 |
| 40 | 30 | 20 | ● B0200403020A | 19,00 |
| 40 | 30 | 25 | ● B0200403025A | 20,80 |
| 40 | 30 | 30 | ● B0200403030A | 22,80 |
| 40 | 35 | 2  | ● B0200403502A | 9,60  |
| 40 | 35 | 5  | ● B0200403505A | 13,40 |
| 40 | 35 | 10 | ● B0200403510A | 15,20 |
| 40 | 35 | 15 | ● B0200403515A | 17,20 |
| 40 | 35 | 20 | ● B0200403520A | 19,00 |
| 40 | 35 | 25 | ● B0200403525A | 20,80 |
| 40 | 35 | 30 | ● B0200403530A | 22,80 |
| 50 | 30 | 5  | ● B0200503005A | 17,20 |
| 50 | 30 | 10 | ● B0200503010A | 19,00 |
| 50 | 30 | 15 | ● B0200503015A | 20,80 |
| 50 | 30 | 20 | ● B0200503020A | 22,80 |
| 50 | 30 | 25 | ● B0200503025A | 24,60 |
| 50 | 30 | 30 | ● B0200503030A | 26,60 |
| 50 | 35 | 10 | ● B0200503510A | 19,00 |
| 50 | 35 | 15 | ● B0200503515A | 20,80 |
| 50 | 35 | 20 | ● B0200503520A | 22,80 |
| 50 | 35 | 25 | ● B0200503525A | 24,60 |
| 50 | 35 | 30 | ● B0200503530A | 26,60 |
| 50 | 40 | 10 | ● B0200504010A | 19,00 |
| 50 | 40 | 15 | ● B0200504015A | 20,80 |
| 50 | 40 | 20 | ● B0200504020A | 22,80 |
| 50 | 40 | 25 | ● B0200504025A | 24,60 |
| 50 | 40 | 30 | ● B0200504030A | 26,60 |

Spec.

B020099

TAGLIO / SEZIONATURA  
SAWING

DIAMANTE  
DIAMOND

FRESATURA  
CUTTING

PANTOGRAFATURA  
ROUTING

FORATURA  
BORING

MANDRINI / ATTACCHI  
CHUCKS & CLAMPING SYSTEM

RICAMBI E LAVORAZIONI SUPP.  
SPARE PARTS & ADD. WORKING



**B030** Coupling bushes



Ottenute da acciaio di elevata resistenza meccanica • Permettono un perfetto accoppiamento tra utensile e albero motore  
 Obtained from steel with a high mechanical resistance • High precision connection between tool and motor spindle

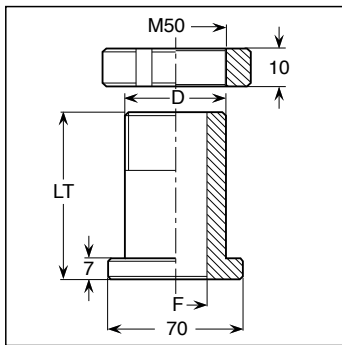

● = Ready in stock ■ = Delivery time 20 working days △ = On request

| D     | F   | LT  | Left Code     | Right Code    | €             |
|-------|-----|-----|---------------|---------------|---------------|
| ≤50   | ≤40 | 100 | ● B0300100AAL | ● B0300100AAR | <b>170,20</b> |
| ≤50   | ≤40 | 150 | ● B0300150AAL | ● B0300150AAR | <b>226,80</b> |
| ≤50   | ≤40 | 200 | ● B0300200AAL | ● B0300200AAR | <b>281,80</b> |
| Spec. |     |     | B030099L      | B030099R      |               |

TAGLIO / SEZIONATURA  
SAWING

DIAMANTE  
DIAMOND

FRESATURA  
CUTTING

PANTOGRAFATURA  
ROUTING

FORATURA  
BORING

MANDRINI / ATTACCHI  
CHUCKS & CLAMPING SYSTEM

RICAMBI E LAVORAZIONI SUPP.  
SPARE PARTS & ADD. WORKING

Flange  
di riduzione foro

Reduzierbüchsen  
mit Bund

Manchons de réduction

Редукционные фланцы

**B040**

**Reducing bushes with flange**



Ottenute da acciaio di ottima qualità • Parti in accoppiamento interamente rettificate • Da montare su utensili vari per ridurre il foro alla misura desiderata

Obtained from steel with a high mechanical resistance • Parts in connection completely ground • To mount on tools to reduce the bore to the size needed

● = Ready in stock ■ = Delivery time 20 working days △ = On request

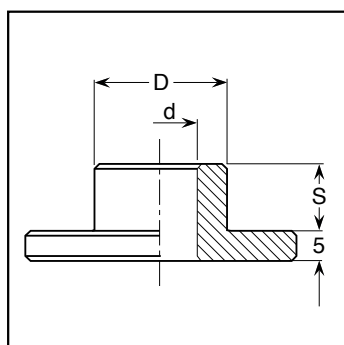

| D  | d  | S  | Code           | €     |
|----|----|----|----------------|-------|
| 35 | 30 | 10 | ■ B0400353010A | 26,60 |
| 35 | 30 | 15 | ■ B0400353015A | 28,40 |
| 35 | 30 | 20 | ■ B0400353020A | 30,40 |
| 40 | 30 | 10 | ■ B0400403010A | 30,40 |
| 40 | 30 | 15 | ■ B0400403015A | 32,20 |
| 40 | 30 | 20 | ■ B0400403020A | 34,20 |
| 40 | 35 | 10 | ■ B0400403510A | 30,20 |
| 40 | 35 | 15 | ■ B0400403515A | 32,20 |
| 40 | 35 | 20 | ■ B0400403520A | 34,20 |
| 50 | 30 | 10 | ■ B0400503010A | 34,20 |
| 50 | 30 | 15 | ■ B0400503015A | 36,00 |
| 50 | 30 | 20 | ■ B0400503020A | 37,80 |
| 50 | 35 | 10 | ■ B0400503510A | 34,20 |
| 50 | 35 | 15 | ■ B0400503515A | 36,00 |
| 50 | 35 | 20 | ■ B0400503520A | 37,80 |
| 50 | 40 | 10 | ■ B0400504010A | 34,20 |
| 50 | 40 | 15 | ■ B0400504015A | 36,00 |
| 50 | 40 | 20 | ■ B0400504020A | 37,80 |

Spec.

B040099

TAGLIO / SEZIONATURA  
SAWING

DIAMANTE  
DIAMOND

FRESATURA  
CUTTING

PANTOGRAFATURA  
ROUTING

FORATURA  
BORING

MANDRINI / ATTACCHI  
CHUCKS & CLAMPING SYSTEM

RICAMBI E LAVORAZIONI SUPP.  
SPARE PARTS & ADD. WORKING

Flange di fissaggio lame

Sägeblattflansch

Flasques pour lames de scies circulaires

Фланцы для пильных дисков

## B050

## Flanges for saw blades

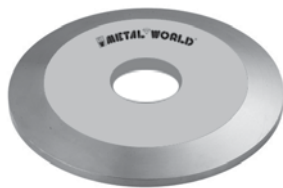

Ottenute da acciaio di ottima qualità • Parti in accoppiamento interamente rettificate • Per fissare e bloccare lame su qualsiasi tipo di macchina

Obtained from high quality steel • Parts in connection completely ground • To mount saw blades on any type of machine

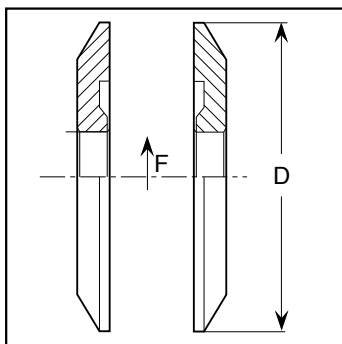

● = Ready in stock ■ = Delivery time 20 working days △ = On request

| D     | F  | Code           | €      |
|-------|----|----------------|--------|
| 100   | 30 | ■ B050010030AA | 107,80 |
| 125   | 30 | ■ B050012530AA | 121,00 |
| 100   | 35 | ■ B050010035AA | 107,80 |
| 125   | 35 | ■ B050012535AA | 121,00 |
| 100   | 40 | ■ B050010040AA | 107,80 |
| 125   | 40 | ■ B050012540AA | 121,00 |
| 100   | 50 | ■ B050010050AA | 107,80 |
| 125   | 50 | ■ B050012550AA | 121,00 |
| Spec. |    | B050099        |        |

TAGLIO / SEZIONATURA  
SAWING

DIAMANTE  
DIAMOND

FRESATURA  
CUTTING

PANTOGRAFATURA  
ROUTING

FORATURA  
BORING

MANDRINI / ATTACCHI  
CHUCKS & CLAMPING SYSTEM

RICAMBI E LAVORAZIONI SUPP.  
SPARE PARTS & ADD. WORKING

Flange di fissaggio lame con riduzione foro

Sägeblattflansch

Flasques pour des lames de scies circulaires avec la réduction du trou

Фланцы для пильных дисков

## B060

## Flanges for saw blades with bore reduction



Ottenute da acciaio di ottima qualità • Parti in accoppiamento interamente rettificate • Per fissare e bloccare lame su qualsiasi tipo di macchina

Obtained from high quality steel • Parts in connection completely ground • To mount saw blades on any type of machine

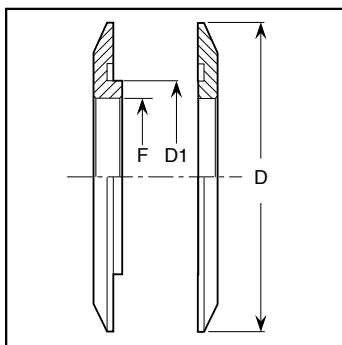

● = Ready in stock ■ = Delivery time 20 working days △ = On request

| D     | Code           | €      |
|-------|----------------|--------|
| 100   | ■ B0600100FFD1 | 151,20 |
| 125   | ■ B0600125FFD1 | 170,20 |
| Spec. | B060099        |        |

\* Specificare le misure F e D1 al momento dell'ordine  
\* At the order specify F and D1 sizes



Boccole Hydro  
con ghiera per frese

Hydrobüchse

Manchons hydro  
avec douille de réglable  
pour fraises

Втулки Гидро с  
накидной гайкой для фрез

## B1AC

## Hydro sleeves with ring nut for cutters



Ottenute da acciaio di ottima qualità • Parti in accoppiamento interamente rettificate • Indicate per il montaggio su alberi di alta precisione e in special modo su macchine con avanzamenti e parametri di lavoro in genere molto elevati

Obtained from high quality steel • Parts in connection completely ground • To be mounted on high precision spindles and particularly suitable for machines with very high feeds and working parameters

CON SISTEMA DI BLOCCO/SBLOCCO HYDRO MEDIANTE CHIAVE ESAGONALE  
WITH LOCK/UNLOCK HYDRO SYSTEM BY MEANS OF T ALLEN KEY

| D1  | S   | F  | D  | L  | L1 | Code           | €        |
|-----|-----|----|----|----|----|----------------|----------|
| 100 | 75  | 40 | 50 | 40 | 55 | ■ B1AC04050075 | 1.101,00 |
| 102 | 75  | 40 | 60 | 40 | 55 | ■ B1AC04060075 | 1.029,00 |
| 108 | 95  | 40 | 60 | 60 | 75 | ■ B1AC04060095 | 1.119,00 |
| 108 | 115 | 40 | 60 | 80 | 95 | ■ B1AC04060115 | 1.200,00 |
| 102 | 75  | 50 | 60 | 40 | 55 | ■ B1AC05060075 | 987,00   |
| 108 | 95  | 50 | 60 | 60 | 75 | ■ B1AC05060095 | 1.068,00 |
| 108 | 115 | 50 | 60 | 80 | 95 | ■ B1AC05060115 | 1.113,00 |

Spec.

B1900000

● = Ready in stock ■ = Delivery time 20 working days △ = On request

CON SISTEMA DI BLOCCO/SBLOCCO HYDRO MEDIANTE POMPA  
WITH LOCK/UNLOCK HYDRO SYSTEM BY MEANS OF GREASE PUMP

| D1 | S   | F  | D  | L   | L1  | Code           | €        |
|----|-----|----|----|-----|-----|----------------|----------|
| 93 | 165 | 40 | 60 | 130 | 145 | ■ B1AP04060140 | 1.149,00 |
| 93 | 215 | 40 | 60 | 180 | 195 | ■ B1AP04060215 | 1.488,00 |
| 93 | 140 | 50 | 60 | 105 | 120 | ■ B1AP05060115 | 987,00   |
| 93 | 190 | 50 | 60 | 155 | 170 | ■ B1AP05060190 | 1.185,00 |
| 93 | 240 | 50 | 60 | 205 | 220 | ■ B1AP05060240 | 1.404,00 |

Spec.

B1900000

SPARE PARTS

| Type                  | Code           | €      |
|-----------------------|----------------|--------|
| T allen key for hydro | ■ ACHET08HAAAA | 48,60  |
| T allen key for hydro | ■ ACHET10HAAAA | 64,80  |
| Grease pump for hydro | ■ WAGREASEPUMP | 870,00 |

\* Doppio bloccaggio hydro (utensile ed albero macchina)

\* Double hydro locking system (tool bore and spindle machine)

### NOTE

■ Utensili non a magazzino, quantità minima d'ordine: **1 pezzo.**  
Tools not ready in stock minimum order quantity: **1 piece.**

Il prezzo include una chiave di regolazione.  
The price included one screwdrivers.

TAGLIO / SEZIONATURA  
SAWING

DIAMANTE  
DIAMOND

FRESATURA  
CUTTING

PANTOGRAFATURA  
ROUTING

FORATURA  
BORING

MANDRINI / ATTACCHI  
CHUCKS & CLAMPING SYSTEM

RICAMBI E LAVORAZIONI SUPP.  
SPARE PARTS & ADD. WORKING



# B1BC Hydro sleeves for cutters



Ottenute da acciaio di ottima qualità • Parti in accoppiamento interamente rettificate • Indicate per il montaggio su alberi di alta precisione e in special modo su macchine con avanzamenti e parametri di lavoro in genere molto elevati

Obtained from high quality steel • Parts in connection completely ground • To be mounted on high precision spindles and particularly suitable for machines with very high feeds and working parameters

CON SISTEMA DI BLOCCO/SBLOCCO HYDRO MEDIANTE CHIAVE ESAGONALE  
WITH LOCK/UNLOCK HYDRO SYSTEM BY MEANS OF T ALLEN KEY

| D1  | S   | F  | D  | L   | Code  | €               |
|-----|-----|----|----|-----|---|-----------------|
| 100 | 75  | 40 | 50 | 55  | <span style="color: red;">■</span> B1BC04050075 | <b>1.407,00</b> |
| 102 | 75  | 40 | 60 | 55  | <span style="color: red;">■</span> B1BC04060075 | <b>999,00</b>   |
| 108 | 95  | 40 | 60 | 75  | <span style="color: red;">■</span> B1BC04060095 | <b>1.059,00</b> |
| 108 | 115 | 40 | 60 | 95  | <span style="color: red;">■</span> B1BC04060115 | <b>1.170,00</b> |
| 114 | 140 | 40 | 60 | 115 | <span style="color: red;">■</span> B1BC04060140 | <b>1.353,00</b> |
| 102 | 75  | 50 | 60 | 55  | <span style="color: red;">■</span> B1BC05060075 | <b>939,00</b>   |
| 108 | 95  | 50 | 60 | 75  | <span style="color: red;">■</span> B1BC05060095 | <b>1.014,00</b> |
| 108 | 115 | 50 | 60 | 95  | <span style="color: red;">■</span> B1BC05060115 | <b>1.056,00</b> |
| 114 | 140 | 50 | 60 | 115 | <span style="color: red;">■</span> B1BC05060140 | <b>1.230,00</b> |

Spec.

B1900000

● = Ready in stock ■ = Delivery time 20 working days △ = On request

CON SISTEMA DI BLOCCO/SBLOCCO HYDRO MEDIANTE POMPA  
WITH LOCK/UNLOCK HYDRO SYSTEM BY MEANS OF GREASE PUMP

| D1 | S   | F  | D  | L   | Code  | €               |
|----|-----|----|----|-----|---|-----------------|
| 93 | 115 | 40 | 60 | 95  | <span style="color: red;">■</span> B1AP04060140 | <b>924,00</b>   |
| 93 | 140 | 50 | 60 | 120 | <span style="color: red;">■</span> B1AP05060115 | <b>975,00</b>   |
| 93 | 190 | 50 | 60 | 170 | <span style="color: red;">■</span> B1AP05060190 | <b>1.146,00</b> |
| 93 | 230 | 50 | 60 | 210 | <span style="color: red;">■</span> B1AP05060240 | <b>1.335,00</b> |

Spec.

B1900000

SPARE PARTS

| Type                  | Code  | €             |
|-----------------------|---|---------------|
| T allen key for hydro | <span style="color: red;">■</span> ACHET08HAAAA | <b>48,60</b>  |
| T allen key for hydro | <span style="color: red;">■</span> ACHET10HAAAA | <b>64,80</b>  |
| Grease pump for hydro | <span style="color: red;">■</span> WAGREASEPUMP | <b>870,00</b> |

\* Doppio bloccaggio hydro (utensile ed albero macchina)

\* Double hydro locking system (tool bore and spindle machine)

**NOTE**

■ Utensili non a magazzino, quantità minima d'ordine: **1 pezzo.**  
Tools not ready in stock minimum order quantity: **1 piece.**

Il prezzo include una chiave di regolazione.  
The price included one screwdrivers.

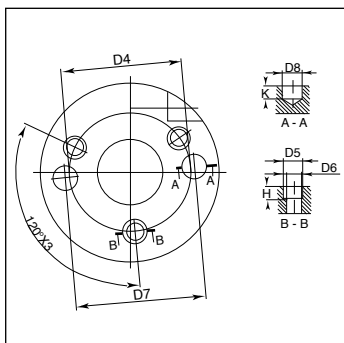
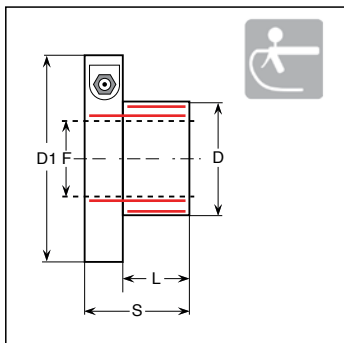
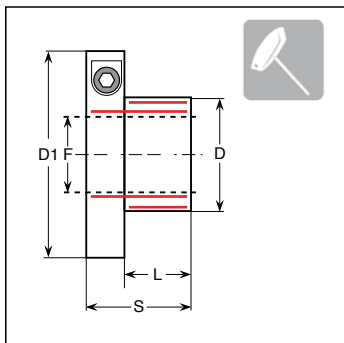

TAGLIO / SEZIONATURA  
SAWING

DIAMANTE  
DIAMOND

FRESATURA  
CUTTING

PANTOGRAFATURA  
ROUTING

FORATURA  
BORING

MANDRINI / ATTACCHI  
CHUCKS & CLAMPING SYSTEM

RICAMBI E LAVORAZIONI SUPP.  
SPARE PARTS & ADD. WORKING



Boccole Hydro per alberi con esagono



Hydrobüchse mit Sechskant-Verdrehsicherung



Manchons hydro pour fraises



Втулки Гидро для шестигранных хвостовиков

TAGLIO / SEZIONATURA  
SAWING

DIAMANTE  
DIAMOND

FRESATURA  
CUTTING

PANTOGRAFATURA  
ROUTING

FORATURA  
BORING

MANDRINI / ATTACCHI  
CHUCKS & CLAMPING SYSTEM

RICAMBI E LAVORAZIONI SUPP.  
SPARE PARTS & ADD. WORKING

## B1CC

## Hydro sleeves with hexagon safety disk



Ottenute da acciaio di ottima qualità • Parti in accoppiamento interamente rettificate • Indicate per il montaggio su alberi di alta precisione e in special modo su macchine con avanzamenti e parametri di lavoro in genere molto elevati  
• Da montare su articolo DFF52

Obtained from high quality steel • Parts in connection completely ground • To be mounted on high precision spindles and particularly suitable for machines with very high feeds and working parameters • Indicated for item DFF52

CON SISTEMA DI BLOCCO/SBLOCCO HYDRO MEDIANTE CHIAVE ESAGONALE  
WITH LOCK/UNLOCK HYDRO SYSTEM BY MEANS OF T ALLEN KEY

| D1  | S  | F  | D  | L  | Code           | €               |
|-----|----|----|----|----|----------------|-----------------|
| 120 | 92 | 40 | 60 | 68 | ■ B1CC04060092 | <b>1.086,00</b> |
| 108 | 79 | 30 | 50 | 55 | ■ B1CC03050079 | <b>1.180,00</b> |

Spec.

B110C99

● = Ready in stock ■ = Delivery time 20 working days △ = On request

SPARE PARTS

| Type                  | Code           | €            |
|-----------------------|----------------|--------------|
| T allen key for hydro | ■ ACHET06AAAAA | <b>38,80</b> |
| Hexagonal safety disk | ■ BSET01555034 | <b>88,20</b> |

\* Doppio bloccaggio hydro (utensile ed albero macchina)

\* Double hydro locking system (tool bore and spindle machine)

### NOTE

■ Utensili non a magazzino, quantità minima d'ordine: **1 pezzo.**  
Tools not ready in stock minimum order quantity: **1 piece.**

Il prezzo include una chiave di regolazione.  
The price included one screwdrivers.

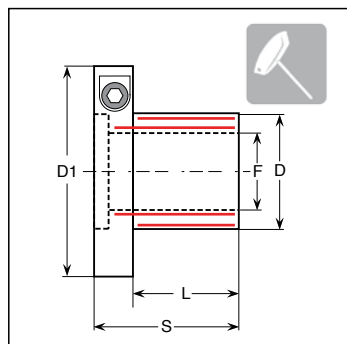

 Boccole Hydro con esagono per truciolatori

 Hydrobüchse mit Sechskant-Verdrehsicherung

 Manchon hydro pour Déchiqueteurs

 Втулки Гидро с шестигранным диском для измельчителей





**B2CC** Hydro sleeves with hexagon safety disk suitable for hoggers

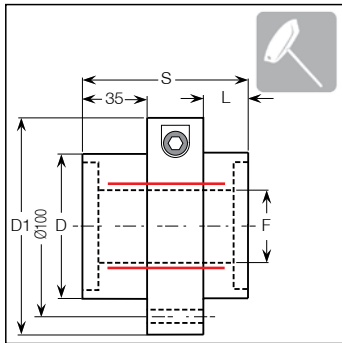

Ottenute da acciaio di ottima qualità • Parti in accoppiamento interamente rettificate • Indicate per il montaggio su alberi di alta precisione e in special modo su macchine con avanzamenti e parametri di lavoro in genere molto elevati • Da montare su truciolatori con F=80

Obtained from high quality steel • Parts in connection completely ground • To be mounted on high precision spindles and particularly suitable for machines with very high feeds and working parameters • Indicated for hoggers with F=80





 Utensili non a magazzino, quantità minima d'ordine: **1 pezzo**.  
Tools not ready in stock minimum order quantity: **1 piece**.

CON SISTEMA DI BLOCCO/SBLOCCO HYDRO MEDIANTE CHIAVE ESAGONALE  
WITH LOCK/UNLOCK HYDRO SYSTEM BY MEANS OF T ALLEN KEY

| D1  | S  | F  | D  | L  | Code   | €               |
|-----|----|----|----|----|--|-----------------|
| 120 | 92 | 40 | 80 | 25 |  B2CC04080092 | <b>1.130,40</b> |

Spec. B2C0000  
 = Ready in stock  = Delivery time 20 working days  = On request

SPARE PARTS

| Type                  | Code   | €            |
|-----------------------|--|--------------|
| T allen key for hydro |  ACHET06HAAAA | <b>38,80</b> |
| Hexagonal safety disk |  BSET01555034 | <b>88,20</b> |

\* Bloccaggio hydro solo su albero macchina  
\* Hydro locking system for spindle machine

Il prezzo include una chiave di regolazione.  
The price included one screwdrivers.

 Boccole Hydro con esagono per frese regolabili STEP

 Hydrobüchse mit Sechskant-Verdrehsicherung

 Manchons hydro pour fraises réglable

 Втулки Гидро с шестигранным валом для фрез ГИДРО STEP

**B3CC** Hydro sleeves with hexagon safety disk



Costruite con acciaio di ottima qualità • Permettono un perfetto accoppiamento tra utensile e albero motore • Aumentano la velocità di avanzamento, quindi una maggiore produttività • L'elevata precisione e concentricità dei taglienti garantisce una migliore finitura della superficie da lavorare • Da montare su frese regolabili DFF50

Obtained from high quality steel • To be mounted on high precision spindles • Increase a high feed speed therefore a large production • The high precision and concentricity of the cutters grant a better finish on the material to work out • To mount on adjustable jointin cutters DFF50

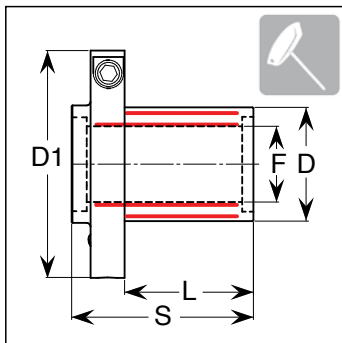



 Utensili non a magazzino, quantità minima d'ordine: **1 pezzo**.  
Tools not ready in stock minimum order quantity: **1 piece**.

CON SISTEMA DI BLOCCO/SBLOCCO HYDRO MEDIANTE CHIAVE ESAGONALE  
WITH LOCK/UNLOCK HYDRO SYSTEM BY MEANS OF T ALLEN KEY

| D1  | S  | F  | D  | L  | Code   | €             |
|-----|----|----|----|----|--|---------------|
| 120 | 96 | 40 | 60 | 68 |  B3CC04060096 | <b>780,00</b> |

Spec. B3C0000  
 = Ready in stock  = Delivery time 20 working days  = On request

SPARE PARTS

| Type                    | Code   | €            |
|-------------------------|--|--------------|
| "T" allen key for hydro |  ACHET08HAAAA | <b>48,60</b> |
| Hexagonal safety disk   |  BSET99132    | <b>88,20</b> |

\* Doppio bloccaggio hydro (utensile ed albero macchina)  
\* Double hydro locking system (tool bore and spindle machine)

Il prezzo include una chiave di regolazione.  
The price included one screwdrivers.

TAGLIO / SEZIONATURA  
SAWING

DIAMANTE  
DIAMOND

FRESATURA  
CUTTING

PANTOGRAFATURA  
ROUTING

FORATURA  
BORING

MANDRINI / ATTACCHI  
CHUCKS & CLAMPING SYSTEM

RICAMBI E LAVORAZIONI SUPP.  
SPARE PARTS & ADD. WORKING

# BRSH

## Pneumatic hydro quick clamping system



Ottenuti da acciaio di ottima qualità • Consentono la sostituzione rapida degli utensili • Sistema pneumatico: ottima stabilità e precisione degli utensili • Sistema hydro incorporato: riduce ulteriormente le tolleranze migliorando il rendimento degli utensili • Adatti per squadratrici per l'industria del mobile o per la produzione di parquet • Da montare su macchine di elevata precisione equipaggiate di alberi con esagono

Obtained from high quality steel • Easy change tools • Pneumatic system: high stability and precision of the tools • Hydro system incorporated: reduces the tolerances and increase the performance of the tools • Suitable for end-banding machines of furniture industries and the production of flooring • To mount on machines of high precision with hexagonal motor spindle

BLOCCAGGIO/SBLOCCAGGIO BOCCOLA HYDRO MEDIANTE CHIAVE ESAGONALE  
BLOCCAGGIO/SBLOCCAGGIO UTENSILE MEDIANTE SISTEMA PNEUMATICO  
LOCKING/UNLOCKING HYDRO SLEEVE BY MEANS OF HEXAGONAL T ALLEN KEY  
LOCKING/UNLOCKING TOOL BY MEANS OF PNEUMATIC SYSTEM

| D   | Pins  | d          | Code           | €        |
|-----|-------|------------|----------------|----------|
| 160 | 4/130 | 60/MASCHIO | ■ BRSH0160AAAA | 2.520,00 |

Spec.

BRSH099

● = Ready in stock ■ = Delivery time 20 working days △ = On request

### SPARE PARTS

| Type                    | Code           | €      |
|-------------------------|----------------|--------|
| "T" allen key for hydro | ■ ACHET08HAAAA | 48,60  |
| Hexagonal safety disk   | ■ BSET01555034 | 88,20  |
| Pneumatic hose          | ■ BSETRACCORDO | 162,00 |

### NOTE

■ Utensili non a magazzino, quantità minima d'ordine: **1 pezzo**.  
Tools not ready in stock minimum order quantity: **1 piece**.

Il prezzo include una chiave di regolazione.  
The price included one screwdrivers.

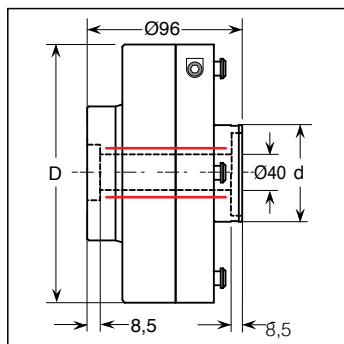

# BRSN Pneumatic quick clamping system



Ottenuti da acciaio di ottima qualità • Sistema pneumatico • Consentono la sostituzione rapida degli utensili • Ottima stabilità e precisione degli utensili • Da montare su macchine di elevata precisione

Obtained from high quality steel • Easy change tools • Pneumatic system • High stability and precision of the tools • To mount on machines of high precision with hexagonal motor spindle

● = Ready in stock ■ = Delivery time 20 working days △ = On request

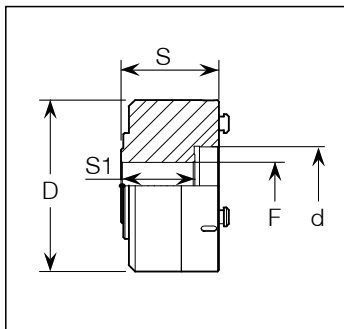

| D   | S  | S1   | F  | Pins  | d  | Code           | €      |
|-----|----|------|----|-------|----|----------------|--------|
| 110 | 63 | 47,5 | 30 | 3/80  | 50 | ■ BRSN011030AA | 775,80 |
| 110 | 63 | 47,5 | 35 | 3/80  | 50 | ■ BRSN011035AA | 775,80 |
| 140 | 57 | 47,5 | 30 | 3/110 | 80 | ■ BRSN014030AA | 891,00 |
| 140 | 57 | 47,5 | 35 | 3/110 | 80 | ■ BRSN014035AA | 891,00 |
| 140 | 57 | 47,5 | 40 | 3/110 | 80 | ■ BRSN014040AA | 891,00 |

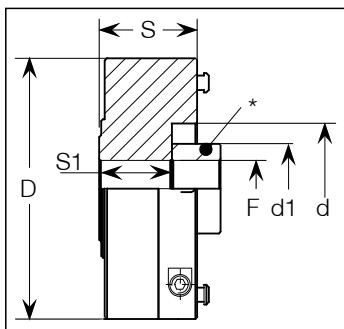

| D    | S  | S1   | F  | Pins  | d  | d1 | Code           | €        |
|------|----|------|----|-------|----|----|----------------|----------|
| 160  | 60 | 44,5 | 35 | 4/130 | 80 |    | ■ BRSN016035AA | 979,20   |
| 160  | 60 | 44,5 | 40 | 4/130 | 80 |    | ■ BRSN016040AA | 979,20   |
| 160* | 60 | 44,5 | 35 | 4/130 | 80 | 60 | ■ BRSN016035AB | 1.042,20 |
| 160* | 60 | 44,5 | 40 | 4/130 | 80 | 60 | ■ BRSN016040AB | 1.042,20 |

Spec.

\* Ottenuto aggiungendo bussola a BRSN016035AA – BRSN016040AA  
 \* Obtained by adding bush at BRSN016035AA – BRSN016040AA

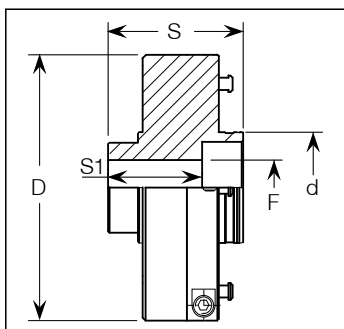

| D   | S  | S1 | F  | Pins  | d  | Code           | €        |
|-----|----|----|----|-------|----|----------------|----------|
| 192 | 90 | 68 | 35 | 4/150 | 80 | ■ BRSN019235AA | 1.080,00 |
| 192 | 90 | 68 | 40 | 4/150 | 80 | ■ BRSN019240AA | 1.080,00 |

Spec. BRSN099

SPARE PARTS

| Type           | Code           | €      |
|----------------|----------------|--------|
| Pneumatic hose | ■ BSETRACCORDO | 162,00 |

**NOTE**  
 ■ Utensili non a magazzino, quantità minima d'ordine: **1 pezzo.**  
 Tools not ready in stock minimum order quantity: **1 piece.**

Il prezzo include una chiave di regolazione.  
 The price included one screwdrivers.



TAGLIO / SEZIONATURA  
SAWING

DIAMANTE  
DIAMOND

FRESATURA  
CUTTING

PANTOGRAFATURA  
ROUTING

FORATURA  
BORING

MANDRINI / ATTACCHI  
CHUCKS & CLAMPING SYSTEM

RICAMBI E LAVORAZIONI SUPP.  
SPARE PARTS & ADD. WORKING

Attacchi rapidi pneumatico con flangia TOP SYSTEM per truciolatori

Schnellspannsystem TOP SYSTEM

Système de serrage rapide

Фланец гидро top system для измельчителей

## BRST

## Pneumatic quick clamping system with tool holder Top System for hogsers



Ottenuti da acciaio di ottima qualità • Sistema pneumatico • Consentono la sostituzione rapida degli utensili • Sistema TOPSYS: perfetta planarità ed equilibratura

Obtained from high quality steel • Easy change tools • Pneumatic system • High stability and precision of the tools • TOPSYS system: perfect alignment on the side and balancing

● = Ready in stock ■ = Delivery time 20 working days △ = On request

| D   | S   | S1 | F  | Pins  | d  | Code           | €        |
|-----|-----|----|----|-------|----|----------------|----------|
| 160 | 105 | 63 | 35 | 4/130 | 60 | ■ BRST016035AA | 1.690,20 |
| 160 | 105 | 68 | 40 | 4/130 | 60 | ■ BRST016040AA | 1.690,20 |
| 190 | 100 | 63 | 35 | 4/150 | 80 | ■ BRST019035AB | 1.782,00 |
| 190 | 100 | 68 | 40 | 4/150 | 80 | ■ BRST019040AB | 1.782,00 |

Spec. BRST099

### SPARE PARTS

| Type           | Code           | €      |
|----------------|----------------|--------|
| Pneumatic hose | ■ BSETRACCORDO | 162,00 |

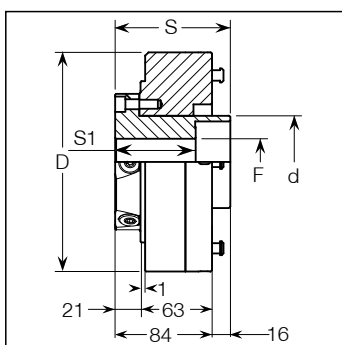

Flange portautensili TOP SYSTEM

Schnellspannsystem TOP SYSTEM

Flasque pour TOP SYSTEM

Фланец TOP SYSTEM

## BSYS

## TOP SYSTEM tool holder



Dispositivo semplice da usare, maneggevole e preciso • Studiato e BREVETTATO da METAL WORLD per correggere difetti di planarità e vibrazioni su macchine che richiederebbero una revisione in genere ben più onerosa • E' indicato inoltre, su macchine prive di difetti predisponendole alla possibilità di eventuali interventi correttivi, garantendo in tal modo una maggiore affidabilità

A simple, handy and accurate device • Designed and PATENTED by METAL WORLD to correct defects in alignment on the side and vibration of machines that would require a revision generally more onerous • Indicated, on machines without defects predisposing them to the possibility of any corrective action, thus ensuring greater reliability

● = Ready in stock ■ = Delivery time 20 working days △ = On request

| D   | S  | S1 | F  | Fix. bore | d  | Code           | €        |
|-----|----|----|----|-----------|----|----------------|----------|
| 124 | 60 | 30 | 25 | 6/M6/106  | 60 | ■ BSYS012425AA | 936,00   |
| 124 | 60 | 30 | 30 | 6/M6/106  | 60 | ■ BSYS012430AA | 936,00   |
| 138 | 68 | 32 | 35 | 6/M8/120  | 80 | ■ BSYS013835AA | 1.022,40 |
| 138 | 68 | 32 | 40 | 6/M8/120  | 80 | ■ BSYS013840AA | 1.022,40 |

Spec. BSYS099

### NOTE

■ Utensili non a magazzino, quantità minima d'ordine: **1 pezzo.**  
Tools not ready in stock minimum order quantity: **1 piece.**

Il prezzo include una chiave di regolazione.  
The price included one screwdrivers.

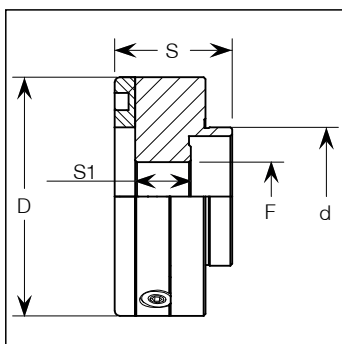

TAGLIO / SEZIONATURA  
SAWING

DIAMANTE  
DIAMOND

FRESATURA  
CUTTING

PANTOGRAFATURA  
ROUTING

FORATURA  
BORING

MANDRINI / ATTACCHI  
CHUCKS & CLAMPING SYSTEM

RICAMBI E LAVORAZIONI SUPP.  
SPARE PARTS & ADD. WORKING



Flange Zero System per truciolatori

Schnellspannsystem ZERO SYSTEM

Porte-outil ZERO SYSTEM

Фланец Zero System для измельчителей



## BZYS ZERO SYSTEM tool holder for hoggers



Ottenuta da acciaio di ottima qualità • Il sistema ZERO SYSTEM permette di correggere oltre ai problemi di planarità e di equilibratura anche quelli di eccentricità • Garantisce un'ottima qualità di lavorazione abbinata ad un'elevata durata dell'utensile • Utile da impiegare su qualsiasi tipo di macchina ma particolarmente indicata su macchine non perfettamente a punto

Obtained from a high quality steel • ZERO SYSTEM allows to resolves problems of alignment on the side, balancing and eccentricity • Provides excellent quality processing combined with long tool life • Suitable for any type of machine, especially for those not perfectly in place

● = Ready in stock ■ = Delivery time 20 working days △ = On request

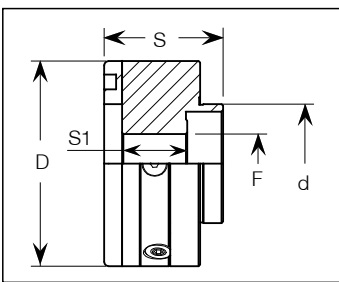

| D     | S    | S1 | F  | Fix. bore | d    | Code           | €        |
|-------|------|----|----|-----------|------|----------------|----------|
| 138   | 80   | 44 | 35 | 8/M8/120  | 80   | ■ BZYS013835AA | 1.270,80 |
| 138   | 80   | 44 | 40 | 8/M8/120  | 80   | ■ BZYS013840AA | 1.270,80 |
| 138   | 76,7 | 44 | 35 | 8/M8/120  | MW80 | ■ BZYS013835AB | 1.357,20 |
| 138   | 76,7 | 44 | 40 | 8/M8/120  | MW80 | ■ BZYS013840AB | 1.357,20 |
| Spec. |      |    |    |           |      | BZYS099        |          |

Attacchi rapidi pneumatici ZERO SYSTEM per truciolatori

Schnellspannsystem ZERO SYSTEM

Système de serrage rapide ZERO SYSTEM

Фланец гидро Zero System для измельчителей

## BRSZ ZERO SYSTEM pneumatic quick clamping system for hoggers



Ottenuti da acciaio di ottima qualità • Consentono la sostituzione rapida degli utensili • Sistema pneumatico: ottima stabilità e precisione degli utensili • Sistema ZERO SYSTEM: riduce i problemi derivati da equilibratura, planarità ed eccentricità • Garantiscono un'ottima qualità di lavorazione abbinata ad un'elevata durata dell'utensile

Obtained from high quality steel • Easy change tools • Pneumatic system: high stability and precision of the tools • ZERO SYSTEM: resolves problems coming from alignment on the side, balancing and eccentricity • Provides excellent quality' processing combined with long tool life

● = Ready in stock ■ = Delivery time 20 working days △ = On request

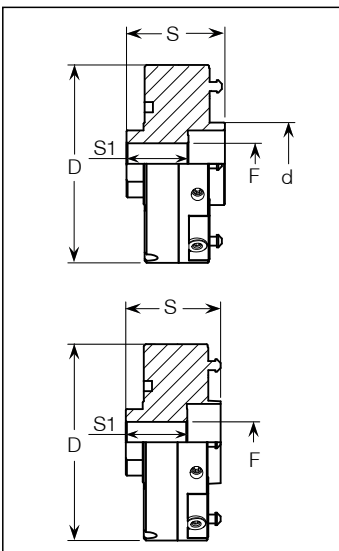

| D   | S  | S1 | F  | Pins  | d  | Code           | €        |
|-----|----|----|----|-------|----|----------------|----------|
| 160 | 96 | 60 | 35 | 4/130 | 60 | ■ BRSZ016035AA | 2.091,60 |
| 160 | 96 | 60 | 40 | 4/130 | 60 | ■ BRSZ016040AA | 2.091,60 |
| 192 | 96 | 60 | 35 | 4/130 | 80 | ■ BRSZ019235AA | 2.091,60 |
| 192 | 96 | 60 | 40 | 4/130 | 80 | ■ BRSZ019240AA | 2.091,60 |

| D     | S    | S1 | F  | Pins  | d  | Code           | €        |
|-------|------|----|----|-------|----|----------------|----------|
| 192   | 92,7 | 60 | 35 | 4/150 | 80 | ■ BRSZ019235AB | 2.226,60 |
| 192   | 92,7 | 60 | 40 | 4/150 | 80 | ■ BRSZ019240AB | 2.226,60 |
| Spec. |      |    |    |       |    | BRSZ099        |          |

### SPARE PARTS

| Type           | Code           | €      |
|----------------|----------------|--------|
| Pneumatic hose | ■ BSETRACCORDO | 162,00 |

### NOTE

■ Utensili non a magazzino, quantità minima d'ordine: **1 pezzo.**  
Tools not ready in stock minimum order quantity: **1 piece.**

Il prezzo include una chiave di regolazione.  
The price included one screwdrivers.

TAGLIO / SEZIONATURA  
SAWING

DIAMANTE  
DIAMOND

FRESATURA  
CUTTING

PANTOGRAFATURA  
ROUTING

FORATURA  
BORING

MANDRINI / ATTACCHI  
CHUCKS & CLAMPING SYSTEM

RICAMBI E LAVORAZIONI SUPP.  
SPARE PARTS & ADD. WORKING



