

**RICAMBI E LAVORAZIONI SUPPLEMENTARI  
SPARE PARTS AND ADDITIONAL WORKING  
ERSATZTEILE  
PIECES DE RECHANGE  
ЗАПАСНЫЕ ЧАСТИ И ПРИНАДЛЕЖНОСТИ**



**7**

SPARE PARTS AND ADDITIONAL WORKING

 <b>CS</b> p. 505	 <b>C010</b> p. 506	 <b>C011</b> p. 507	 <b>C013</b> p. 508	 <b>C003</b> p. 509	 <b>C004</b> p. 509
 <b>C005</b> p. 510	 <b>C016</b> p. 511	 <b>C017</b> p. 512	 <b>C019</b> p. 513	 <b>C020</b> p. 514	 <b>C022</b> p. 515
 <b>C024</b> p. 516	 <b>C025</b> p. 517	 <b>C028</b> p. 517	 <b>C030</b> p. 518	 <b>C032</b> p. 518	 <b>C035</b> p. 519
 <b>C040</b> p. 520	 <b>C040</b> p. 520	 <b>C040</b> p. 521	 <b>C042</b> p. 521	 <b>C044</b> p. 522	 <b>C046</b> p. 522
 <b>C047</b> p. 523	 <b>C048</b> p. 523	 <b>C207 - C208</b> p. 524	 <b>C207 - C208</b> p. 525	 <b>C206</b> p. 526	 <b>AA00</b> p. 527
 <b>ACH</b> p. 528	 <b>ACHET</b> p. 528	 <b>ACHTC</b> p. 528	 <b>ACHTT</b> p. 529	 <b>SUPP</b> p. 529	 <b>SUPP</b> p. 529
 <b>SUPP</b> p. 529	 <b>LAV</b> p. 530-531				

CS

## HWM Profile turnover knives



Coltelli sagomati in HW • Disponibili in diverse misure • Da applicare su teste e punte portacoltelli (art. TS e TPS)

HW profiled turnover knives • Available in different size • To mount on cutterheads TS and TPS

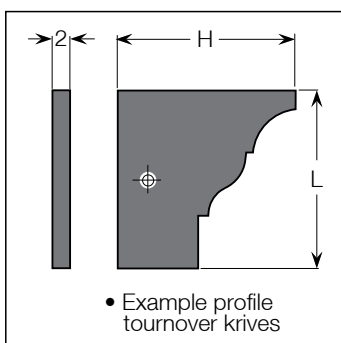

● = Ready in stock ■ = Delivery time 20 working days △ = On request

L	H	Code	€ per unit 6 pcs	€ per unit 12 pcs	€ per unit 24 pcs	€ per unit 48 pcs	€ per unit 99 pcs
20	20	■ CS00M2020AAA	20,60	19,40	16,80	15,20	13,60
20	25	■ CS00M2025AAA	21,20	20,00	17,20	15,60	14,20
20	30	■ CS00M2030AAA	22,80	21,80	18,80	17,20	15,60
20	35	■ CS00M2035AAA	25,00	23,80	20,80	19,20	17,80
25	20	■ CS00M2520AAA	21,80	20,60	17,80	16,20	14,60
25	25	■ CS00M2525AAA	22,80	21,80	18,80	17,20	15,60
25	30	■ CS00M2530AAA	25,00	23,80	20,80	19,20	17,80
25	35	■ CS00M2535AAA	27,20	26,20	23,00	21,40	19,80
30	20	■ CS00M3020AAA	22,80	21,20	18,80	17,20	15,60
30	25	■ CS00M3025AAA	24,40	23,40	20,40	18,80	17,20
30	30	■ CS00M3030AAA	26,80	25,60	22,40	20,80	18,00
30	35	■ CS00M3035AAA	31,00	30,00	26,60	25,00	22,00
30	40	■ CS00M3040AAA	33,80	32,80	29,20	20,40	24,20
35	20	■ CS00M3520AAA	24,40	23,40	20,40	18,80	16,00
35	25	■ CS00M3525AAA	26,80	25,60	22,40	20,80	18,00
35	30	■ CS00M3530AAA	30,00	28,80	25,60	24,00	20,80
35	35	■ CS00M3535AAA	33,40	32,20	28,80	27,00	23,80
35	40	■ CS00M3540AAA	36,00	35,00	31,20	29,60	26,20
40	20	■ CS00M4020AAA	26,80	25,60	22,40	20,80	18,00
40	25	■ CS00M4025AAA	30,00	28,80	25,60	24,00	20,80
40	30	■ CS00M4030AAA	33,40	32,20	28,80	27,00	23,80
40	35	■ CS00M4035AAA	36,00	35,00	31,20	29,60	26,20
40	40	■ CS00M4040AAA	38,80	37,80	34,20	32,20	28,60
40	45	■ CS00M4045AAA	41,60	40,60	36,40	35,00	31,20
50	20	■ CS00M5020AAA	30,00	28,80	25,60	24,00	20,80
50	25	■ CS00M5025AAA	33,40	32,20	28,80	27,00	23,80
50	30	■ CS00M5030AAA	36,00	35,00	31,20	29,60	26,20
50	35	■ CS00M5035AAA	38,80	37,80	33,80	32,20	28,20
50	40	■ CS00M5040AAA	41,60	40,60	36,40	35,00	30,60
50	45	■ CS00M5045AAA	44,40	43,20	39,00	37,40	33,00
50	50	■ CS00M5050AAA	47,20	46,00	41,60	40,00	35,80
60	20	■ CS00M6020AAA	33,40	31,00	26,60	25,00	22,00
60	25	■ CS00M6025AAA	36,00	33,80	29,20	27,60	24,20
60	30	■ CS00M6030AAA	39,40	36,60	31,80	30,20	26,80
60	35	■ CS00M6035AAA	42,60	40,60	35,00	33,40	29,60
60	40	■ CS00M6040AAA	46,00	43,80	38,00	36,40	32,60
80	20	■ CS00M8020AAA	49,40	47,20	42,00	40,60	35,00
80	25	■ CS00M8025AAA	52,20	49,80	44,80	43,20	38,40
80	30	■ CS00M8030AAA	54,40	52,20	47,40	46,00	41,60
80	35	■ CS00M8035AAA	58,80	56,40	51,00	49,40	44,20
80	40	■ CS00M8040AAA	65,40	63,20	57,20	55,60	50,00

Spec. CS00M99

■ Utensili non a magazzino, quantità minima d'ordine: 6 pezzi.  
Tools not ready in stock minimum order quantity: 6 pieces.

TAGLIO / SEZIONATURA  
SAWINGDIAMANTE  
DIAMONDFRESATURA  
CUTTINGPANTOGRAFATURA  
ROUTINGFORATURA  
BORINGMANDRINI / ATTACCHI  
CHUCKS & CLAMPING SYSTEMRICAMBI E LAVORAZIONI SUPP.  
SPARE PARTS & ADD. WORKING

Coltelli in HW  
per piallatrici

HW Streifenhobelmesser

Couteaux de  
dégauchisseuse HW

Фуговальные ножи с  
напайкой HW

**C010**

**HW Planing knives**



Rettificati e spogliati con ottimo grado di finitura • Disponibili in diverse misure • Indicati per lavorazioni su legno, suoi derivati, laminati e simili • Da montare su teste pialla art. T204 e T204H

Ground and polished with excellent finishing • Available in different sizes • Suitable for working wood, laminates and such • Can be used planer on cutterheads art.T204 and T204H



● = Ready in stock ■ = Delivery time 20 working days △ = On request

L	Code	€
60	■ C010M00600AA	19,40
80	■ C010M0080AAA	25,40
100	■ C010M0100AAA	30,00
110	■ C010M0110AAA	33,00
120	■ C010M0120AAA	36,40
130	■ C010M0130AAA	40,00
140	■ C010M0140AAA	42,20
150	■ C010M0150AAA	45,60
160	■ C010M0160AAA	48,00
170	■ C010M0170AAA	51,00
180	■ C010M0180AAA	54,00
200	■ C010M0200AAA	60,20
210	■ C010M0210AAA	63,80
230	■ C010M0230AAA	69,60
300	■ C010M0300AAA	90,00
350	■ C010M0350AAA	105,20
400	■ C010M0400AAA	120,40
410	■ C010M0410AAA	123,20
500	■ C010M0500AAA	150,00
510	■ C010M0510AAA	153,00
530	■ C010M0530AAA	159,40
600	■ C010M0600AAA	180,40
610	■ C010M0610AAA	183,20
630	■ C010M0630AAA	189,20
640	■ C010M0640AAA	192,00
710	■ C010M0710AAA	213,60
Spec.	C010M99	

■ Utensili non a magazzino, confezione da 2 coltelli.  
Tools not ready in stock 2 knives for each set.

TAGLIO / SEZIONATURA  
SAWING

DIAMANTE  
DIAMOND

FRESATURA  
CUTTING

PANTOGRAFATURA  
ROUTING

FORATURA  
BORING

MANDRINI / ATTACCHI  
CHUCKS & CLAMPING SYSTEM

RICAMBI E LAVORAZIONI SUPP.  
SPARE PARTS & ADD. WORKING

Coltelli in HS  
per piallatrici

HS Streifenhobelmesser

Couteaux de  
dégauchisseuse HS

Ножи фуговальные HS

**C011**

**HS Planing knives**



Rettificati e spogliati con ottimo grado di finitura • Disponibili in diverse misure • Indicati per lavorazioni su legno naturale  
• Da montare su teste pialla art. T204 e T204H

Ground and polished with excellent finishing • Available in different sizes • Suitable for working wood • Can be used planer on cutterheads art.T204 and T204H

● = Ready in stock ■ = Delivery time 20 working days △ = On request

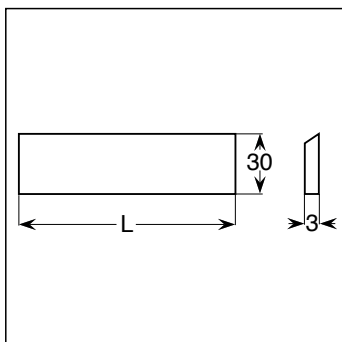

L	Code	€
60	● C011S0060AAA	5,20
80	● C011S0080AAA	7,00
100	● C011S0100AAA	8,20
110	● C011S0110AAA	8,60
120	● C011S0120AAA	7,60
130	● C011S0130AAA	8,40
140	● C011S0140AAA	11,00
150	● C011S0150AAA	9,60
160	● C011S0160AAA	13,20
170	● C011S0170AAA	13,80
180	● C011S0180AAA	11,40
200	● C011S0200AAA	16,00
210	● C011S0210AAA	16,60
230	● C011S0230AAA	14,60
240	● C011S0240AAA	19,00
300	● C011S0300AAA	19,00
350	● C011S0350AAA	22,20
400	● C011S0400AAA	25,40
410	● C011S0410AAA	26,00
500	● C011S0500AAA	31,60
510	● C011S0510AAA	30,40
530	● C011S0530AAA	33,60
600	● C011S0600AAA	38,00
610	● C011S0610AAA	48,20
630	● C011S0630AAA	40,00
640	● C011S0640AAA	52,40
710	● C011S0710AAA	54,60
800	● C011S0800AAA	58,00
1000	● C011S1000AAA	71,60

Spec. C011S99

● Utensili non a magazzino, confezione da 2 coltelli.  
Tools not ready in stock 2 knives for each set.

TAGLIO / SEZIONATURA  
SAWING

DIAMANTE  
DIAMOND

FRESATURA  
CUTTING

PANTOGRAFATURA  
ROUTING

FORATURA  
BORING

MANDRINI / ATTACCHI  
CHUCKS & CLAMPING SYSTEM

RICAMBI E LAVORAZIONI SUPP.  
SPARE PARTS & ADD. WORKING

Coltelli in HS  
per piallatrici

HS Streifenhobelmesser

Couteaux de  
dégauchisseuse HS

Ножи фугальные HS

**C013**

**HS Planing knives**



Rettificati e spogliati con ottimo grado di finitura • Disponibili in diverse misure • Indicati per lavorazioni su legno naturale  
• Da montare su teste pialla a fissaggio meccanico art.T204 and T204H

Ground and polished with excellent finishing • Available in different sizes • Suitable for working wood • Can be used on planer cutterheads art.T204 and T204H

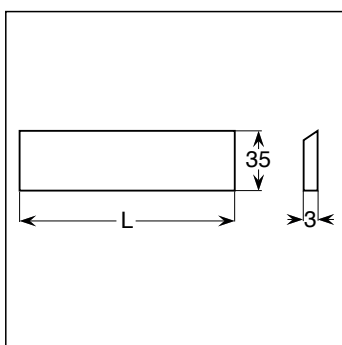

● = Ready in stock ■ = Delivery time 20 working days △ = On request

L	Code	€
60	● C013S0060AAA	5,80
80	● C013S0080AAA	7,00
100	● C013S0100AAA	8,60
110	● C013S0110AAA	9,20
120	● C013S0120AAA	9,00
130	● C013S0130AAA	9,40
140	● C013S0140AAA	11,60
150	● C013S0150AAA	11,40
160	● C013S0160AAA	13,80
170	● C013S0170AAA	15,00
180	● C013S0180AAA	13,60
200	● C013S0200AAA	17,20
210	● C013S0210AAA	17,80
230	● C013S0230AAA	17,40
300	● C013S0300AAA	22,60
350	● C013S0350AAA	26,40
400	● C013S0400AAA	31,00
410	● C013S0410AAA	31,70
500	● C013S0500AAA	37,80
510	● C013S0510AAA	38,40
530	● C013S0530AAA	40,00
600	● C013S0600AAA	45,20
610	● C013S0610AAA	52,40
630	● C013S0630AAA	47,60
640	● C013S0640AAA	56,80
710	● C013S0710AAA	59,20
800	● C013S0800AAA	60,20
1000	● C013S1000AAA	77,20
Spec.	C013S99	

● Confezione da 2 coltelli.  
2 knives for each set.

TAGLIO / SEZIONATURA  
SAWING

DIAMANTE  
DIAMOND

FRESATURA  
CUTTING

PANTOGRAFATURA  
ROUTING

FORATURA  
BORING

MANDRINI / ATTACCHI  
CHUCKS & CLAMPING SYSTEM

RICAMBI E LAVORAZIONI SUPP.  
SPARE PARTS & ADD. WORKING

**C003 HS Planing self positioning knives - Centrolock**



Rettificati e spogliati con ottimo grado di finitura • Disponibili in diverse misure • Indicati per lavorazioni su legno naturale • Da montare su teste pialla a fissaggio meccanico art.T207 and T207H

Ground and polished with excellent finishing • Available in different sizes • Suitable for working wood • Can be used on planer cutterheads art.T207 and T207H

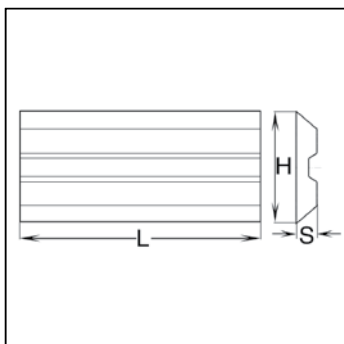

**HW** ● = Ready in stock ■ = Delivery time 20 working days △ = On request

L	H	S	Code	€
100	16	3	● C003S100AAAA	14,20
130	16	3	● C003S130AAAA	14,40
150	16	3	● C003S150AAAA	16,60
180	16	3	● C003S180AAAA	20,80
210	16	3	● C003S210AAAA	24,40
230	16	3	● C003S230AAAA	25,40
240	16	3	● C003S240AAAA	26,60
650	16	3	■ C003S650AAAA	71,00

Spec. C003S99

● Confezione da 2 coltelli.  
2 knives for each set.

**C004 HW Planing self positioning knives - Centrolock**

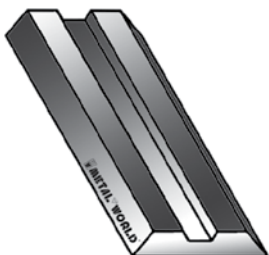

Rettificati e spogliati con ottimo grado di finitura • Disponibili in diverse misure • Indicati per lavorazioni su legno naturale • Da montare su teste pialla a fissaggio meccanico art.T207 and T207H

Ground and polished with excellent finishing • Available in different sizes • Suitable for working wood • Can be used on planer cutterheads art.T207 and T207H

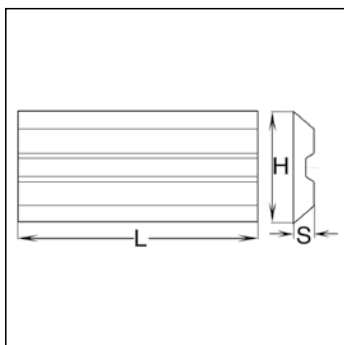

● = Ready in stock ■ = Delivery time 20 working days △ = On request

L	H	S	Code	€
100	16	3	■ C004M100AAAA	45,00
130	16	3	● C004M130AAAA	56,00
150	16	3	● C004M150AAAA	61,80
180	16	3	● C004M180AAAA	66,00
210	16	3	■ C004M210AAAA	80,40
230	16	3	● C004M230AAAA	86,60
240	16	3	● C004M240AAAA	97,00

Spec. C004M99

● Confezione da 2 coltelli.  
2 knives for each set.

# C005

# HS Planing self positioning knives - Tersa

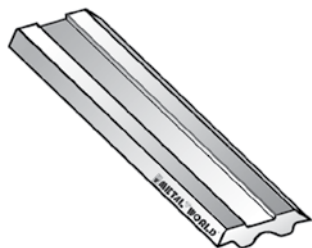

Rettificati e spogliati con ottimo grado di finitura • Disponibili in diverse misure • Indicati per lavorazioni su legno naturale  
• Da montare su teste pialla a fissaggio meccanico

Ground and polished with excellent finishing • Available in different sizes • Suitable for working wood • Can be used on planer cutterheads

● = Ready in stock ■ = Delivery time 20 working days △ = On request

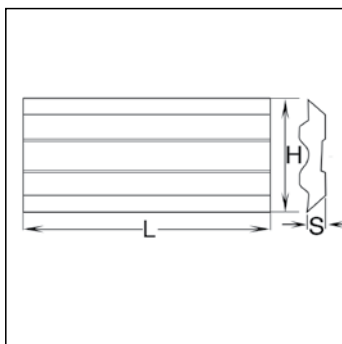

L	H	S	Code	€
80	10	2,3	■ C005S080AAAA	6,20
100	10	2,3	■ C005S100AAAA	7,80
110	10	2,3	■ C005S110AAAA	8,40
120	10	2,3	■ C005S120AAAA	9,20
130	10	2,3	■ C005S130AAAA	9,80
150	10	2,3	■ C005S150AAAA	11,00
170	10	2,3	■ C005S170AAAA	12,00
180	10	2,3	■ C005S180AAAA	12,60
210	10	2,3	■ C005S210AAAA	14,60
230	10	2,3	■ C005S230AAAA	15,20
250	10	2,3	■ C005S250AAAA	15,80
260	10	2,3	■ C005S260AAAA	16,40
300	10	2,3	■ C005S300AAAA	18,60
310	10	2,3	■ C005S310AAAA	19,20
350	10	2,3	■ C005S350AAAA	21,20
400	10	2,3	■ C005S400AAAA	23,20
410	10	2,3	■ C005S410AAAA	23,80
420	10	2,3	■ C005S420AAAA	24,40
430	10	2,3	■ C005S430AAAA	25,00
450	10	2,3	■ C005S450AAAA	26,40
500	10	2,3	■ C005S500AAAA	29,60
510	10	2,3	■ C005S510AAAA	30,20
520	10	2,3	■ C005S520AAAA	30,80
530	10	2,3	■ C005S530AAAA	31,00
540	10	2,3	■ C005S540AAAA	31,60
610	10	2,3	■ C005S610AAAA	35,40
630	10	2,3	■ C005S630AAAA	36,00
635	10	2,3	■ C005S635AAAA	36,80
640	10	2,3	■ C005S640AAAA	38,00
650	10	2,3	■ C005S650AAAA	39,00
710	10	2,3	■ C005S710AAAA	42,60

Spec.

C005S99

■ Utensili non a magazzino, confezione da 2 coltelli.  
Tools not ready in stock 2 knives for each set.



# C016

## HWM Reversible knives



Rettificati e spogliati con ottimo grado di finitura • Disponibili in diverse misure • Indicati per lavorazioni su truciolari, laminati e simili • Da montare su utensili a fissaggio meccanico

Ground and polished with excellent finishing • Available in different sizes • Suitable for working chipboard, laminated and such • Can be used on cutterheads

● = Ready in stock ■ = Delivery time 20 working days △ = On request

L	H	S	X	Mod.	Code	€
7,5	9	1,5		A	● C016M07509AA	7,00
9,6	9	1,5		A	● C016M09609AA	8,20
12*	9	1,5		A	● C016M12009AA	7,20
14,6	9	1,5		A	● C016M14609AA	8,80
20	9	1,5		A	● C016M20009AA	3,40
30	9	1,5	14	B	● C016M30009BA	7,20
40	9	1,5	26	B	● C016M40009BA	7,40
49,5**	9	1,5	26	B	● C016M49509AA	7,80
50	9	1,5	26	B	● C016M50009BA	6,00
60	9	1,5	26	B	● C016M60009BA	7,20

Spec.					C016M99	
-------	--	--	--	--	---------	--

- \* Coltelli L=12 mm spogliati su 4 lati
- \* Knives L=12 mm with 4 cleared side angles
- \*\* Coltelli L=49,5 mm spogliati su 3 lati
- \*\* Knives L=49,5 mm with 3 cleared side angles

● Confezione da **10 coltelli.**  
**10 knives for each set.**

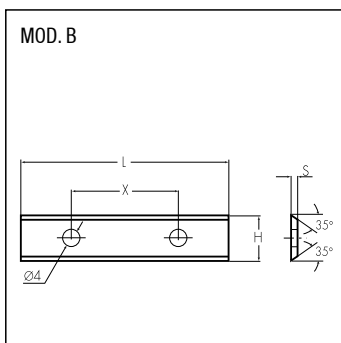
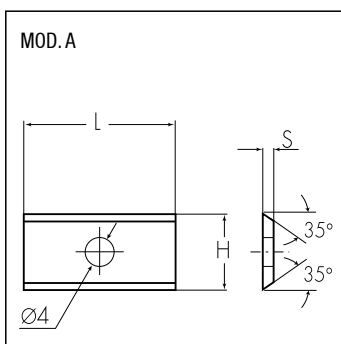

TAGLIO / SEZIONATURA  
SAWING

DIAMANTE  
DIAMOND

FRESATURA  
CUTTING

PANTOGRAFATURA  
ROUTING

FORATURA  
BORING

MANDRINI / ATTACCHI  
CHUCKS & CLAMPING SYSTEM

RICAMBI E LAVORAZIONI SUPP.  
SPARE PARTS & ADD. WORKING

# C017

## HWM Reversible knives



Rettificati e spogliati con ottimo grado di finitura • Disponibili in diverse misure • Indicati per lavorazioni su legno naturali teneri • Da montare su utensili a fissaggio meccanico

Ground and polished with excellent finishing • Available in different sizes • Suitable for working soft wood • Can be used on cutterheads

TAGLIO / SEZIONATURA  
SAWING



DIAMANTE  
DIAMOND

FRESATURA  
CUTTING

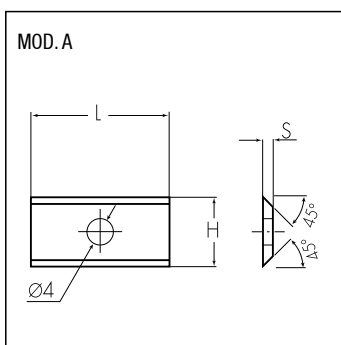

PANTOGRAFATURA  
ROUTING

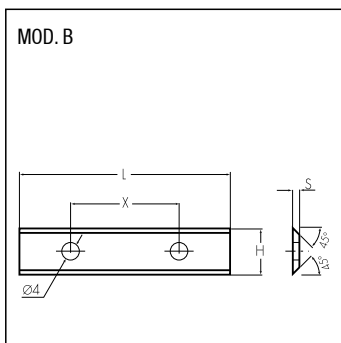

FORATURA  
BORING

MANDRINI / ATTACCHI  
CHUCKS & CLAMPING SYSTEM

RICAMBI E LAVORAZIONI SUPP.  
SPARE PARTS & ADD. WORKING

● = Ready in stock ■ = Delivery time 20 working days △ = On request

L	H	S	X	Mod.	Code	€
7,5	12	1,5		A	● C017M07512AA	3,60
9,6	12	1,5		A	● C017M09612AA	5,80
12	12	1,5		A	● C017M12012AA	4,40
15	12	1,5		A	● C017M15012AA	4,20
20	12	1,5		A	● C017M20012AA	4,40
30	12	1,5	14	B	● C017M30012BA	4,80
40	12	1,5	26	B	● C017M40012BA	6,80
50	12	1,5	26	B	● C017M50012BA	6,80
60	12	1,5	26	B	● C017M60012BA	9,80

Spec.

C017M99

\* Coltelli L=12 mm spogliati su 4 lati  
\* Knives L=12 mm with 4 cleared side angles

● Confezione da **10 coltelli.**  
**10 knives for each set.**

# C019

## HWM Reversible knives



Rettificati e spogliati con ottimo grado di finitura • Disponibili in diverse misure • Indicati per lavorazioni su legni naturali  
• Da montare su utensili a fissaggio meccanico

Ground and polished with excellent finishing • Available in different sizes • Suitable for working wood • Can be used on cutterheads

● = Ready in stock ■ = Delivery time 20 working days △ = On request

L	H	S	X	Mod.	Code	€
12	12	1,5		A	● C019M12012AA	<b>3,00</b>
20	12	1,5		A	● C019M20012AA	<b>2,80</b>
30	12	1,5	14	B	● C019M30012BA	<b>4,40</b>
40	12	1,5	26	B	● C019M40012BA	<b>6,40</b>
50	12	1,5	26	B	● C019M50012BA	<b>6,00</b>
60	12	1,5	26	B	● C019M60012BA	<b>8,00</b>
Spec.					C019M99	

\* Coltelli L=12 mm spogliati su 4 lati  
\* Knives L=12 mm with 4 cleared side angles

● Confezione da **10 coltelli.**  
**10 knives for each set.**

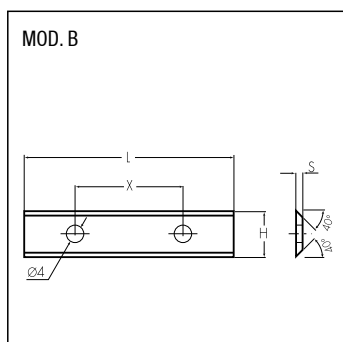
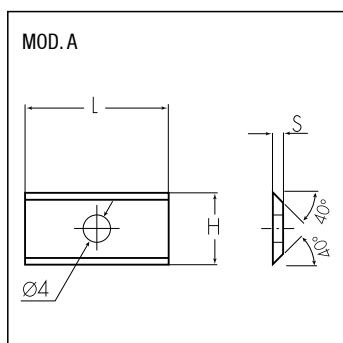

TAGLIO / SEZIONATURA  
SAWING

DIAMANTE  
DIAMOND

FRESATURA  
CUTTING

PANTOGRAFATURA  
ROUTING

FORATURA  
BORING

MANDRINI / ATTACCHI  
CHUCKS & CLAMPING SYSTEM

RICAMBI E LAVORAZIONI SUPP.  
SPARE PARTS & ADD. WORKING

# C020

## HWM Reversible knives



Rettificati e spogliati con ottimo grado di finitura • Disponibili in diverse misure • Indicati per lavorazioni su truciolari, laminati e simili

Ground and polished with excellent finishing • Available in different sizes • Suitable for working chipboard, laminated and such • Can be used on cutterheads

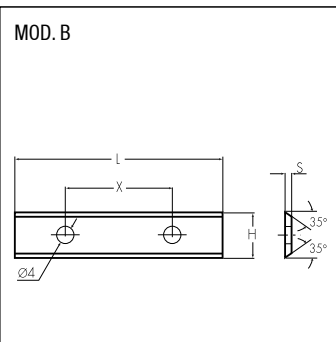
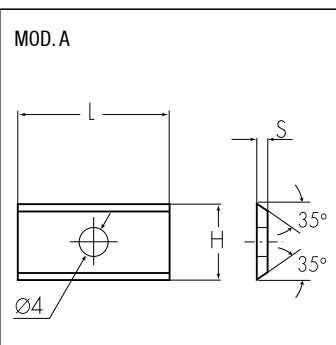

● = Ready in stock ■ = Delivery time 20 working days △ = On request

L	H	S	X	Mod.	Code	€
7,5	12	1,5		A	● C020M07512AA	2,00
9,6	12	1,5		A	● C020M09612AA	2,40
12	12	1,5		A	● C020M12012AA	2,20
15	12	1,5		A	● C020M15012AA	2,40
20	12	1,5		A	● C020M20012AA	2,80
25	12	1,5			● C020M25012AA	3,60
30	12	1,5	14	B	● C020M30012AB	3,40
40	12	1,5	26	B	● C020M40012AB	4,00
50	12	1,5	26	B	● C020M50012AB	4,60
60	12	1,5	26	B	● C020M60012AB	5,40
80	13	2,2	60	B	● C020M80013AB	18,20
100	13	2,2	60	B	■ C020M100013B	29,40
120	13	2,2	60	B	■ C020M120013B	35,20

Spec.

C020M99

\* Coltelli L=12 mm spogliati su 4 lati  
\* Knives L=12 mm with 4 cleared side angles

● Confezione da **10 coltelli.**  
**10 knives for each set.**

# C022

## HWM Reversible knives



Rettificati e spogliati con ottimo grado di finitura • Disponibili in diverse misure • Buona tenuta di taglio • Indicati per lavorazioni su truciolari, laminati e simili

Ground and polished with excellent finishing • Available in different sizes • Good tool life • Suitable for working chipboard, laminated and such • Can be used on cutterheads

● = Ready in stock ■ = Delivery time 20 working days △ = On request

L	H	S	X	Mod.	Code	€
7,5	12	1,5		A	● C022M07512AA	4,20
12	12	1,5		A	● C022M01212AA	2,20
15	12	1,5		A	● C022M01512AA	5,20
20	12	1,5		A	● C022M02012AA	3,60
30	12	1,5	14	B	● C022M03012BA	3,80
50	12	1,5	26	B	● C022M05012BA	4,80
60	12	1,5	26	B	● C022M06012BA	7,40
Spec.					C022M99	

\* Coltelli L=12 mm spogliati su 4 lati  
\* Knives L=12 mm with 4 cleared side angles

● Confezione da **10 coltelli.**  
**10 knives for each set.**

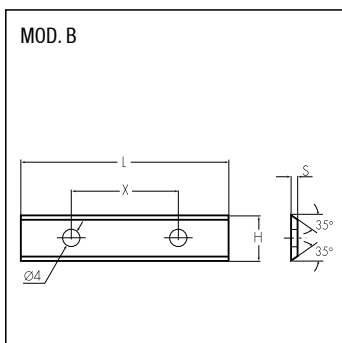
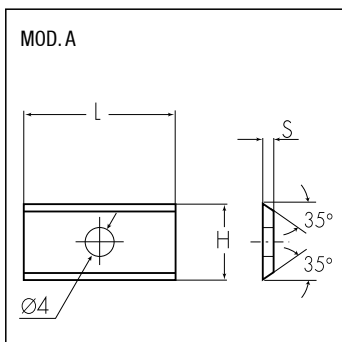

TAGLIO / SEZIONATURA  
SAWING

DIAMANTE  
DIAMOND

FRESATURA  
CUTTING

PANTOGRAFATURA  
ROUTING

FORATURA  
BORING

MANDRINI / ATTACCHI  
CHUCKS & CLAMPING SYSTEM

RICAMBI E LAVORAZIONI SUPP.  
SPARE PARTS & ADD. WORKING

# C024

## HWM Reversible knives - High efficiency



Rettificati e spogliati con ottimo grado di finitura • Disponibili in diverse misure • Elevata tenuta di taglio • Indicati per lavorazioni su truciolari, laminati e simili

Ground and polished with excellent finishing • Available in different sizes • Excellent tool life • Suitable for working chipboard, laminated and such • Can be used on cutterheads

TAGLIO / SEZIONATURA  
SAWING

DIAMANTE  
DIAMOND

FRESATURA  
CUTTING

PANTOGRAFATURA  
ROUTING

FORATURA  
BORING

MANDRINI / ATTACCHI  
CHUCKS & CLAMPING SYSTEM

RICAMBI E LAVORAZIONI SUPP.  
SPARE PARTS & ADD. WORKING

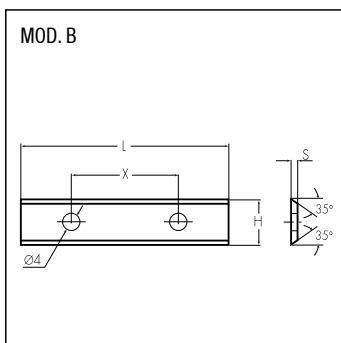
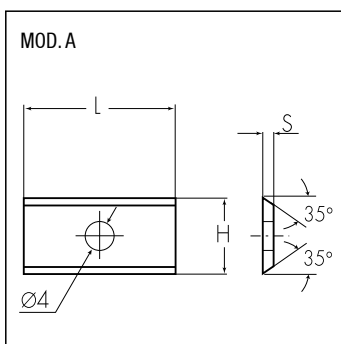

● = Ready in stock   ■ = Delivery time 20 working days   △ = On request

L	H	S	X	Mod.	Code	€
20	12	1,5		A	● C024M02012AA	<b>3,80</b>
30	12	1,5	14	B	● C024M03012BA	<b>4,20</b>
50	12	1,5	26	B	● C024M05012BA	<b>6,40</b>
Spec.					C024M99	

\* Coltelli L=12 mm spogliati su 4 lati  
\* Knives L=12 mm with 4 cleared side angles

● Confezione da **10 coltelli.**  
**10 knives for each set.**

Coltelli reversibili in HWM spogliati di testa

HWM Wendeplatten

HWM Couteaux réversibles

Сменные ножи HWM



**C025 HWM Reversible knives - Sides cleared**



Rettificati e spogliati con ottimo grado di finitura • Spogliati frontalmente con possibilità di taglio sui 4 lati • Disponibili in diverse misure • Indicati in lavorazioni con esigenza di taglio frontale su truciolari, laminati e simili

Ground and polished with excellent finishing • Bottom clearance angle, all 4 sides can cut • Available in different sizes • Good tool life • Indicated for frontal cutting chipboard, laminated and such

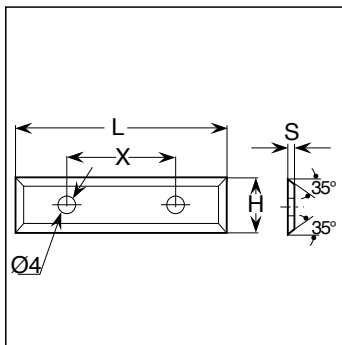

● = Ready in stock   ■ = Delivery time 20 working days   △ = On request

L	H	S	X	Code	€
29,5	12	1,5	14	● C025M29512AB	5,20
39,5	12	1,5		● C025M39512AB	7,40
49,5	12	1,5	26	● C025M49512AB	6,40

Spec. C025M99  
 ● Confezione da 10 coltelli.  
 10 knives for each set.

TAGLIO / SEZIONATURA  
SAWING

DIAMANTE  
DIAMOND

FRESATURA  
CUTTING

Coltelli reversibili in HWM

HWM Wendeplatten

HWM Couteaux réversibles

Сменные ножи HWM

**C028 HWM Reversible knives**



Rettificati e spogliati con ottimo grado di finitura • Disponibili in diverse misure • Indicati per lavorazioni su legni naturali • Da montare su utensili a fissaggio meccanico

Ground and polished with excellent finishing • Available in different sizes • Suitable for working wood • Can be used on cutterheads

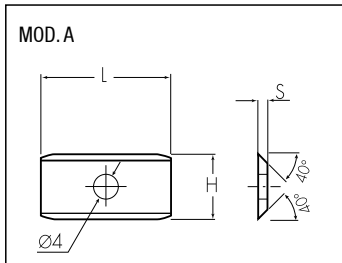

● = Ready in stock   ■ = Delivery time 20 working days   △ = On request

L	H	S	X	Mod.	Code	€
24	12	1,5		A	● C028M02412AA	5,20
50	12	1,5	26	B	● C028M05012AB	7,00

Spec. C028M99

● Confezione da 10 coltelli.  
 10 knives for each set.

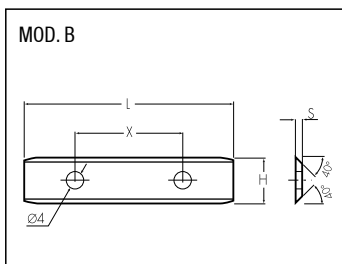

PANTOGRAFATURA  
ROUTING

FORATURA  
BORING

MANDRINI / ATTACCHI  
CHUCKS & CLAMPING SYSTEM

RICAMBI E LAVORAZIONI SUPP.  
SPARE PARTS & ADD. WORKING

Mini coltelli reversibili  
in HWM

HWM Miniwendeplatten

HWM Mini couteaux  
réversibles

Сменные ножи HWM

**C030**

**HWM Reversible knives**

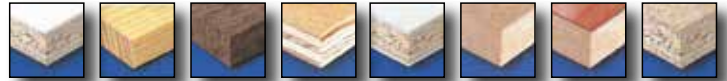

Rettificati e spogliati con ottimo grado di finitura • Disponibili in diverse misure • Da montare su punte pantografo a fissaggio meccanico.

Ground and polished with excellent finishing • Available in different sizes • Suitable for working wood • Can be used on router bit cutterheads



● = Ready in stock ■ = Delivery time 20 working days △ = On request

L	H	S	Code	€
12	5,5	1,1	● C030M01255AA	<b>3,60</b>
20	5,5	1,1	● C030M02055AA	<b>5,00</b>
30	5,5	1,1	● C030M03055AA	<b>5,60</b>
40	5,5	1,1	● C030M04055AA	<b>5,60</b>
50	5,5	1,1	● C030M05055AA	<b>6,60</b>
Spec.			C030M99	

● Confezione da **10 coltelli.**  
**10 knives for each set.**

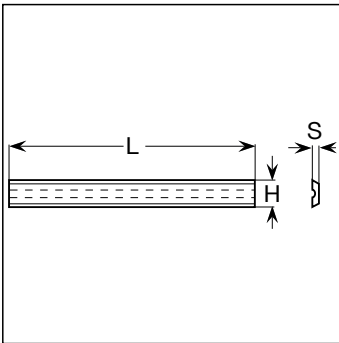

Mini coltelli reversibili  
in HWM

HWM Miniwendeplatten

HWM Mini couteaux  
réversibles

Сменные ножи HWM

**C032**

**HWM Reversible knives**

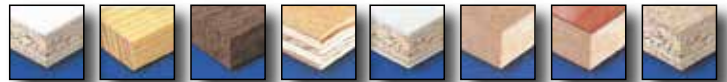

Rettificati e spogliati con ottimo grado di finitura • Disponibili in diverse misure • Da montare su punte pantografo a fissaggio meccanico

Ground and polished with excellent finishing • Available in different sizes • Suitable for working wood • Can be used on router bit cutterheads



● = Ready in stock ■ = Delivery time 20 working days △ = On request

L	H	S	Code	€
12	5,5	1,1	● C032M01255AA	<b>4,20</b>
20	5,5	1,1	● C032M02055AA	<b>4,80</b>
30	5,5	1,1	● C032M03055AA	<b>5,60</b>
40	5,5	1,1	● C032M04055AA	<b>5,60</b>
50	5,5	1,1	● C032M05055AA	<b>6,60</b>
82	5,5	1,1	● C032M08255AA	<b>4,60</b>
Spec.			C032M99	

● Confezione da **10 coltelli.**  
**10 knives for each set.**

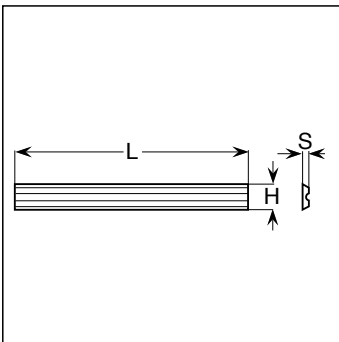

TAGLIO / SEZIONATURA  
SAWING

DIAMANTE  
DIAMOND

FRESATURA  
CUTTING

PANTOGRAFATURA  
ROUTING

FORATURA  
BORING

MANDRINI / ATTACCHI  
CHUCKS & CLAMPING SYSTEM

RICAMBI E LAVORAZIONI SUPP.  
SPARE PARTS & ADD. WORKING





# C035 HWM Reversible knives



Rettificati e spogliati con ottimo grado di finitura • Spogliati frontalmente con possibilità di taglio sui 4 lati • Disponibili in diverse misure • Da montare su punte pantografo a fissaggio meccanico

Ground and polished with excellent finishing • Bottom clearance angle, all 4 sides can cut • Available in different sizes • To mount on router bits cutterheads

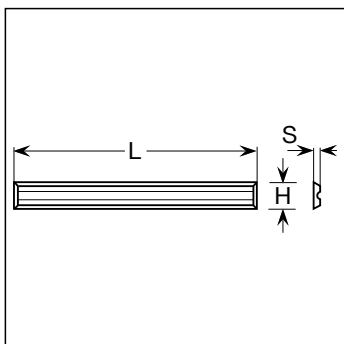

● = Ready in stock ■ = Delivery time 20 working days △ = On request

L	H	S	Code	€
29,5	5,5	1,1	■ C035M2955AA	7,60
49,5	5,5	1,1	■ C035M4955AA	8,60
Spec.			C035M99	

● Confezione da **10 coltelli.**  
**10 knives for each set.**

TAGLIO / SEZIONATURA  
SAWING

DIAMANTE  
DIAMOND

FRESATURA  
CUTTING

PANTOGRAFATURA  
ROUTING

FORATURA  
BORING

MANDRINI / ATTACCHI  
CHUCKS & CLAMPING SYSTEM

RICAMBI E LAVORAZIONI SUPP.  
SPARE PARTS & ADD. WORKING

Rasanti reversibili  
in HWM

HWM Vorschneider

HWM Araseurs  
réversibles

Сменные ножи HWM

**C040**

**HWM Reversible spurs**

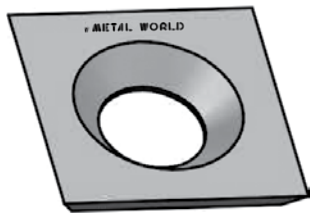

Rettificati e spogliati con ottimo grado di finitura • Spogliati sui 4 lati • Disponibili in diverse misure • Da montare su utensili a fissaggio meccanico

Ground and polished with excellent finishing • 4 sides clearance angle • Available in different sizes • To mount on cutterheads

● = Ready in stock ■ = Delivery time 20 working days △ = On request

L	H	S	Code	€
14	14	1,2	● C040M14012AA	2,40
14	14	2	● C040M14020AA	2,40
Spec.			C040M99	

● Confezione da **10 coltelli.**  
**10 knives for each set.**

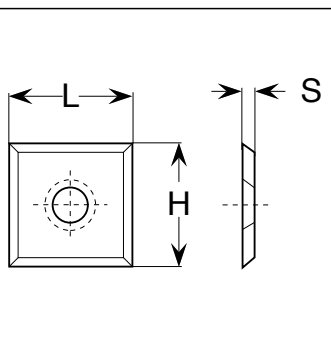

TAGLIO / SEZIONATURA  
SAWING

DIAMANTE  
DIAMOND

FRESATURA  
CUTTING

PANTOGRAFATURA  
ROUTING

FORATURA  
BORING

MANDRINI / ATTACCHI  
CHUCKS & CLAMPING SYSTEM

RICAMBI E LAVORAZIONI SUPP.  
SPARE PARTS & ADD. WORKING

Coltelli reversibili  
in HWM

HWM Wendemesser

HWM Couteaux  
réversibles

Сменные ножи HWM

**C040**

**HWM Reversible knives**

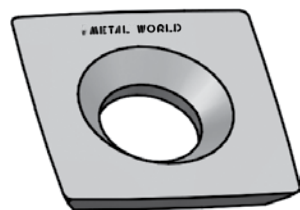

Rettificati e spogliati con ottimo grado di finitura • Spogliati sui 4 lati • Disponibili in diverse misure • Da montare su utensili a fissaggio meccanico

Ground and polished with excellent finishing • 4 sides clearance angle • Available in different sizes • To mount on cutterheads

● = Ready in stock ■ = Delivery time 20 working days △ = On request

L	H	S	R	Code	€
15	15	2,5	150	● C040M15025AA	5,20
Spec.			C040M99		

● Confezione da **10 coltelli.**  
**10 knives for each set.**

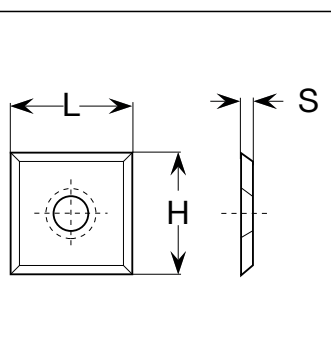



**C040** **HWM Reversible knives**

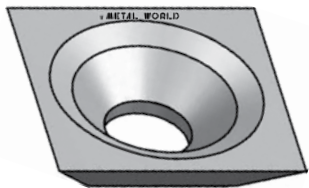

Rettificati e spogliati con ottimo grado di finitura • Spogliati sui 4 lati • Disponibili in diverse misure • Da montare su utensili a fissaggio meccanico

Ground and polished with excellent finishin • 4 sides clearance angle • Available in different sizes • To mount on cutterheads

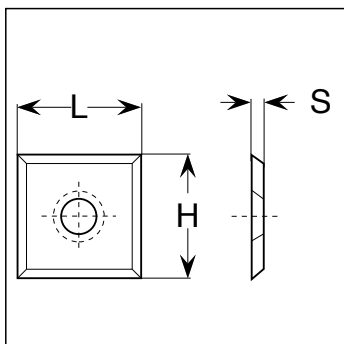

● = Ready in stock ■ = Delivery time 20 working days △ = On request

L	H	S	Code	€
21	21	5,5	● C040M21055AA	11,20

Spec. C040M99

● Confezione da 10 coltelli.  
10 knives for each set.

TAGLIO / SEZIONATURA  
SAWING

DIAMANTE  
DIAMOND

FRESATURA  
CUTTING

**C042** **HWM Triangular spurs**



Rettificati e spogliati con ottimo grado di finitura • Disponibili in diverse misure • Da montare su utensili a fissaggio meccanico

Ground and polished with excellent finishing • Available in different sizes • To mount on cutterheads

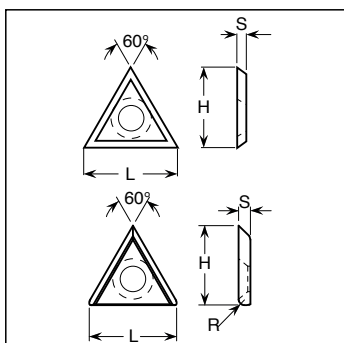

● = Ready in stock ■ = Delivery time 20 working days △ = On request

L	H	S	Code	€
22	19	2	● C042M220190A	3,80

Spec. C042M99

L	H	S	R	Code	€
21,9	19	2,5	1,5	● C042M219250A	9,80

Spec. C042M99

● Confezione da 10 coltelli.  
10 knives for each set.

PANTOGRAFATURA  
ROUTING

FORATURA  
BORING

MANDRINI / ATTACCHI  
CHUCKS & CLAMPING SYSTEM

RICAMBI E LAVORAZIONI SUPP.  
SPARE PARTS & ADD. WORKING



**Inserti reversibili in HWM per smussare e raggiare**

**HWM Fase und Abrundmesser**

**HWM Plaquettes réversibles pour chanfreiner et arrondir**

**Сменные ножи HWM**

TAGLIO / SEZIONATURA SAWING

DIAMANTE DIAMOND

FRESATURA CUTTING

PANTOGRAFATURA ROUTING

FORATURA BORING

MANDRINI / ATTACCHI CHUCKS & CLAMPING SYSTEM

RICAMBI E LAVORAZIONI SUPP. SPARE PARTS & ADD. WORKING

# C044

## HWM Beveling and rounding inserts



Rettificati e spogliati con ottimo grado di finitura • Disponibili in diverse misure • Da montare su utensili a fissaggio meccanico

Ground and polished with excellent finishing • Available in different sizes • To mount on cutterheads

● = Ready in stock ■ = Delivery time 20 working days △ = On request

L	H	S	R	Code	€
16	22	5	1,5	● C044M220R15A	20,60
16	22	5	2	● C044M220R20A	20,60
16	22	5	3	● C044M220R30A	20,60

Spec. C044M99

L	H	S	B	Code	€
16	22	5	45°	● C044M220AASA	20,60

Spec. C044M99

● Confezione da 10 coltelli.  
10 knives for each set.

**Inserti per incastri in HWM**

**HWM Nutmesser**

**HWM Plaquettes à rainier**

**Сменные режущие пластины HWM**

# C046

## HWM Reversible grooving inserts



Rettificati e spogliati con ottimo grado di finitura • Disponibili in diverse misure • Da montare su utensili a fissaggio meccanico

Ground and polished with excellent finishing • Available in different sizes • To mount on cutterheads

● = Ready in stock ■ = Delivery time 20 working days △ = On request

S	H	L	Left Code	Right Code	€
3	16	40	● C046M03AAAAL	● C046M03AAAAR	35,80
4	16	40	● C046M04AAAAL	● C046M04AAAAR	25,00
5	16	40	● C046M05AAAAL	● C046M05AAAAR	25,80
6	16	40	● C046M06AAAAL	● C046M06AAAAR	42,00

Spec. C046M99L C046M99R

● Confezione da 5 coltelli.  
5 knives for each set.

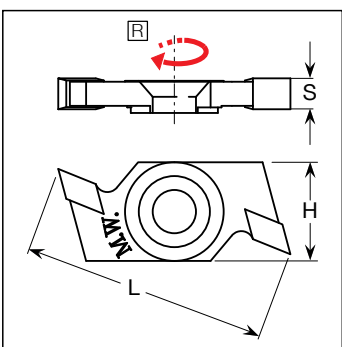

Inserti per incastri in HWM

HWM Nutmesser

HWM Plaquettes à rainer

Сменные режущие пластины HWM



**C047 HWM Grooving inserts**



Rettificati e spogliati con ottimo grado di finitura • Disponibili in diverse misure • Da montare su utensili a fissaggio meccanico

Ground and polished with excellent finishing • Available in different sizes • To mount on cutterheads

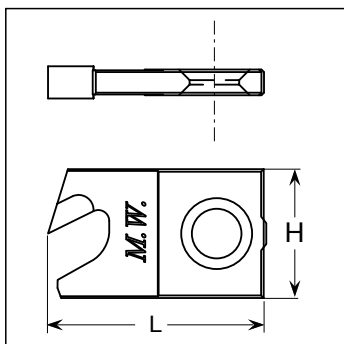

● = Ready in stock ■ = Delivery time 20 working days △ = On request

S	H	L	Code	€
3	20	25,6	● C047M250030A	32,20
4	20	25,6	● C047M250040A	34,00
5	20	25,6	● C047M250050A	35,00
6	20	25,6	● C047M250060A	36,00
Spec.			C047M99	

● Confezione da 5 coltelli.  
5 knives for each set.

TAGLIO / SEZIONATURA  
SAWING

DIAMANTE  
DIAMOND

FRESATURA  
CUTTING

Inserti per incastri in HWM

HWM Nutmesser

HWM Plaquettes à rainer

Сменные режущие пластины HWM

**C048 HWM Grooving inserts**



Rettificati e spogliati con ottimo grado di finitura • Disponibili in diverse misure • Da montare su utensili a fissaggio meccanico

Ground and polished with excellent finishing • Available in different sizes • To mount on cutterheads

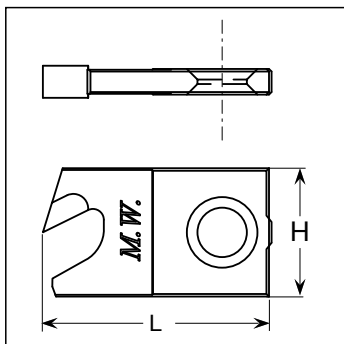

● = Ready in stock ■ = Delivery time 20 working days △ = On request

S	H	L	Code	€
3	20	35,6	● C048M350030A	37,60
4	20	35,6	● C048M350040A	41,20
5	20	35,6	● C048M350050A	43,40
6	20	35,6	● C048M350060A	44,60
Spec.			C048M99	

● Confezione da 5 coltelli.  
5 knives for each set.

PANTOGRAFATURA  
ROUTING

FORATURA  
BORING

MANDRINI / ATTACCHI  
CHUCKS & CLAMPING SYSTEM

RICAMBI E LAVORAZIONI SUPP.  
SPARE PARTS & ADD. WORKING



Coltelli HW profilabili  
per teste T206-T206H-T206W



HW Blanketts  
Rückenverzahnt  
für T206-T206H-T206W



Plaquettes HW de rechange  
por porte-outils  
T206-T206H-T206W



Ножи HW под  
профилирования для головок  
T206-T206H-T206W

## C207/208

## HW Profilable knives for T206-T206H-T206W cutterheads



Coltelli in HW zigrinati (spessore mm 8) • Disponibili in diverse misure • Fornibili grezzi o profilati • Indicati per la lavorazione di legni massicci • Da montare su teste portacoltelli T206-T206H-T206W

HW knurled knives (thickness 8 mm) • Available in different sizes • Supplied profiled or not profiled • Suitable for working solid wood • To mount on cutterheads T206-T206H-T206W

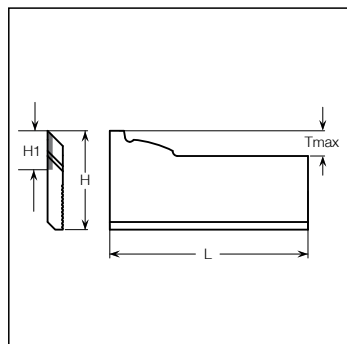
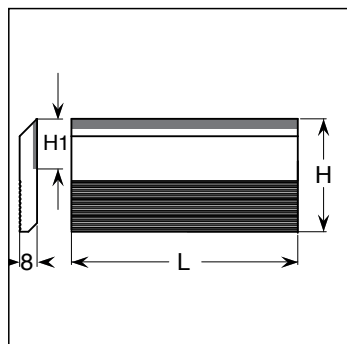

H	H1	Tmax
50	15	7
50	20	12
60	25	17

### NOT PROFILED KNIVES

● = Ready in stock ■ = Delivery time 20 working days △ = On request

L	H	H1	S	Code	€
60	50	15	8	■ C207M0605015	54,00
80	50	15	8	■ C207M0805015	70,40
100	50	15	8	■ C207M1005015	87,00
130	50	15	8	■ C207M1305015	114,00
150	50	15	8	■ C207M1505015	130,60
180	50	15	8	■ C207M1805015	157,40
230	50	15	8	■ C207M2305015	200,80
60	60	25	8	■ C207M0606025	64,20
80	60	25	8	■ C207M0806025	85,00
100	60	25	8	■ C207M1006025	105,60
130	60	25	8	■ C207M1306025	136,80
150	60	25	8	■ C207M1506025	159,40
180	60	25	8	■ C207M1806025	190,60
230	60	25	8	■ C207M2306025	242,20
Spec.				■ C207M99	

### NOT PROFILED KNIVES

L	H	H1	S	Code	€
60	50	20	8	■ C208M0605020	58,00
80	50	20	8	■ C208M0805020	76,60
100	50	20	8	■ C208M1005020	97,40
130	50	20	8	■ C208M1305020	126,40
150	50	20	8	■ C208M1505020	145,00
180	50	20	8	■ C208M1805020	174,00
230	50	20	8	■ C208M2305020	221,60
Spec.				■ C208M99	

### NOTE

■ Utensili non a magazzino, quantità minima d'ordine: **2 pezzi.**  
Tools not ready in stock minimum order quantity: **2 pieces.**

TAGLIO / SEZIONATURA  
SAWING

DIAMANTE  
DIAMOND

FRESATURA  
CUTTING

PANTOGRAFATURA  
ROUTING

FORATURA  
BORING

MANDRINI / ATTACCHI  
CHUCKS & CLAMPING SYSTEM

RICAMBI E LAVORAZIONI SUPP.  
SPARE PARTS & ADD. WORKING



# C207/208 HW Profilable knives for T206-T206H-T206W cutterheads



Coltelli in HW zigrinati (spessore mm 8) • Disponibili in diverse misure • Fornibili grezzi o profilati • Indicati per la lavorazione di legni massicci • Da montare su teste portacoltelli T206-T206H-T206W

HW knurled knives (thickness 8 mm) • Available in different sizes • Supplied profiled or not profiled • Suitable for working solid wood • To mount on cutterheads T206-T206H-T206W

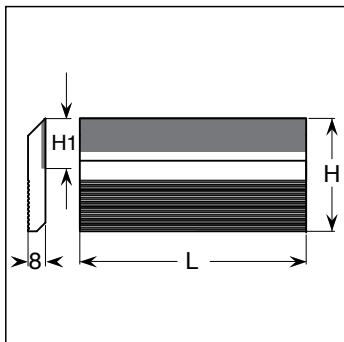

### NOT PROFILED KNIVES

● = Ready in stock ■ = Delivery time 20 working days △ = On request

L	H	H1	S	Code	€
60	70	30	8	● C208M0607030	72,60
80	70	30	8	● C208M0807030	97,40
100	70	30	8	● C208M1007030	120,20
130	70	30	8	● C208M1307030	157,40
150	70	30	8	● C208M1507030	180,20
180	70	30	8	● C208M1807030	215,40
230	70	30	8	● C208M2307030	275,40
Spec.					C207M99

### NOTE

● Quantità minima d'ordine: 2 pezzi.  
Order quantity: 2 pieces.

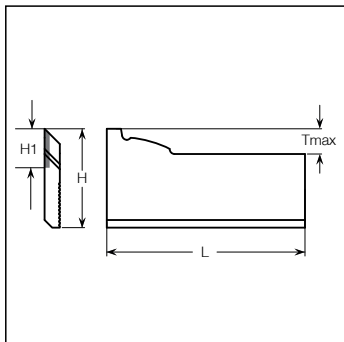

### NOT PROFILED KNIVES

L	H	H1	S	Code	€
60	60	30	8	■ C208M0606030	72,60
80	60	30	8	■ C208M0806030	9,40
100	60	30	8	■ C208M1006030	120,20
130	60	30	8	■ C208M1306030	154,40
150	60	30	8	■ C208M1506030	180,20
180	60	30	8	■ C208M1806030	215,40
230	60	30	8	■ C208M2306030	275,40
60	70	35	8	■ C208M0607035	80,80
80	70	35	8	■ C208M0807035	105,60
100	70	35	8	■ C208M1007035	132,60
130	70	35	8	■ C208M1307035	172,00
150	70	35	8	■ C208M1507035	198,80
180	70	35	8	■ C208M1807035	238,20
230	70	35	8	■ C208M2307035	302,40
Spec.					C208M99

H	H1	Tmax
60	30	22
70	30	22
70	35	27

### NOTE

■ Utensili non a magazzino, quantità minima d'ordine: 2 pezzi.  
Tools not ready in stock minimum order quantity: 2 pieces.

TAGLIO / SEZIONATURA  
SAWING

DIAMANTE  
DIAMOND

FRESATURA  
CUTTING

PANTOGRAFATURA  
ROUTING

FORATURA  
BORING

MANDRINI / ATTACCHI  
CHUCKS & CLAMPING SYSTEM

RICAMBI E LAVORAZIONI SUPP.  
SPARE PARTS & ADD. WORKING

Coltelli HS profilabili  
per teste  
T206-T206H-T206W

HS Blanketts  
Rückenverzahnt  
für T206-T206H-T206W

Plaquettes HS de rechange  
por porte-outils  
T206-T206H-T206W

Ножи HS под  
профилирования для головок  
T206-T206H-T206W

## C206

## HS Profilable knives for T206-T206H-T206W cutterheads



Coltelli in HS zigrinati (spessore mm 8) • Disponibili in diverse misure • Fornibili grezzi o profilati • Indicati per la lavorazione di legni massicci • Da montare su teste portacoltelli T206-T206H-T206W

HS knurled knives (thickness 8 mm) • Available in different sizes • Supplied profiled or not profiled • Suitable for working solid wood • To mount on cutterheads T206-T206H-T206W

TAGLIO / SEZIONATURA  
SAWING

DIAMANTE  
DIAMOND

FRESATURA  
CUTTING

PANTOGRAFATURA  
ROUTING

FORATURA  
BORING

MANDRINI / ATTACCHI  
CHUCKS & CLAMPING SYSTEM

RICAMBI E LAVORAZIONI SUPP.  
SPARE PARTS & ADD. WORKING

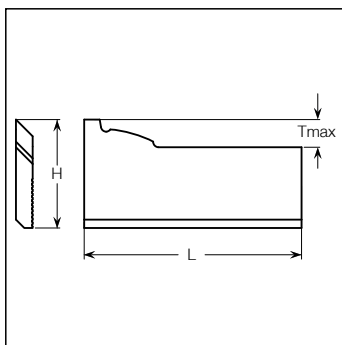
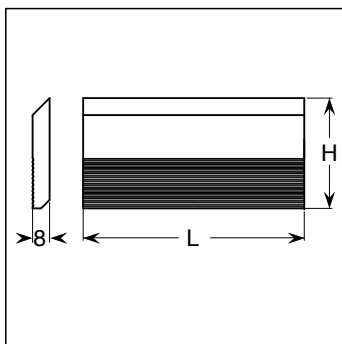

H	Tmax
50	12
60	20
70	30

### NOT PROFILED KNIVES

● = Ready in stock ■ = Delivery time 20 working days △ = On request

L	H	S	Code	€
60	50	8	● C206S06050AA	20,80
80	50	8	● C206S08050AA	27,80
100	50	8	● C206S10050AA	34,60
130	50	8	● C206S13050AA	43,80
150	50	8	● C206S15050AA	52,00
180	50	8	● C206S18050AA	60,00
230	50	8	● C206S23050AA	76,20
650	50	8	● C206S65050AA	202,80
60	60	8	● C206S06060AA	22,40
80	60	8	● C206S08060AA	29,80
100	60	8	● C206S10060AA	37,40
130	60	8	● C206S13060AA	48,40
150	60	8	● C206S15060AA	56,00
180	60	8	● C206S18060AA	67,20
230	60	8	● C206S23060AA	80,80
650	60	8	● C206S65060AA	219,00
Spec.			C205S99	

### PROFILED KNIVES

L	H	S	Code	€
60	70	8	■ C206S06070AA	30,00
80	70	8	■ C206S08070AA	37,00
100	70	8	■ C206S10070AA	43,80
130	70	8	■ C206S13070AA	53,00
150	70	8	■ C206S15070AA	60,00
180	70	8	■ C206S18070AA	69,20
230	70	8	■ C206S23070AA	85,40
650	70	8	■ C206S65070AA	235,20
Spec.			C206S99	

### NOTE

■ Utensili non a magazzino, quantità minima d'ordine: **2 pezzi**.  
Tools not ready in stock minimum order quantity: **2 pieces**.



**AADO****Spacing collars**

Ottenuti da acciaio di ottima qualità • Disponibili in diverse misure • Superfici di appoggio totalmente rettificata • Da inserire nei gruppi frese e utensili vari

Obtained from steel with a high quality • Available in different sizes • Surfaces completely ground • To use with cutter sets and other tools

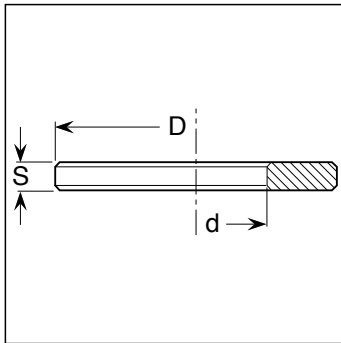

● = Ready in stock ■ = Delivery time 20 working days △ = On request

d	S	D	Code	€	d	S	D	Code	€
12	0,1	24	● AAD012024001	2,00	35	7	55	● AAD035055070	12,80
12	0,2	24	● AAD012024002	2,00	35	8	55	● AAD035055080	13,40
12	0,5	24	● AAD012024005	2,00	35	9	55	● AAD035055090	13,60
12	1	24	● AAD012024010	2,00	35	10	55	● AAD035055100	13,80
16	0,1	30	● AAD016030001	2,80	35	12	55	● AAD035055120	14,60
16	0,2	30	● AAD016030002	2,80	35	15	55	● AAD035055150	15,20
16	0,5	30	● AAD016030005	2,80	35	20	55	● AAD035055200	17,40
16	1	30	● AAD016030010	2,80	40	0,1	60	● AAD040060001	3,60
20	0,1	35	● AAD020035001	3,80	40	0,2	60	● AAD040060002	3,40
20	0,2	35	● AAD020035002	3,60	40	0,5	60	● AAD040060005	3,20
20	0,5	35	● AAD020035005	3,40	40	1	60	● AAD040060010	3,80
20	1	35	● AAD020035010	4,40	40	2	60	● AAD040060020	13,20
25	0,1	40	● AAD025040001	3,80	40	3	60	● AAD040060030	12,60
25	0,2	40	● AAD025040002	3,60	40	4	60	● AAD040060040	13,00
25	0,5	40	● AAD025040005	3,60	40	5	60	● AAD040060050	12,60
25	1	40	● AAD025040010	4,60	40	6	60	● AAD040060060	13,60
30	0,1	50	● AAD030050001	4,00	40	7	60	● AAD040060070	13,80
30	0,2	50	● AAD030050002	3,60	40	8	60	● AAD040060080	14,20
30	0,5	50	● AAD030050005	3,00	40	9	60	● AAD040060090	14,60
30	1	50	● AAD030050010	7,40	40	10	60	● AAD040060100	15,40
30	2	50	● AAD030050020	7,00	40	12	60	● AAD040060120	16,20
30	3	50	● AAD030050030	10,40	40	15	60	● AAD040060150	17,40
30	4	50	● AAD030050040	11,20	40	20	60	● AAD040060200	18,80
30	5	50	● AAD030050050	11,60	50	0,1	70	● AAD050070001	3,80
30	6	50	● AAD030050060	11,80	50	0,2	70	● AAD050070002	3,80
30	7	50	● AAD030050070	12,00	50	0,5	70	● AAD050070005	3,80
30	8	50	● AAD030050080	12,60	50	1	70	● AAD050070010	4,80
30	9	50	● AAD030050090	12,60	50	2	70	● AAD050070020	12,20
30	10	50	● AAD030050100	13,00	50	3	70	● AAD050070030	14,40
30	12	50	● AAD030050120	13,40	50	4	70	● AAD050070040	15,00
30	15	50	● AAD030050150	14,00	50	5	70	● AAD050070050	15,40
30	20	50	● AAD030050200	15,20	50	6	70	● AAD050070060	15,80
35	0,1	55	● AAD035055001	3,60	50	7	70	● AAD050070070	16,20
35	0,2	55	● AAD035055002	3,40	50	8	70	● AAD050070080	16,60
35	0,5	55	● AAD035055005	3,20	50	9	70	● AAD050070090	17,00
35	1	55	● AAD035055010	4,40	50	10	70	● AAD050070100	17,80
35	2	55	● AAD035055020	7,00	50	12	70	● AAD050070120	18,80
35	3	55	● AAD035055030	9,60	50	15	70	● AAD050070150	20,40
35	4	55	● AAD035055040	12,00	50	20	70	● AAD050070200	22,80
35	5	55	● AAD035055050	12,20					
35	6	55	● AAD035055060	12,60					
					Spec.			AAD99	

**NOTE**

■ Quantità minima d'ordine: **20 pezzi (assortiti)**.  
Minimum order quantity: **20 pieces (mixed)**.

Chiavi

Hakenschlüssel

Clés

Ключи

## ACH

## Wrenches

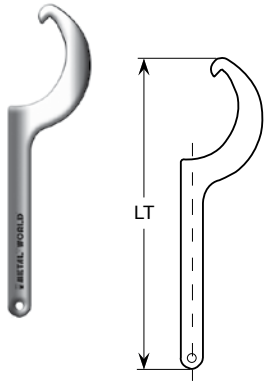

● = Ready in stock ■ = Delivery time 20 working days △ = On request

ø	LT	Code	€
52-55	205	● ACH052AAAAAA	34,00
58-62	240	● ACH058AAAAAA	34,00
80	280	● ACH080AAAAAA	36,00
100	280	● ACH095AAAAAA	40,00
Spec.		ACH0099	

Chiavi esagonali  
con impugnatura a "T"

Sechskantschlüssel

Clés exagonales

Т-образные ключи

## ACHET

## "T" allen key

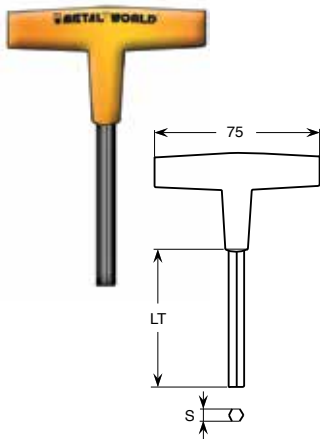

● = Ready in stock ■ = Delivery time 20 working days △ = On request

S	LT	Code	€
2,5	90	● ACHET25AAAAA	7,20
3	90	● ACHET03AAAAA	7,40
4	100	● ACHET04AAAAA	8,20
5	110	● ACHET05AAAAA	9,20
6	110	● ACHET06AAAAA	10,20
6	200	● ACHET06HAAAA	38,80
8	200	● ACHET08HAAAA	48,60
10	200	● ACHET10HAAAA	64,80
Spec.		ACHET99	

Chiavi Torx  
con impugnatura  
a cacciavite

Torxschlüssel

Clés Torx

Ключи Торх

## ACHTC

## Torx key

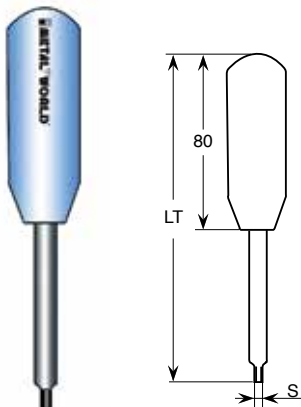

● = Ready in stock ■ = Delivery time 20 working days △ = On request

S	LT	Code	€
T5	130	● ACHTC05AAAAA	16,00
T8	130	● ACHTC08AAAAA	16,00
T9	130	● ACHTC09AAAAA	9,40
T10	150	● ACHTC10AAAAA	9,60
T15	160	● ACHTC15AAAAA	11,80
T20	180	● ACHTC20AAAAA	12,60
Spec.		ACHTC99	

TAGLIO / SEZIONATURA  
SAWINGDIAMANTE  
DIAMONDFRESATURA  
CUTTINGPANTOGRAFATURA  
ROUTINGFORATURA  
BORINGMANDRINI / ATTACCHI  
CHUCKS & CLAMPING SYSTEMRICAMBI E LAVORAZIONI SUPP.  
SPARE PARTS & ADD. WORKING

Chiavi Torx con impugnatura a "T"

Torxschlüssel

Clés Torx

T-образные ключи Torx



**ACHTT** "T" Torx key

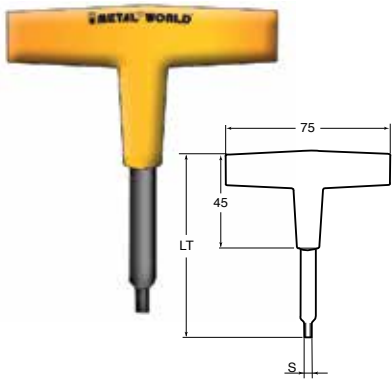

● = Ready in stock ■ = Delivery time 20 working days △ = On request

S	LT	Code	€
T9	90	● ACHTT09AAAAA	12,20
T10	95	● ACHTT10AAAAA	13,40
T15	95	● ACHTT15AAAAA	14,00
T20	150	● ACHTT20AAAAA	14,60
T25	150	● ACHTT25AAAAA	12,60
Spec.		ACHTT99	

TAGLIO / SEZIONATURA  
SAWING

DIAMANTE  
DIAMOND

Supporti regolabili per smussatori e raggianti

Fräseinsätze für Fase-Abrundmesser

Support réglables pour couteaux à chanfreiner et arrondir

Подкладки для сменных резцов

**SUPP** Adjustable supports for bevel/radius inserts

Ottenuti da acciaio bonificato • Indicati per il montaggio di inserti su teste portacoltelli di ogni genere • Il supporto viene fornito privo di coltelli

Obtained from hardened and tempered steel • Suitable for mounting inserts on any type of cutterheads • The support is supplied without knives

FRESATURA  
CUTTING

PANTOGRAFATURA  
ROUTING

FORATURA  
BORING

MANDRINI / ATTACCHI  
CHUCKS & CLAMPING SYSTEM

RICAMBI E LAVORAZIONI SUPP.  
SPARE PARTS & ADD. WORKING

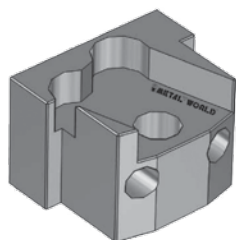

● = Ready in stock ■ = Delivery time 20 working days △ = On request

Left Code	Right Code	€
● SUPP0AAAAA1L	● SUPP0AAAAA1R	43,00

Per montare coltelli C044M220R15A, C044M220R20A, C044M220R30A, C044M220AASA  
To mount C044M220R15A, C044M220R20A, C044M220R30A, C044M220AASA knives

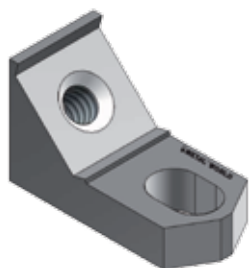

Code	€
● SUPP0AAAAA2	32,00

Per montare coltelli C040M14020AA  
To mount C040M14020AA knives



Code	€
● SUPP0AAAAA3	32,00

Per montare coltelli C040M14020AA  
To mount C040M14020AA knives

**LAV**

**Additional working**

TAGLIO / SEZIONATURA  
SAWING

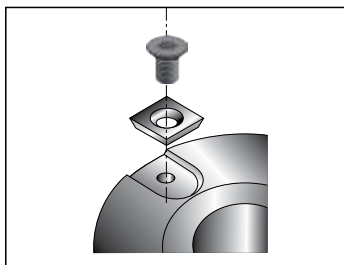

ESECUZIONE SEDE CON RASANTE C040  
EXECUTION OF SPUR SEATS C040

Nr. of seats	€
2	45,00
3	67,00
4	87,00
6	125,00
8	160,00

DIAMANTE  
DIAMOND

FRESATURA  
CUTTING

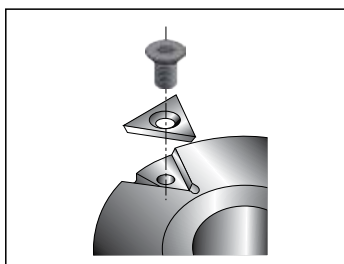

ESECUZIONE SEDE CON RASANTE TRIANGOLARE C042  
EXECUTION OF SEATS FOR TRIANGULAR SPURS C042

Nr. of seats	€
2	54,00
3	80,00
4	103,00
6	150,00
8	190,00

PANTOGRAFATURA  
ROUTING

FORATURA  
BORING

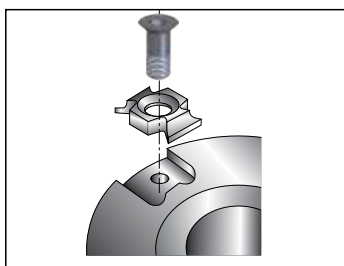

ESECUZIONE SEDE CON INSERTO SMUSSATORI RAGGIATORI C044  
EXECUTION OF SEATS FOR BEVEL/RADIUS INSERTS

Nr. of seats	€
2	83,00
3	120,00
4	156,00
6	228,00
8	295,00

MANDRINI / ATTACCHI  
CHUCKS & CLAMPING SYSTEM

RICAMBI E LAVORAZIONI SUPP.  
SPARE PARTS & ADD. WORKING



**LAV** Additional working

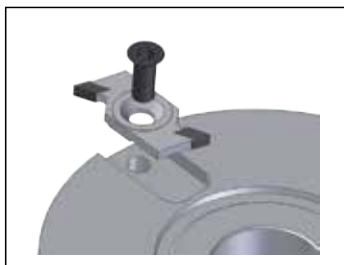

ESECUZIONE SEDE CON INSERTO PER INCASTRI C046 – C047 – C048  
EXECUTION OF GROOVING INSERT SEATS C046 - C047 - C048

Nr. of seats	€
2	97,00
3	140,00
4	180,00
6	266,00

TAGLIO / SEZIONATURA  
SAWING

DIAMANTE  
DIAMOND

FRESATURA  
CUTTING



ESECUZIONE SEDE CON SUPPORTO REGOLABILE ED INSERTO SMUSSATORE-RAGGIATORE C044  
EXECUTION OF SEATS FOR ADJUSTABLE SUPPORTS FOR BEVEL/RADIUS INSERTS C044

Nr. of seats	H max	€
2	50	200,00
3	50	290,00
4	50	380,00
2	100	260,00
3	100	380,00
4	100	496,00
2	150	318,60
3	150	364,00
4	150	610,00

PANTOGRAFATURA  
ROUTING

FORATURA  
BORING

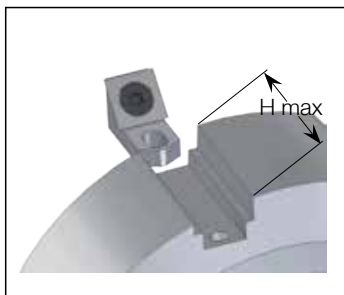

ESECUZIONE SEDE CON SUPPORTO REGOLABILE E RASANTE C040  
EXECUTION OF SEATS FOR ADJUSTABLE SUPPORTS AND SPURS C040

Nr. of seats	H max	€
2	50	126,00
3	50	178,00
4	50	234,00
6	50	340,00
2	100	164,00
3	100	234,00
4	100	304,00
6	100	448,00

MANDRINI / ATTACCHI  
CHUCKS & CLAMPING SYSTEM

RICAMBI E LAVORAZIONI SUPP.  
SPARE PARTS & ADD. WORKING

